

# ANNUAL REPORTS

FOR THE TOWN OF

# PELHAM



For the Fiscal Year Ending December 31,

# 1967





# ANNUAL REPORTS

*of the*

SELECTMEN, TREASURER, TOWN CLERK, TAX COLLECTOR,  
LIBRARY TRUSTEES, CEMETERY TRUSTEES, TRUSTEES OF  
TRUST FUNDS, HEALTH OFFICER, FIRE & POLICE  
DEPTS., SCHOOL DIST. & STATE AUDITORS.

*of the*

TOWN OF  
**PELHAM**  
NEW HAMPSHIRE



NH  
352.07  
P38  
1967

INDEX

	Page
Appropriations	12
Board of Adjustment	46
Building Inspector's Report	45
Civil Defense Report	60
Detailed Statement of Payments	34
Fire Department	48
Health Department Report	59
Highway Department Report	42
Industrial Commission Report	63
Inventory of Town Property	10
Library Report	61
Minutes of Town Meeting, 1967	7
Municipal Accounting Report	14
Municipal Court	58
Police Department	50
Recreation Committee Report	63
Schedule of Town Property	11
School Report	77
Town Officers	3
Treasurer's Report	32
Trust Funds	64
Vital Statistics	70
Warrant and Budget	Colored Pages

# TOWN OFFICERS

For the Year 1967

## REPRESENTATIVES TO THE GENERAL COURT

Miles J. Cares

Arthur H. Peabody

## MODERATOR

Frederick A. Houle

## TOWN CLERK

Faye B. Emerson

## TOWN TREASURER

Albert R. Harris

## TAX COLLECTOR

Ivy N. Chadwick

## SELECTMEN

James P. Emerson, 1968

Peter E. Morin, 1969

Albert D. Nolin, Chairman, 1970

## SUPERVISORS OF CHECK LIST

Austin Burns, 2 years

Richard C. Mansfield, 6 years

Randall H. Richardson, 4 years

Dorothy Hardy, replacing Mr. Richardson

## AUDITORS

The Division of Municipal Accounting, State Tax Commission

## LIBRARY TRUSTEES

Helena H. Zolkos, 1968

Dorothy Hardy, 1969, Clerk

Peter Black, 1970, Chairman

## CEMETERIES TRUSTEES

Austin Burns, 1968

John Nariniak, 1968

Frank O. Carleton, 1969

Eben M. Tallant, 1969

Charles W. Herbert, 1970

Chester Walter Spaulding, 1970

## TRUSTEES OF TRUST FUNDS

Randall H. Richardson, 1968

James P. Emerson, 1970

Miles J. Cares, 1969

Herbert S. Currier, replacing Mr. Richardson



FENCE VIEWERS

Board of Selectmen

HIGHWAY AGENT

Robert B. Fletcher

HEALTH OFFICER

Alton M. Hodgman

DOG OFFICER

Frank C. Foisie

MEAT INSPECTOR

Philippe L. Blanchette

MILK INSPECTOR

Board of Selectmen

BUILDING INSPECTOR

Albert E. Hirsch

TOWN COUNSEL

Hamblett, Kerrigan & Hamblett

CIVIL DEFENSE DIRECTOR

Alton M. Hodgman

Miles J. Cares, replacing Mr. Hodgman

OVERSEER OF PUBLIC WELFARE

Albert D. Nolin

BALLOT CLERKS

Ann Carner  
J. Edward Mellen

Theodora Constantin  
Jeannette Surprenant

SURVEYORS OF WOOD AND LUMBER

Charles W. Hobbs, Jr.  
Donald H. Landry

Ellsworth J. Smith  
Charles Steck

John Steck

## BUDGET COMMITTEE

Frederick W. Garland, 1968	James Greenwood, 1968
James Powers, 1968	Miles J. Cares, 1969, Vice Chairman
Randall H. Richardson, 1969	Bernard T. Rock, 1969, Clerk
Daniel S. Atwood, Jr., 1970	Donald Burton, 1970, Chairman
Richard C. Mansfield, 1970	Peter E. Morin, Selectman
Donald Brock, School Board	Arthur E. Egerton, replacing Mr. Richardson

## POLICE DEPARTMENT

Ralph S. Boutwell, Chief	
Frank C. Foisie, Captain	
Alton M. Hodgman, Lieutenant	
Roland L. Boucher, Sergeant	
Russell Corbin, Regular Officer	Willis H. Atwood, Officer
Wayne Bariteau, Officer	Thomas Boland, Officer
Frank O. Carleton, Officer	Arthur Greenwood, Jr., Officer
Arthur Hanlon, Officer	Albert R. Harris, Officer
C. Warren Herbert, Officer	Gottfried Herkomer, Officer
Mitchell Kopacz, Officer	Frederick Manty, Officer
John Newcomb, Officer	Arthur H. Peabody, Officer
Herbert Richardson, Officer	Roy S. Silloway, Officer

## FIRE DEPARTMENT

Richard C. Mansfield, Chief, Fire Ward  
Arnold V. Balcom, Assistant Chief, Fire Ward  
Willis H. Atwood, Assistant Chief  
Richard S. Melanson, Fire Ward  
Lorin M. Raymond, Jr., Fire Ward  
Stephen V. Straughan, Fire Ward

### Firemen:

Daniel S. Atwood, Jr.	Frank W. Atwood
Herbert H. Atwood	Willis H. Atwood
Nathan Boutwell	Miles J. Cares
Frank O. Carleton	Russell L. Corbin
Roy M. Cowdry	Herbert S. Currier
Richard Derby	Robert M. Edwards
Robert B. Fletcher	Frank M. Forrest
James D. Greenwood	Robert M. Hirsch
Charles W. Hobbs	Alton M. Hodgman
Sanford A. Horskin	Edmund L. Lapoint
Russell Leonard	Frederick Mansfield
Frank P. Melanson	William A. Melanson
Hugh L. Porter	Lorin M. Raymond, Sr.
Robert C. Robb	Roger Robinson, Jr.
Roy S. Silloway	David Slater

Charles W. Therriault



## PLANNING BOARD

Leo Sevigny, 1968, Clerk  
J. Edmund Landry, 1970, Chairman  
Paul Stevens, Jr., 1971  
Mitchell Kopacz, 1969  
Paul Fisher, Jr., 1970  
John E. Regan, 1972  
Peter E. Morin, Selectman

## BOARD OF ADJUSTMENT

Fabian Chiasson, 1968, Clerk  
Haven Strout, 1970, Chairman  
Willis H. Atwood, 1972, Vice Chairman  
Delmar Parent, 1969  
James Gannon, 1971  
James P. Emerson, Selectman  
Alternates:  
R. Irving Buck  
Harold Pitts  
Robert Dickie

## INDUSTRIAL COMMISSION

Melvin Strawbridge, Chairman  
James Holt  
James J. White  
Albert D. Nolin, Selectman  
Russell Leonard  
Harvey Perreault, Sr.  
Leonard Philbrick, replacing Mr. Perreault

## CONSERVATION COMMISSION

J. Alfred Ducharme, 1968  
Earl K. Fox, Jr., 1969  
Paul Fisher, Jr., 1970  
William Lappen, 1968  
George Tuttle, 1969  
William Martowski, replacing Mr. Tuttle

## RECREATION COMMISSION

James Fenton, 1968, Chairman  
Richard Derby, 1969  
Thelma Boutwell, 1970, Recording Sec.  
Margery Nickerson, 1969, Corresponding Sec.  
Anthony Oliver, 1970



## MINUTES OF TOWN MEETING - MARCH 14, 1967

### EXCEPTING SECTIONS APPEARING ELSEWHERE IN THIS TOWN REPORT

Moderator, Frederick Houle, opened meeting at 7:30 P. M.

Article 2. The Budget was taken up item by item, at the end of which it was voted that the sum of \$173,463.67 be raised and appropriated as the total Town Budget figure.

Article 10 appropriating \$180 as the Town's share of the Fire Chief's Retirement passed in the affirmative.

Article 14 authorizing the purchase of a piece of land on Marsh Road for the use of the Cemetery passed in the affirmative.

Article 11 passed in the affirmative, thus establishing a Recreation Commission.

Article 13 also passed in the affirmative, appropriating a sum of \$2,500.00 to be used by the above Commission for Parks and Playgrounds, etc.

Article 16, passing in the affirmative, allowed the continuance of the program started last year, of putting up uniform metal street signs all over town.

Article 17, appropriating \$1,500 to be used by the Planning Board for the purpose of taking land options on desirable locations, passed.

Article 7, raising one-half of the amount necessary to have the State reappraise the Town next year, passed in the affirmative.

Article 5 passed, appropriating \$2,000 to add to the Capital Reserve Fund for purchase of a fire truck.

Article 8, pertaining to the construction of a combination police and fire station building on land owned by the Town brought much controversy. The recommendations and plans of the Committee were thoroughly explained by Mr. Powers. Mr. Rock offered information of a similar building in the town of Stowe, Mass. for a cost of \$45,000, built on town owned land. A motion was made to "postpone any further action on Article 8 and when we adjourn this evening, we adjourn to meet on April 13th at 8 P. M. at the Sherburne School to give further consideration to this article and to any other articles that may legally come before this meeting." This passed in the affirmative.

The meeting was adjourned at 11:45 P. M.

The meeting was called to order on April 13, 1967 at 8 P. M. and Article 8 was resumed. Mr. Powers made a motion which asked to appropriate the sum of \$89,960. for the construction of the police and fire station, rather than the sum in the original Article 8 of \$110,000. He explained that the committee was still in favor of their original plan for the building but that they felt they could trim some corners and arrive at the new figure.

Mr. Hodgman, as Civil Defense Director, moved to amend the motion to read \$99,960 to provide for the building of an emergency operating center to be constructed under ground under the proposed building. This passed and the main motion was thus amended.

When the standing vote was taken, 117 were for and 102 against the motion. Since a 2/3 vote was needed, it was lost.

It was then moved that the original motion be voted on, substituting the figure of \$89,960 for \$110,000. It was moved from the floor that the motion be amended to read \$70,000, but this amendment was de-

feated. The motion before the house was voted with those in favor being 118, and those opposed 92. Of the 210 voting it was necessary to have a 2/3 vote, so the motion was lost.

Articles 3 and 4 were passed in the affirmative.

Article 12 was voted to be passed over.

Articles 18, 19, 20 were passed in the affirmative.

Article 21 was voted to pass over.

Articles 22, 23, 24 could not be acted upon since they were not recommended by the Budget Committee.

Under Article 25 Mrs. Mansfield reported that the Committee that had been formed to see about having a Doctor come into Town was still active.

Mr. Currier moved that the Moderator appoint a committee of five to study the possibility of establishing a Highway Dept., and this passed in the affirmative.

Mr. Parent moved that Article 2 of the Town Warrant contain only the necessary salaries and expenditures and any increase from these amounts should come before the Town Meeting in the form of a separate article. The resolution was put to a vote and lost.

The Town Meeting was adjourned at 11:15 P. M.



## NOTICE

On Town Meeting Day, March 12, 1968 the polls will be open for voting from ten o'clock in the morning, until eight o'clock in the evening. Articles of the Warrant will be taken up on March 14, 1968 at 7:30 in the evening. Both meetings will be held in the E. G. Sherburne Auditorium.

### TOWN OFFICIALS' BUSINESS HOURS - TOWN HALL

Telephone 635-7811

Selectmen meet every second and fourth Tuesday, 8-9 P. M.

Selectmen's Office is open Monday through Friday from  
9-12 Noon and 1-3 P. M.

Town Clerk's Office is open Monday, Wednesday and Friday  
from 10-12 Noon, and 1-3 P. M.; Saturdays, 10-12  
Noon, Tuesday evenings 7-9 P. M.

Tax Collector's Office is open Monday through Thursday  
9-12 Noon and 1-3 P. M.; Tuesday evenings 7-9  
P. M.; and Saturday mornings 9-12 Noon.

## SCHEDULE OF TOWN PROPERTY

Town Hall, lands and buildings	\$ 47,000.00
Furniture and equipment	3,000.00
Libraries, lands and buildings	52,000.00
Furniture and equipment	10,000.00
Police Department equipment	4,600.00
Fire Department, lands and buildings	27,000.00
Equipment	37,950.00
Highway Department, equipment	5,000.00
Materials and supplies	500.00
Parks and playgrounds and commons	1,200.00
Schools, lands and buildings	745,000.00
Equipment	25,000.00
All lands and buildings acquired through	
Tax Collector's Deeds	5,250.00
Various small lots and Gage Land	
lots #1 through #35	<u>500.00</u>
	\$964,000.00
Lots #1 through #14 Gage Lots identified	304.5 acres
Lot #15 Currier Meadow	10.5 acres
Lots #16 through #35 land acquired by	
Tax Collector's Deeds	277.0 acres
Lot #50 Residue of Little Island Park	18.0 acres
	610.0 acres
Lots #36 through #45 Tax lots with no	
record of title	78.0 acres
Lots #46 through #49 Tax lots with unrecorded	
deeds	31.0 acres
Gage Lots unidentified	101.0 acres
	210.0 acres



## INVENTORY OF VALUATION

Land and buildings	\$8,841,610.00	
Factory buildings and land	48,150.00	
Factory machinery	38,490.00	
Electric plants	501,170.00	
Gas Transmission lines	59,000.00	
Stock in trade of merchants	86,430.00	
Stock in trade of manufactures	27,830.00	
Boats (24)	2,980.00	
Dairy Cows (315)	19,840.00	
Poultry (1,260)	390.00	
Gasoline pumps and tanks	3,450.00	
Road building and construction machinery, including well-drilling	68,620.00	
Snow vehicles (4)	<u>1,000.00</u>	
Total valuation before exemptions		\$9,698,960.00
Less: War Service exemptions	\$ 332,000.00	
Neat stock exemptions	6,500.00	
Poultry exemptions	<u>390.00</u>	
Total exemptions allowed		<u>338,890.00</u>
Net value on which tax rate is computed		\$9,360,070.00
Electric and Gas Utility Companies:		
Granite State Electric Co.	\$ 250,070.00	
New England Power Co.	250,000.00	
Public Service Co. of N. H.	<u>1,100.00</u>	
Total Electric Plants		\$ 501,170.00
Tennessee Gas Transmission Co.		59,000.00
Number of inventories distributed in 1967	1,635	
Number of inventories returned in 1967	1,028	
Number of veterans who received property exemptions	323	
Number of veterans exempt from poll tax	429	

# STATEMENT OF APPROPRIATIONS

ASSESSED FOR THE YEAR 1967

Town Officers' Salaries	\$ 3,100.00	
Town Office Administrative Expenses	9,777.00	
Election and Registration Expenses	594.94	
Municipal Court Expenses	610.00	
Town Hall and Buildings Maintenance	2,515.00	
Social Security and Retirement	2,442.00	
Police Department	31,170.00	
Dog Officer	400.00	
Fire Department	11,207.00	
Care of Trees	200.00	
Insurance	2,774.95	
Planning and Zoning	375.00	
Dog Damage	50.00	
Legal Expenses	1,500.00	
Civilian Defense	500.00	
Health Department	75.00	
Vital Statistics	125.00	
Dump	2,000.00	
Town Maintenance		
Summer	15,000.00	
Winter	22,000.00	
Resealing	10,000.00	
Street Lighting & Blinkers	2,350.00	
General Expenses of Highway Department	1,500.00	
Town Road Aid	957.78	
Libraries	6,440.00	
Old Age Assistance	2,500.00	
Town Poor	4,500.00	
Veteran's Aid	50.00	
Memorial Day	300.00	
Parks and Playgrounds	150.00	
Town Hall Special	2,500.00	
Cemeteries	1,500.00	
Appraisal Assistance	800.00	
State Audit	500.00	
New Construction, Roads	15,000.00	
Road Sign Special	500.00	
Parks & Playgrounds Special	2,500.00	
Cemetery Special	2,500.00	
Planning & Zoning Special	1,500.00	
Interest	1,000.00	
Capital Reserve Fund	2,000.00	
Reappraisal Special	<u>8,000.00</u>	
Total Town Appropriation		\$173,463.67
County Tax		34,086.09
School Tax		<u>599,764.67</u>

Total of Town, County and School Taxes

\$807,314.43



**Less: Estimated Revenues and Credits:**

Interest and Dividends Tax	\$ 2,283.85
Savings Bank Tax	374.47
Reimbursement a/c State Lands	13.10
Interest Received on Taxes and Deposits	2,300.00
Business Licenses, Permits and Filing Fees	500.00
Dog Licenses	800.00
Motor Vehicle Permit Fees	40,000.00
Rent of Town Property and Equipment	100.00
Income from Head Tax	1,100.00
Fines, Municipal Court	1,000.00
Poll Taxes @ \$2.00	<u>3,808.00</u>

Total Revenues and Credits	\$ 52,279.42
Net Town, County and School Appropriations	755,035.01
Plus Overleay	<u>3,130.66</u>

Amount to be Raised by Property Taxes \$758,165.67

**Taxes Committed to the Tax Collector:**

Property Taxes	\$758,165.67
Poll Taxes	<u>3,808.00</u>

Total Taxes Committed \$761,973.67

Tax Rate Approved by Tax Commission \$8.10

# DIVISION OF MUNICIPAL ACCOUNTING

STATE TAX COMMISSION

Concord, New Hampshire

## SUMMARY OF FINDINGS AND RECOMMENDATIONS

February 13, 1968

Board of Selectmen  
Pelham, New Hampshire

Gentlemen:

Submitted herewith is the report of the annual examination and audit of the accounts of the Town of Pelham for the fiscal year ended December 31, 1967, which was made by this Division in accordance with the vote of the Town. Exhibits as hereafter listed are included as part of the report.

### SCOPE OF AUDIT

Included in the examination and audit were the accounts and records of the Board of Selectmen, Treasurer, Tax Collector, Town Clerk, Cemetery Trustees, Library and Municipal Court.

### FINANCIAL STATEMENTS

Comparative Balance Sheets: December 31, 1966 - December 31, 1967: (Exhibit A-1)

Comparative Balance Sheets as of December 31, 1966 and December 31, 1967, are presented in Exhibit A-1. As indicated therein, the Surplus increased by \$5,872.40, from \$27,727.09 to \$33,599.49 in 1967. Inasmuch as there were no outstanding bonds or long term notes, the Balance Sheet Surplus of \$33,599.49 represented the Current Surplus (excess of total assets over current liabilities) as of December 31, 1967.

Analysis of Change in Financial Condition: (Exhibit A-2)

An analysis of change in financial condition of the Town during the year is made in Exhibit A-2, with the factors which caused the change indicated therein.

Comparative Statements of Appropriations and Expenditures - Estimated and Actual Revenues: (Exhibits A-3 and A-4)

Comparative Statements of appropriations and expenditures, estimated and actual revenues for the fiscal year ended December 31, 1967, are presented in Exhibits A-3 and A-4. As indicated by the budget summary (Exhibit A-4), a revenue surplus of \$5,029.06, plus a net unexpended balance of appropriations of \$887.93, resulted in a net budget surplus of \$5,916.99.

Summary Statement of Receipts and Expenditures: (Exhibit B-1)

A summary statement of receipts and expenditures for the fiscal year ended December 31, 1967, made up in accordance with the uniform classification of accounts, is included in Exhibit B-1. Proof of the Treasurer's balance as of December 31, 1967, is indicated in Exhibit B-2.

Cemetery Trustees' Accounts: (Exhibit F-1)

A statement of the activity in the Cemetery Trustees' Accounts for the fiscal year is presented in Exhibit F-1.

Municipal Court: (Exhibit H)

A statement of the accounts of the Municipal Court is contained in Exhibit H.

### AUDIT PROCEDURE

The accounts and records of all town officials charged with the custody, receipt and disbursement of public funds were examined and audited. Vouchers and cancelled checks were compared with supporting invoices and payrolls as well as entries in the books of record. Receipts were checked by source insofar as possible.



and totals of receipts and expenditures verified. Book balances were verified by comparison with reconciled bank balances made from statements submitted by depository banks. Verification of uncollected taxes was made by mailing notices to delinquent taxpayers as indicated by the Collector's records. The amounts of uncollected and unredeemed taxes as indicated in this report are therefore subject to any changes which may be necessitated by the return of verification notices.

#### GENERAL COMMENTS

Trust Funds:

The records of the Trust Funds were incomplete therefore, no audit could be made.

Town Clerk:

Town Clerk,

It is recommended that a fifty dollar (\$50.00) change fund be established for the use of the

Clerk of Municipal Court:

It is suggested all miscellaneous receipts of the court be recorded in the same book of record as the small claims are entered.

Tax Collector:

It is recommended that a one hundred dollar (\$100.00) change fund be established for the use of the tax collector.

There were, as of December 31, 1967, unredeemed taxes from the Tax Sales of the Levies of 1964 and prior years as follows:

Levy of 1964	\$ 755.79
Levy of 1963	500.76
Levy of 1962	68.02
Levy of 1961	56.32
Levy of 1960	404.15
	<u>\$1,785.04</u>

Inasmuch as the two year period provided by Law in which redemptions from tax sales may be made has expired on these unredeemed taxes, a Tax Collector's deed should be given to the Town for all the properties involved.

Conclusion:

The provisions of Chapter 184 of the Laws of 1955, require that this report or the summary of findings and recommendations (letter of transmittal) shall be published in the next annual report of the Town.

We extend our thanks to the officials of the Town of Pelham for their assistance during the course of the audit.

Yours very truly,

O. Maurice Oleson

Director

DIVISION OF MUNICIPAL ACCOUNTING

STATE TAX COMMISSION

O. Maurice Oleson, Auditor

Stephen Plodzick, Auditor

Charles Carroll, Accountant

DIVISION OF MUNICIPAL ACCOUNTING

STATE TAX COMMISSION

Concord, New Hampshire

February 13, 1968

CERTIFICATE OF AUDIT

This is to certify that we have examined and audited the accounts and records of the Town of Pelham for the fiscal year ended December 31, 1967. In our opinion, the Exhibits included herewith present fairly the financial condition of the Town as of December 31, 1967, together with the results of operations for the fiscal year ended on that date.

Respectfully submitted,

O. Maurice Oleson

Director

DIVISION OF MUNICIPAL ACCOUNTING  
STATE TAX COMMISSION

O. Maurice Oleson, Auditor

Stephen Plodzik, Auditor

Charles Carroll, Accountant

EXHIBIT A-1  
Comparative Balance Sheets  
As of December 31, 1966 and December 31, 1967

<u>Assets</u>	<u>December 31, 1966</u>	<u>December 31, 1967</u>
Cash:		
In Hands of Treasurer	\$ 271,403.87	\$ 216,127.00
Capital Reserve Fund (Contra)	4,179.96	(*) 6,179.96
Special Fund Road Building (Contra)	1,518.52	531.68
Unredeemed Taxes:		
Levy of 1966		7,904.05
Levy of 1965	4,823.47	2,962.79
Levy of 1964	1,378.40	755.79
Levy of 1963	500.76	500.76
Levy of 1962	68.02	68.02
Levy of 1961	56.32	56.32
Levy of 1960	404.15	404.15
	7,231.12	12,651.88
Uncollected Taxes:		
Levy of 1967	\$	\$100,239.55
Levy of 1966	79,669.27	3,127.00
Levy of 1965	272.68	
Levy of 1964	488.25	
Levy of 1963	186.15	
	80,616.35	103,366.55
State Head Taxes:		
Levy of 1967	\$	\$ 2,675.00
Levy of 1966	2,260.00	30.00
Levy of 1965	15.00	
Levy of 1964	30.00	
	2,305.00	2,705.00
Total Assets (Grand Total)	\$367,254.82	\$341,562.07

(\*) Not verified - Trustees records incomplete

<u>Liabilities</u>	<u>December 31, 1966</u>	<u>December 31, 1967</u>
Appropriations Carried Forward:		
Town Hall	\$ 375.00	\$
Fire House Commission - Special	1,850.00	1,802.00
Fire Department		396.38
Town Hall Special		2,500.00
Parks & Playgrounds		2,201.25
Planning & Zoning		1,500.00
Reappraisal Special		8,000.00
	\$ 2,225.00	\$ 16,399.63
Due State:		
State Head Taxes:		
Uncollected	\$ 2,260.00	\$ 2,675.00
Collected - Not Remitted	617.00	641.00
	2,877.00	3,316.00
Bond & Debt Retirement - 1966	114.83	
Due School District	328,612.42	281,469.61
Capital Reserve Fund (Contra)	4,179.96	6,179.96
Special Fund Road Building (Contra)	1,518.52	531.68



Due Tax Collector a/c Excess Remittance		15.00
1968 Tax Payments		<u>50.70</u>
Total Liabilities	\$339,527.73	\$307,962.58
Surplus	<u>27,727.09</u>	<u>33,599.49</u>
Grand Total	\$367,254.82	\$341,562.07

EXHIBIT A-2  
Analysis of Change in Financial Condition  
Fiscal Year Ended December 31, 1967

Surplus - December 31, 1967	\$ 33,599.49	
Surplus - December 31, 1966	<u>27,727.09</u>	
Increase in Surplus		\$ 5,872.40

Analysis of Change

Increases:		
Net Budget Surplus	\$ 5,916.99	
Overpayments a/c Property Taxes	<u>4.15</u>	
		\$ 5,921.14
Decrease:		
Tax Collector's Excess Debits - (Net)		<u>48.74</u>
Net Increase		\$ 5,872.40

## EXHIBIT A-3

## Comparative Statement of Appropriations and Expenditures Fiscal Year Ended December 31, 1967

	Appropriations Carried From 1966	Appropriations 1967	Receipts & Reimburse.	Total Amount Available	Expenditures 1967	Balances		Appropriations Carried To 1968
						Unexpended	Overdrafts	
Town Officers' Salaries	\$	\$ 3,100.00	\$	\$ 3,100.00	\$ 3,100.00	\$	\$	\$
Town Officers' Administrative Expense		9,777.00	107.88	9,884.88	10,873.70		988.82	
Election & Registration Exp.		594.94		594.94	642.32		47.38	
Municipal Court Expenses		610.00		610.00	620.00		10.00	
Town Hall & Other Bldgs	375.00	2,515.00		2,890.00	2,069.16	820.84		
Social Security & Retirement		2,442.00		2,442.00	2,292.00	150.00		
Police Department		31,170.00	222.00	31,392.00	32,493.59		1,101.59	
Race Track Police			988.00	988.00	1,036.00		48.00	
Dog Officer		400.00		400.00	402.00		2.00	
Fire Department		11,207.00	343.91	11,550.91	11,154.53	200.00		(1) 396.38
Blister Rust & Care of Trees		200.00		200.00				
Insurance		2,774.95	447.93	3,222.88	3,227.28	374.44	4.40	
Planning & Zoning		375.00	200.00	575.00	200.56			
Building Permit Fees			1,449.10	1,449.10	1,312.10	137.00		
Reappraisal Assistance		800.00		800.00	719.86	80.14		
Damages & Legal Expense		1,550.00		1,550.00	1,371.70	178.30		
Civilian Defense		500.00		500.00	336.32	163.68		
Health Department		75.00		75.00	75.00			
Vital Statistics		125.00		125.00	116.00	9.00		
Town Dump		2,000.00		2,000.00	2,000.00			
Town Road Aid		957.78		957.78	957.88		.10	
Town Maintenance - Summer		15,000.00	112.64	15,112.64	14,834.21	278.43		
Town Maintenance - Winter		22,000.00		22,000.00	26,862.76		4,862.76	
Town Maintenance - Resealing		10,000.00		10,000.00	9,649.47	350.53		
Street Lighting		2,350.00		2,350.00	2,351.16		1.16	
General Expenses of Hwy Dept.		1,500.00		1,500.00	914.00	586.00		
Library		6,440.00		6,440.00	6,440.00			
Old Age Assistance		2,500.00	17.05	2,517.05	2,096.23	420.82		
Town Poor		4,500.00	84.60	4,584.60	1,590.30	2,994.30		
Veterans' Aid		50.00		50.00		50.00		
Memorial Day		300.00		300.00	300.00			
Parks & Playgrounds		150.00		150.00		150.00		





**EXHIBIT A-4**  
**Statement of Estimated and Actual Revenues and Budget Summary**  
**Fiscal Year Ended December 31, 1967**

	Revenues		Excess	Deficit
	Estimated	Actual		
Interest & Dividends Tax	\$ 2,283.85	\$ 2,283.85	\$	\$
Savings Bank Tax	374.47	374.47		
Reimbursement a/c State & Federal Lands	13.10			13.10
Interest on Taxes	2,300.00	2,315.46	15.46	
Business Licenses, Permits & Filing Fees	500.00	399.00		101.00
Dog Licenses	800.00	843.00	43.00	
Motor Vehicle Permit Fees	40,000.00	44,705.60	4,705.60	
Rent of Town Property	100.00	131.00	31.00	
Head Tax Commission	1,100.00	1,085.00		15.00
Fines & Forfeits - Municipal Court	1,000.00	1,200.00	200.00	
Added Taxes		163.10	163.10	
	<u>\$48,471.42</u>	<u>\$53,500.48</u>	<u>\$5,158.16</u>	<u>\$ 129.10</u>

Budget Summary

Actual Revenues	\$53,500.48	
Estimated Revenues	<u>48,471.42</u>	
Revenue Surplus		\$5,029.06
Unexpended Balances of Appropriations	\$ 8,850.51	
Overdrafts of Appropriations	<u>7,962.58</u>	
Net Unexpended Balance of Appropriations		<u>887.93</u>
Net Budget Surplus		\$5,916.99

EXHIBIT B-1  
Classified Statement of Receipts and Expenditures  
Fiscal Year Ended December 31, 1967

Receipts

Current Revenue:

From Local Taxes:

Current Year:

Property Taxes	\$658,380.04
Poll Taxes	2,836.00
State Head Taxes	<u>8,870.00</u>

\$670,086.04

Taxes Redeemed by Purchaser Other than Town (Contra)

19.01

Prior Years:

Property Taxes	76,287.80
Poll Taxes	732.00
State Head Taxes	2,140.00
Interest on Taxes	2,315.46
State Head Tax Penalties	237.00
Tax Sales Redeemed	<u>5,253.94</u>

\$ 757,071.25

1968 Tax Payments

50.70

From State:

Interest & Dividends Tax	\$ 2,283.85
Savings Bank Tax	374.47
Reimbursement a/c Forest Fires	143.86
Reimbursement a/c Head Tax Expense	48.03
Reimbursement a/c Old Age Assistance	<u>17.05</u>

2,867.26

From Local Sources, Except Taxes:

Dog Licenses	\$ 843.00
Business Licenses, Permits & Filing Fees	399.00
Fines & Forfeits - Municipal Court	1,200.00
Motor Vehicle Permit Fees	44,705.60
Rent of Town Property	<u>131.00</u>

47,278.60

Appropriation Credits:

Race Track Police	\$ 988.00
Building Permit Fees	1,449.10
Town Officers' Expenses	59.85
Police Department	222.00
Fire Department	200.05
Planning & Zoning	200.00
Town Poor	84.60
Insurance	447.93
Town Maintenance - Summer	112.64
Interest	<u>134.44</u>

3,898.61

Receipts Other Than Current Re		
Temporary Loans	\$167,000.00	
Cemetery Fence (Contra)	<u>245.00</u>	
		<u>167,245.00</u>
Total Receipts From All Sources		\$ 978,411.42
Balance - January 1, 1967		<u>271,403.87</u>
Grand Total		\$1,249,815.29
<u>Expenditures</u>		
<u>General Government:</u>		
Town Officers' Salaries	\$ 3,100.00	
Town Officers' Expenses	10,873.70	
State Tax Commission Audit	512.27	
Election & Registration Expenses	642.32	
Municipal Court	620.00	
Town Hall & Town Buildings	2,069.16	
Reappraisal of Property	<u>719.86</u>	
		\$ 18,537.31
<u>Protection of Persons &amp; Property:</u>		
Police Department	\$ 32,493.59	
Race Track Police	1,036.00	
Fire Department	11,154.53	
Insurance	3,227.28	
Civilian Defense	336.32	
Planning & Zoning	200.56	
Building Permit Fees	<u>1,312.10</u>	
		49,760.38
<u>Health &amp; Sanitation:</u>		
Health Department	\$ 75.00	
Vital Statistics	116.00	
Dump & Garbage Removal	<u>2,000.00</u>	
		2,191.00
<u>Highways &amp; Bridges:</u>		
Town Road Aid	\$ 957.88	
Town Maintenance - Summer	\$ 14,834.21	
Town Maintenance - Winter	26,862.76	
Town Maintenance - Resealing	<u>9,649.47</u>	
	51,346.44	
Street Lighting	2,351.16	
General Expense of Highway Department	<u>914.00</u>	
		55,569.48
<u>Library</u>		
		6,440.00
<u>Public Welfare:</u>		
Old Age Assistance	\$ 2,096.23	
Town Poor	<u>1,590.30</u>	
		3,686.53
<u>Patriotic Purposes:</u>		
Memorial Day		300.00
<u>Public Service Enterprises:</u>		
Cemeteries	\$ 1,500.00	
Cemetery Fence (Contra)	<u>245.00</u>	
		1,745.00



Unclassified:

Legal Expenses	\$ 1,339.70	
Taxes Bought by Town	10,747.45	
Dog Damage	32.00	
Employees' Retirement & Social Security	1,092.00	
Retirement - Special	1,200.00	
Dog Officer	402.00	
Discounts, Abatements & Refunds	29.74	
Taxes Redeemed by Purchaser other Than Town (Contra)	<u>19.01</u>	

14,861.90

New Construction, Equipment & Improvements:

Town Construction	\$ 15,000.59	
Road Signs - Special	727.20	
Parks & Playgrounds - Special	298.75	
Fire House Commission - Special	48.00	
Cemetery Special	<u>2,912.45</u>	

18,986.99

Indebtedness:

Temporary Loans	\$167,000.00	
Interest	1,378.30	
Payment to Capital Reserve Fund	<u>2,000.00</u>	

170,378.30

Payments to Other Governmental Divisions:

County Tax	\$ 34,086.09	
Bond & Debt Retirement	114.83	

State Head Taxes:

Levy of 1966	\$ 2,691.00	
Levy of 1967	<u>7,432.00</u>	

10,123.00

School District:

1966-1967 School Tax	\$326,907.48	
1967-1968 School Tax	<u>320,000.00</u>	

646,907.48691,231.40

Total Expenditures For All Purposes

\$1,033,688.29

Balance - December 31, 1967

216,127.00

Grand Total

\$1,249,815.29

EXHIBIT B-2  
Summary of Receipts, Expenditures and Proof of Balance  
Fiscal Year Ended December 31, 1967

Balance - January 1, 1967	\$271,403.87	
Receipts During Year	<u>978,411.42</u>	
		\$1,249,815.29
Expenditures During Year		<u>1,033,688.29</u>
Balance - December 31, 1967		\$216,127.00

Proof of Balance

Balance in the Salem Trust Company - Per Statement December 29, 1967	\$ 250,219.43	
Add: Deposits of January, 1968	<u>14,945.42</u>	
	\$ 265,164.85	
Less: Outstanding Checks	<u>49,045.35</u>	
	\$ 216,119.50	
Add: Bad Check Redeposited January 3, 1968	<u>7.50</u>	
Reconciled Balance - December 31, 1967		\$216,127.00

EXHIBIT C-1  
Summary of Warrants  
Fiscal Year Ended December 31, 1967

			Levies of:		
DR.	1967	1966	1965	1964	1963
Uncollected Taxes - January 1, 1967:					
Property Taxes	\$	\$78,891.27	\$266.68	\$476.25	\$186.15
Poll Taxes		778.00	6.00	12.00	
Taxes Committed to Collector:					
Property Taxes	758,165.67				
Poll Taxes	3,808.00				
Added Taxes:					
Property Taxes	81.00	2.10			
Poll Taxes	20.00	60.00			
Overpayments a/c Property Taxes	4.15				
Interest Collected	<u>71.86</u>	<u>1,786.64</u>	<u>27.25</u>	<u>41.60</u>	<u>43.95</u>
	\$762,150.68	\$81,518.01	\$299.93	\$529.85	\$230.10
CR.					
Remittances to Treasurer:					
Property Taxes	\$658,380.04	\$75,657.97	\$215.94	\$227.74	\$186.15
Poll Taxes	2,836.00	732.00			
Interest	71.86	1,786.64	27.25	41.60	43.95
Abatements Allowed:					
Property Taxes	553.23	120.40		248.51	
Poll Taxes	70.00	96.00	6.00	12.00	
Uncollected Taxes - December 31, 1967:					
Property Taxes	99,317.55	3,115.00			
Poll Taxes	<u>922.00</u>	<u>12.00</u>			
	\$762,150.68	\$81,520.01	\$249.19	\$529.85	\$230.10
Add: Excess Debit a/c Property Taxes			50.74		
Less: Excess Credit a/c Poll Tax		<u>2.00</u>			
	\$762,150.68	\$81,518.01	\$299.93	\$529.85	\$230.10

EXHIBIT C-2  
Summary of State Head Tax Warrants  
Fiscal Year Ended December 31, 1967

<u>DR.</u>	Levies of:			
	<u>1967</u>	<u>1966</u>	<u>1965</u>	<u>1964</u>
Uncollected Head Taxes - January 1, 1967	\$	\$2,260.00	\$15.00	\$30.00
Taxes Committed to Collector	11,665.00			
Added Taxes	55.00	165.00		
Penalties Collected	26.00	211.00		
	<u>\$11,746.00</u>	<u>\$2,636.00</u>	<u>\$15.00</u>	<u>\$30.00</u>
<u>CR.</u>				
Remittances to Treasurer:				
Head Taxes	\$ 8,870.00	\$2,140.00	\$	\$
Penalties	26.00	211.00		
Abatements Allowed	175.00	255.00	15.00	30.00
Uncollected Head Taxes - December 31, 1967	<u>2,675.00</u>	<u>30.00</u>		
	<u>\$11,746.00</u>	<u>\$2,636.00</u>	<u>\$15.00</u>	<u>\$30.00</u>

EXHIBIT C-3  
Summary of Tax Sale Accounts  
Fiscal Year Ended December 31, 1967

<u>DR.</u>	Levies of:						
	<u>1966</u>	<u>1965</u>	<u>1964</u>	<u>1963</u>	<u>1962</u>	<u>1961</u>	<u>1960</u>
Unredeemed Taxes -							
January 1, 1967	\$	\$4,823.47	\$1,378.40	\$500.76	\$68.02	\$56.32	\$404.15
Tax Sale - June 24, 1967	10,747.45						
Interest & Costs After Sale	72.66	168.11	103.39				
	<u>\$10,820.11</u>	<u>\$4,991.58</u>	<u>\$1,481.79</u>	<u>\$500.76</u>	<u>\$68.02</u>	<u>\$56.32</u>	<u>\$404.15</u>
<u>CR.</u>							
Remittances to Treasurer:							
Redemptions	\$ 2,858.40	\$1,860.68	\$ 534.86	\$	\$	\$	\$
Interest & Costs	72.66	168.11	103.39				
Abatements			87.75				
Unredeemed Taxes -							
December 31, 1967	<u>7,904.05</u>	<u>2,962.79</u>	<u>755.79</u>	<u>500.76</u>	<u>68.02</u>	<u>56.32</u>	<u>404.15</u>
	<u>\$10,835.11</u>	<u>\$4,991.58</u>	<u>\$1,481.79</u>	<u>\$500.76</u>	<u>\$68.02</u>	<u>\$56.32</u>	<u>\$404.15</u>
Less: A/C Excess							
Remittance	15.00						
	<u>\$10,820.11</u>	<u>\$4,991.58</u>	<u>\$1,481.79</u>	<u>\$500.76</u>	<u>\$68.02</u>	<u>\$56.32</u>	<u>\$404.15</u>



EXHIBIT D  
Statement of Town Clerk's Accounts  
Fiscal Year Ended December 31, 1967

DR.

Motor Vehicle Permits Issued:

1966 - Nos. 500508-500661	\$	773.35
1967 - Nos. 113718-116800)		
Nos. 510601-511131)		43,775.52
1968 - Nos. 270001-270013		156.73

\$44,705.60

Dog Licenses Issued:

314 @ \$2.00	\$	628.00
33 @ \$5.00		165.00
2 @ \$12.00		24.00
1 @ \$25.00		25.00
	\$	842.00

Less: 350 Fees @ \$.20

70.00

71 Penalties Collected @ \$1.00

\$ 772.00

71.00

843.00

Filing Fees

9.00

\$45,557.60

CR.

Remittances to Treasurer:

Motor Vehicle Permit Fees		\$44,705.60
Dog Licenses & Penalties		843.00
Filing Fees		9.00

\$45,557.60

EXHIBIT E

Summary of Trust Fund Principal, Income and Investments  
Fiscal Year Ended December 31, 1967

RECORDS NOT AVAILABLE FOR AUDIT

EXHIBIT F-1  
Statement of Cemetery Trustees' Accounts and Proof of Balance  
Fiscal Year Ended December 31, 1967

Balance - January 1, 1967	\$	22.57	
 Receipts:			
Town Appropriation		\$1,500.00	
Sale of Lots		275.00	
Income From Trust Fund		<u>1,811.47</u>	
			3,586.47
			<u>\$3,609.04</u>
 Expenditures:			
Labor		\$2,647.46	
Expenses & Supplies		711.67	
Equipment & Repairs		<u>152.00</u>	
			<u>3,511.13</u>
Balance - December 31, 1967			\$97.91

Proof of Balance

Balance in the Second National Bank of Nashua -			
Per Statement January 22, 1968			\$97.91

EXHIBIT F-2  
Cemetery Lumber Fund  
Fiscal Year Ended December 31, 1967

Balance - January 1, 1967	\$	217.56	
 Receipts:			
Interest on Deposit		<u>8.76</u>	
Balance - December 31, 1967			\$226.32

Proof of Balance

Balance in the Second National Bank of Nashua -			
Savings Book #60823			\$226.32

EXHIBIT G  
Statement of Public Library Trustees' Accounts and Proof of Balance  
Fiscal Year Ended December 31, 1967

Balance - January 1, 1967		\$1,617.15	
Receipts:			
Town Appropriation	\$6,440.00		
Income from Trust Funds	<u>93.06</u>		
		6,533.06	
		<u>\$8,150.21</u>	
Expenditures:			
Salaries	\$3,582.00		
Books, Magazines & Supplies	2,411.93		
Library Administration	189.79		
Building	1,066.87		
Miscellaneous	<u>52.20</u>		
		<u>7,302.79</u>	
Balance - December 31, 1967			\$847.42
<u>Proof of Balance</u>			
Balance in the Second National Bank of Nashua -			
Per Statement of December 29, 1967		\$1,353.02	
Add: Deposit in Transit		<u>40.57</u>	
		\$1,393.59	
Less: Outstanding Checks		<u>546.17</u>	
Reconciled Balance - December 31, 1967			\$847.42



EXHIBIT H  
Municipal Court  
Statement of Receipts, Expenditures and Proof of Balance  
Fiscal Year Ended December 31, 1967

Balance - January 1, 1967 \$ 59.34

Receipts:

Fines & Forfeits	\$1,640.00	
Small Claims' Fees	60.80	
Bail	435.00	
Miscellaneous Receipts	74.90	
	2,210.70	
		\$2,270.04

Expenditures:

Motor Vehicle Department	\$ 350.00	
Town of Pelham	1,200.00	
Small Claims' Fees	60.80	
Office Supplies & Expenses	180.90	
Clerk's Bond	10.00	
Dues	5.00	
Bail Returned	435.00	
	2,241.70	
		\$28.34

Balance - December 31, 1967 \$28.34

Proof of Balance

Balance in the Second National Bank of Nashua -  
Per Statement December 28, 1967

\$28.34

Criminal Cases - 127  
Small Claims - 31

EXHIBIT I  
Town Officers' Surety Bonds  
1967

	<u>Number</u>	<u>Amount</u>	<u>Term Beginning</u>
<b>Tax Collector:</b>			
Ivy Chadwick			
New Hampshire Insurance Company	88-43-21	\$27,000.00	March 14, 1967
<b>Town Treasurer:</b>			
Albert R. Harris			
New Hampshire Insurance Company	86-80-29	\$25,000.00	March 14, 1967
<b>Town Clerk:</b>			
Faye B. Emerson			
New Hampshire Insurance Company	89-99-15	\$10,000.00	March 14, 1967
<b>Road Agent:</b>			
Robert Fletcher			
New Hampshire Insurance Company	85-46-02	\$ 4,000.00	March 14, 1967
<b>Trustees of Trust Funds:</b>			
R. H. Richardson			
New Hampshire Insurance Company	85-46-05	\$ 9,000.00	March 9, 1965
James P. Emerson			
New Hampshire Insurance Company	92-75-39	\$ 9,000.00	March 24, 1967
Miles J. Cares			
New Hampshire Insurance Company	90-28-85	\$ 9,000.00	March 8, 1966

## TREASURER'S REPORT

Received from:

Faye B. Emerson, Town Clerk:

1968 Auto Permit Fees	\$ 156.73
1967 Auto Permit Fees	43,775.52
1967 Filing Fees	9.00
1967 Dog Licenses	816.20
1966 Auto Permit Fees	773.35
1966 Dog Licenses	26.80
	<hr/>

\$ 45,557.60

Ivy N. Chadwick, Tax Collector:

1967 Poll Taxes	\$ 2,820.00
1967 Property Taxes	658,465.90
1967 Head Taxes	8,875.00
1967 Head Tax Penalties	26.00
1967 Interest	87.64
1966 Poll Taxes	720.00
1966 Property Taxes	65,410.03
1966 Head Taxes	2,100.00
1966 Head Tax Penalties	208.00
1966 Interest	1,429.05
1963-64-65 Property Taxes	629.83
1966 Tax Sale Redemptions	2,858.40
1966 Tax Sale Redemptions, Interest & Costs	69.63
1965 Tax Sale Redemptions	1,951.61
1965 Tax Sale Redemptions, Interest & Costs	103.34
1964 Tax Sale Redemptions	517.23
1964 Tax Sale Redemptions, Interest & Costs	107.84
1964-65-66 Tax Sale Redemptions, Interest & Costs	9.00
1967 Tax Sale	10,747.45
1966 Poll Taxes	\$ 12.00
1966 Property Taxes	10,247.84
1966 Interest	454.61
1966 Head Taxes	30.00
1966 Head Tax Penalties	3.00
	<hr/>

757,135.95

State of New Hampshire:

Warden's Services	\$ 42.80
Old Age Recovery	17.05
Head Tax Reimbursement	48.03
Forest Fires, Refund	101.06
Savings Bank Tax	374.47
Interest & Dividend Tax	2,283.85
	<hr/>

2,867.26

Licenses and Permits:

Beano Licenses	\$ 130.00
Building Permits	1,449.10
Junkyard Licenses	150.00
Milk Licenses	46.00
Oil Burner Permits	164.00
Pistol Permits	60.00
Slaughter House License	2.00
Taxi License	2.00
	<hr/>

2,003.10



**Salem Trust Company:**

Loans in Anticipation of Taxes  
Interest Rebate

\$167,000.00  
134.44

167,134.44

**Other Sources:**

Ambulance Refund \$ 25.00  
Bicycle Registrations 197.00  
Board of Adjustment Hearings 200.00  
Copy Machine Fees 16.75  
Fire Department Payroll Refund 10.00  
Insurance Refunds 801.57  
Junk Fire Refund 26.05  
Pelham Municipal Court 1,200.00  
New Hampshire Breeders' Assoc. 612.00  
New Hampshire Jockey Club, Inc. 376.00  
Rent of Town Hall 131.00  
    Pelham Grange #244 \$92.00  
    Thelma Boutwell 39.00  
Road Refund 4.00  
Sales of Building Regulations 43.10  
Welfare Refund 84.60

3,727.07

Total Receipts

\$ 978,425.42

Cash on Hand, January 1, 1967

271,403.87

Total

\$1,249,829.29

Less: Selectmen's Orders Paid

1,033,688.29

Non-negotiable Check

14.00

Cash on Hand, December 31, 1967

\$ 216,127.00

**Proof of Balance:**

Balance in Salem Trust Company

Per Statement, December 30, 1967

\$250,219.43

Add: Deposits of January 3, 1968

14,952.92

Total

\$265,172.35

Less: Outstanding Checks

49,045.35

Cash on Hand

\$216,127.00

Respectfully submitted,

ALBERT R. HARRIS

Treasurer

## DETAILED STATEMENT OF PAYMENTS

### TOWN OFFICERS' SALARIES

Albert D. Nolin, Chairman of Selectmen	\$ 600.00
James P. Emerson, Selectman	500.00
Peter E. Morin, Selectman	500.00
Albert R. Harris, Treasurer	500.00
Ivy N. Chadwick, Tax Collector	700.00
Faye B. Emerson, Town Clerk	<u>300.00</u>

\$ 3,100.00

### TOWN OFFICERS' EXPENSES

#### Selectmen's Expenses:

Albert D. Nolin	\$ 114.10
James P. Emerson	228.00
Peter E. Morin	227.60

#### Office Expenses:

Secretary, Muriel F. Pelton	3,300.00
Supplies	308.60
Postage	234.03
Telephones	229.76
Deeds and mortgages	84.15
Dues, N. H. Municipal Assoc.	142.75
Dues, Assessors Association	5.00
Boat Reports from State	21.16
Repairs to copy machine	43.00
Cleaning and repairing typewriter	42.60
Printing Town Reports	1,537.20
Advertising bids	22.00
Rent of P. O. Box and Safety deposit box	6.80
Extra help in office, M. F. Pelton	29.70
Extra help in office, I. N. Chadwick	21.60
Copy of 1967 Statutes	25.00
New adding machine	139.50
Eight new chairs	287.60
Rural mail box	8.00

#### Town Clerk, Faye B. Emerson:

Motor vehicle fees	1,975.00
Supplies	127.74
Dues	6.00
Expenses, convention	88.00
Postage	38.00
New typewriter	214.65

#### Overseer of Public Welfare, James P. Emerson

Supplies	55.00
----------	-------

#### Budget Committee Clerk, Sandra Corbin

53.55

#### Treasurer, Albert R. Harris:

Supplies	26.70
Postage	31.46

#### Building Inspector, Albert E. Hirsch:

Supplies	41.00
Expenses	10.00

#### Tax Collector, Ivy N. Chadwick:

Postage	172.05
Supplies	163.27
Recording at Registry	60.50

Dues	5.00	
Redemption fees	33.70	
Tax Sale fees	109.53	
Head Tax fees, 3%	330.30	
Expenses	<u>124.10</u>	
		10,873.70
ELECTION & REGISTRATION		
Supervisors of Check List:		
Austin Burns	\$ 100.00	
Richard Mansfield	100.00	
Randall Richardson	100.00	
Ballot Clerks:		
Ann Carner	12.00	
Theodora Constantin	12.00	
J. Edmund Mellen	12.00	
Jeannette Surprenant	12.00	
Moderator:		
Frederick Houle	30.00	
Janitor, Town Meeting:		
Frederick Mansfield	27.50	
Lorin Raymond, Jr.	27.50	
Janitor, Postponed meeting:		
Frederick Mansfield	10.00	
Lorin Raymond, Jr.	10.00	
Supplies	20.32	
Chair rental, Town Meeting	32.00	
Postponed meeting	32.00	
Ballots	81.00	
Lunch, for meeting	<u>24.00</u>	
		642.32
MUNICIPAL COURT		
Judge, J. Albert Lynch	\$ 300.00	
Clerk, Edwin M. Hartz	180.00	
Special Justices:		
Velikhka & Kozowski	60.00	
Smith, Welts, Robertson & McGinnis	60.00	
Guertin & Widener	<u>20.00</u>	
		620.00
TOWN HALL & OTHER BUILDINGS		
Janitor Services:		
Thelma Boutwell	\$ 294.13	
Irven Parker	24.00	
Fuel, oil	556.04	
Lights, Granite State Electric Co.	195.08	
Gas for kitchen	19.50	
Repairs to light fixtures	13.50	
Repairs to roof	590.00	
Carpet rental	49.30	
Signs	41.50	
Snow removal	2.00	
Purchase of vacuum cleaner	189.75	
Town clock maintenance	60.00	
Misc. supplies	<u>34.36</u>	
		2,069.16



# POLICE DEPARTMENT

## Payroll:

Chief, Ralph S. Boutwell	\$ 7,000.00
Officer, Roland L. Boucher	5,500.00
Russell Corbin	5,200.00
Special Officers (see details following Chief's report)	6,006.10
Answering service, Harriet Mansfield	520.00
Secretary, Glennie Edwards	137.00

## Officers' expenses:

Chief Boutwell	110.00
Officer Boucher	3.00
Officer Corbin	8.20
Special Officer Atwood	12.20
Special Officer Greenwood	8.20

Police clothing allowance 126.05

## Cruiser:

New purchase	2,150.00
Parts and repairs	540.25
Tires and tubes	539.06
Gas and oil	3,287.84

Police Association dues 10.00

Badges and shields 51.81

Radio, parts and repairs 122.71

Postage 30.00

Telephones 524.86

Fuel, oil 79.90

Bicycle plates 107.84

Blood tests 35.00

Ambulance service 108.00

Resuscitators refilled - 1/2 cost 18.75

Miscellaneous supplies 200.96

New files 38.42

Witnesses mileage fees 17.44

32,493.59

# FIRE DEPARTMENT

## Payroll:

Chief, Richard C. Mansfield	\$ 3,000.00
Call firemen (see details following Chief's report)	3,554.85
Answering service, Harriet Mansfield	520.00

Telephones 420.23

Fuel, oil 261.17

Lights 423.60

Snow removal 34.00

Resuscitator refilled - 1/2 cost 18.75

Repairs: To heating plant 8.50

To siren 12.00

To well pump 89.34

Trucks: Gas and oil 294.13

Parts and repairs 114.85

Tires 203.52

Radio: New purchase 214.22

Parts and repairs 335.43

Supplies: Miscellaneous 188.10

Badges 3.97

Extinguishers & refills 297.10

Gloves	21.75	
Dome light	85.00	
Red flares	15.75	
Indian pumps	125.16	
Axes and tools	42.63	
Hose	666.50	
Coats	97.10	
Air tanks	62.50	
Gas for kitchen	<u>44.38</u>	
		11,154.53
PLANNING AND ZONING		
Board of Adjustment:		
Postage	\$ 30.92	
Legal notices	134.64	
Planning Board:		
Legal advice:		
Winer, Lynch and Gormley	<u>35.00</u>	
		200.56
INSURANCE		
Library	\$ 244.33	
Workmen's Compensation	911.66	
Officials' Bonds	353.00	
Liability	182.96	
Auto Policy	1,207.58	
Accident Policy	<u>327.75</u>	
		3,227.28
CIVIL DEFENSE		
Fixing Rescue truck	\$ 159.60	
Rescue kit	160.35	
Radio, parts and repairs	8.37	
Supplies	<u>8.00</u>	
		336.32
HEALTH DEPARTMENT		
Paid to Alton M. Hodgman	\$ 75.00	
		75.00
VITAL STATISTICS		
Fees, paid to Faye B. Emerson	\$ 116.00	
		116.00
DOG OFFICER		
Salary:		
Frank Foisie	\$ 200.00	
Ralph Boutwell	100.00	
Expenses:		
Frank Foisie	<u>102.00</u>	
		402.00
TOWN DUMP		
Paid to Alexander Roketenetz	\$ 2,000.00	
		2,000.00
SUMMER MAINTENANCE		
Payroll:		
Machinery	\$ 8,158.75	
Labor	1,991.28	
Sand and gravel (see details following Highway Agent report)	653.80	
Pipe	366.14	
Metal for bridge	7.14	
Cold patch	1,765.09	
Signs	82.50	

Tar		485.77	
Brooms		8.50	
Crushed stone		203.96	
Drilling and blasting		87.15	
Seed		8.80	
Grates		62.00	
Catch basins		93.69	
Supplies		63.38	
Paving at Town Hall		600.00	
Manhole blocks		141.36	
Posts		44.90	
Towing car at Town Hall		10.00	
			14,834.21
WINTER MAINTENANCE			
Payroll:	Machinery	\$ 13,590.50	
	Labor	4,003.25	
	Sand and gravel (see details following Highway Agent report)	608.00	
New snow plow		939.00	
Salt		6,047.56	
Chain falls		41.00	
Canvas		58.80	
Wing and brace		360.50	
Plow parts and repairs		1,195.96	
Shipping charges		2.59	
Supplies		15.60	
			26,862.76
T. R. A.			
	Paid to State of New Hampshire	\$ 957.88	
			957.88
STREET LIGHTING			
	Paid to Granite State Electric Co.	\$ 2,351.16	
			2,351.16
GENERAL EXPENSES OF HIGHWAY DEPARTMENT			
Legal Advice:	Hamblett, Kerrigan & Hamblett	\$ 15.00	
Surveying:	Robert Thorndike	699.00	
Land purchases		200.00	
			914.00
RESEALING			
Payroll:	Labor	\$ 69.13	
	Sand & gravel	1,050.00	
Tar		3,749.36	
Sealcoating		4,780.98	
			9,649.47
LIBRARIES			
	Paid to Trustees	\$ 6,440.00	
			6,440.00
OLD AGE ASSISTANCE			
	Paid to State of N. H.	\$ 2,096.23	
			2,096.23
TOWN POOR			
	American Ambulance Service	\$ 35.00	
	Capitol Super Market	15.00	
	Hudson Super Duper Market	80.00	
	Laconia Clinic	50.00	



Lowell General Hospital	362.50	
Moore General Hospital	800.37	
Nashua Memorial Hospital	103.80	
Dr. Provencher	65.00	
Spaulding Youth Center	<u>78.63</u>	1,590.30
MEMORIAL DAY		
Paid to Post #100	\$ 300.00	300.00
APPRAISAL ASSISTANCE		
Paid to State of N. H.	\$ 719.86	719.86
CEMETERIES		
Paid to Trustees	\$ 1,500.00	1,500.00
LEGAL EXPENSES		
Paid to Hamblett, Kerrigan & Hamblett	\$ 1,339.70	1,339.70
DOG DAMAGE		
Paid to: Walter Nickerson	\$ 22.00	
Raymond Ouellette	<u>10.00</u>	32.00
RETIREMENT AND SOCIAL SECURITY		
Paid to Arthur Peabody	\$ 1,200.00	
Paid to Police Retirement System	1,062.00	
Paid to Fire Retirement System	<u>30.00</u>	2,292.00
INTEREST		
Paid to Salem Trust Company	\$ 1,378.30	1,378.30
NEW CONSTRUCTION		
CURRIER ROAD:		
Payroll: Machinery	\$2,863.25	
Labor	264.88	
Sand & gravel	662.40	
Drilling & blasting	2,469.80	
Pipe	172.64	
Supplies	<u>73.86</u>	
	\$ 6,506.83	
ECONOMOU DRIVE:		
Payroll: Machinery	\$ 345.50	
Labor	21.25	
Sand & gravel	206.40	
Tar	<u>533.58</u>	
	1,106.73	
ROBINSON ROAD:		
Payroll: Machinery	\$4,127.50	
Labor	342.38	
Sand & gravel	889.80	
Drilling & blasting	486.45	
Pipe	<u>29.40</u>	
	5,875.53	
WEBSTER AVENUE:		
Payroll: Machinery	\$ 733.50	
Sand & gravel	300.00	

Paving two driveways	434.00		
		1,467.50	
For general use:			
Stakes		17.00	
Supplies		27.00	
			15,000.59
STATE AUDIT			
Paid to State of N. H.		\$ 512.27	
			512.27
CEMETERY SPECIAL			
Land purchase, paid to Dorice Hayes		\$ 2,500.00	
Legal fees, Hamblett, Kerrigan & Hamblett		412.45	
			2,912.45
RECREATION COMMITTEE SPECIAL			
Files		\$ 59.50	
Postage		52.80	
Supplies		61.45	
Legal fees, Hamblett, Kerrigan & Hamblett		125.00	
			298.75
ROAD SIGN SPECIAL			
Ray Road Equipment		\$ 332.30	
Posts, Pelham Hardware		296.30	
Welding: Robert Hirsch		4.00	
Rte #38 Welding Service		94.60	
			727.20
CAPITAL RESERVE			
Paid to Trustees of Trust Funds		\$ 2,000.00	
			2,000.00
RACE TRAFFIC			
Payroll: Reimbursed by N. H. Jockey Club, Inc., and N. H. Trotting and Breeding Association		\$ 1,036.00	
			1,036.00
REPAIR TO CEMETERY FENCE			
Damage done by motor vehicle, reimbursed completely by Insurance		\$ 245.00	
			245.00
BUILDING INSPECTOR'S FEES			
Paid to: Albert E. Hirsch, out of funds turned in to Treasurer by him		\$ 1,312.10	
			1,312.10
FIRE/POLICE COMMITTEE			
Paid to W. R. Nolte & Associates		\$ 48.00	
			48.00
TAXES BOUGHT BY TOWN			
Tax Sale		\$ 10,747.45	
			10,747.45
DISCOUNTS, ABATEMENTS, ETC.			
Paid out to Individuals		\$ 48.75	
			48.75
HEAD TAX PAYMENT			
Paid to State of New Hampshire		\$ 10,123.00	
			10,123.00
BOND, DEBT AND RETIREMENT TAX			
Paid to State of N. H.		\$ 114.83	
			114.83

SCHOOL DISTRICT		
Paid to Treasurer, School District	\$646,907.48	646,907.48
TEMPORARY LOANS		
Paid to Salem Trust Company	\$167,000.00	167,000.00
COUNTY TAX		
Paid to Hillsborough County	\$ 34,086.09	<u>34,086.09</u>
	TOTAL PAYMENTS	\$1,033,688.29

## REPORT OF HIGHWAY AGENT

This report is more for people who have lived in Pelham a short time and do not understand the way work is done on our highways and the reasons.

First of all, we have over 20 miles of roads which are maintained and plowed by the New Hampshire Department of Public Works and Highways under their direct supervision, at no cost directly from our local taxes. Secondly, the Town does not own any equipment except the snow plows that are mounted on privately owned trucks. These are hired on a part-time basis as needed; the equipment used for summer maintenance and new construction is also hired in the same manner. There are no full time employees, and this is why people are amazed when they call and find me out of town or on some other job other than town road work. I am available if an emergency arises, however, the summer maintenance, resealing and new construction work, has to be scheduled when the hired equipment is available.

I have recommended that the Town build or construct a salt bin on Town-owned land, as the present location is on private land which cost the Town nothing, except labor. With the increasing number of tar roads and satisfaction of residents in our using salt to treat ice in the winter, I feel this will be a permanent installation.

In keeping with this, I feel serious consideration should be given to the establishment of a full time, two-man department, with a truck suitable for the various summer jobs and also for plowing in the winter with the hired equipment.

Respectfully submitted,

ROBERT B. FLETCHER  
Highway Agent

### DETAILED REPORT OF HIGHWAY AGENT'S PAYROLL

#### Labor:

Beauregard, Robert	\$ 4.00
Bergeron, Peter	100.00
Bergeron, Robert L.	417.00
Boutwell, Kenneth	50.00
Brunelle, Thomas	10.00
Carleton, Frank	10.00
Coleman, Frederick	520.55
Corbin, William	167.00
Ducharme, Joel	3.50
Edwards, Robert G.	10.00
Fisher, Peter	57.00
Fletcher, Robert	1,553.75
Foisie, Donald	34.00
Foley, James	87.00
Forrest, Frank	54.00
Foss, Donald	976.00
Garland, George	14.00
Maiocchi, John	58.00
Maiocchi, Dennis	4.00
Melanson, Richard	378.00
Mendes, Daniel Jr.	70.00
Neskey, Stanley Jr.	12.00
Potter, Charles	329.00
Potter, Edward	396.00
Provencal, Thomas	30.00
Rooks, Roger	34.00
Spaulding, Chester Jr.	69.00



Spaulding, Chester W.	13.00
Spaulding, George	258.00
Spaulding, Victor	236.00
Teague, Timothy	599.37
Therriault, Adrien	15.00
Therriault, Charles W.	40.00
Therriault, Ronald	40.00
Yerger, Charles	43.00
	<u>\$ 6,692.17</u>
Proof:	
Summer	\$ 1,991.28
Winter	4,003.25
Resealing	69.13
New Construction	264.88
New Construction	21.25
New Construction	342.38
	<u>\$ 6,692.17</u>
Machinery:	
Neal Balcom	\$ 1,324.50
Nathan Boutwell	282.00
Frank Carleton	636.00
Robert Fletcher	157.50
Donald Foss	457.00
Frank Forrest	1,548.50
George Garland	82.50
Golden Brook Construction Corporation	1,618.00
Hirsch Brothers, Inc.	16,166.50
Jan-Nan, Incorporated	168.00
Daniel Mendes, Jr.	129.00
Frederick Mansfield	25.00
George Neskey	2,011.50
Frank Nietupski	150.50
Irven Parker	322.50
Chester W. Spaulding	3,651.50
Stephen Straughan	12.00
Charles Therriault	16.50
Ronald Therriault	1,060.00
	<u>\$29,819.00</u>
Proof:	
Summer	\$ 8,158.75
Winter	13,590.50
New Construction	2,863.25
New Construction	345.50
New Construction	4,127.50
New Construction	733.50
	<u>\$29,819.00</u>
Sand and Gravel:	
Raymond Allard	\$ 429.30
Robert Fletcher	316.00
Golden Brook Construction Corporation	598.80
Hirsch Brothers, Inc.	344.00
George Muldoon	327.80
Chester Spaulding	2,174.00
Charles Therriault	180.50
	<u>\$ 4,370.40</u>

Proof:

Summer	\$ 653.80
Winter	608.00
Resealing	1,050.00
New Construction	662.40
New Construction	206.40
New Construction	889.80
New Construction	<u>300.00</u>
	\$ 4,370.40

# BUILDING INSPECTOR'S REPORT

## BREAKDOWN OF PERMITS ISSUED IN 1967

NUMBER	DESCRIPTION	ESTIMATED COST
51	Single dwellings	\$ 624,800.00
3	Apartment buildings	141,000.00
5	Two-family dwellings	66,000.00
3	Business buildings	50,000.00
5	Swimming pools	13,400.00
2	Repairs to fire damaged houses	6,000.00
1	Supermarket	125,000.00
12	Alterations	10,700.00
29	Additions	50,360.00
3	Garages	4,070.00
1	Garage & workshop	1,200.00
1	Dwelling covered with aluminum siding	1,795.00
1	Storage building	800.00
1	Cabinet & woodworking shop	10,000.00
3	Installations, septic tank & leach field	1,450.00
2	Repair septic systems	700.00
<u>1</u>	<u>Workshop</u>	<u>300.00</u>
124		\$1,107,575.00

## FINANCIAL REPORT

Fees for 124 permits	\$1,436.10	
13 Renewals @ \$1.00	<u>13.00</u>	
Total cash received		\$1,449.10
Total turned over to Treasurer	\$1,449.10	
Paid to A. E. Hirsch	<u>1,312.10</u>	
Total to town		\$ 137.00

## REPORT OF BOARD OF ADJUSTMENT

The Board of Adjustment meets regularly on the second Monday of each month to hear any appeals. In order to be heard, the application must be in the hands of the Clerk of the Board not later than ten days before the next scheduled meeting, together with a fee of ten dollars, which is the charge for an appeal. Public notice is given in the Nashua Telegraph and posted in the Post Office and the Town Hall ten days prior to the hearing, and personal notice is sent to the applicant and to the abutters.

During the year, twenty cases were heard and decided, after carefully taking into account all the aspects of each case, and hearing the comments of anyone having anything to say concerning the case during the public hearing.

Changes in membership occurring during the year were as follows: In April, Willis Atwood was appointed to the Board; in October, resignations were received and regretfully accepted from Richard Avery and Charles Hauser. Delmar Parent and James Gannon were appointed to fulfill their unexpired terms.

HAVEN STROUT, Chairman  
WILLIS ATWOOD, Vice-Chairman  
FABIAN CHIASSON, Clerk  
DELMAR PARENT  
JAMES GANNON  
R. IRVING BUCK, Alternate  
ROBERT DICKIE, Alternate  
HAROLD PITTS, Alternate



## REPORT OF THE FOREST FIRE WARDEN AND YOUR DISTRICT CHIEF

The year of 1967 will go down in history as a wet year although the early spring was dry and windy. During this time, we had many fires, unnecessary fires caused by carelessness and disregard for the common-sense fire laws and regulations. This lack of responsibility on the part of a few people hurts everyone. Let's work together to prevent the start of those unnecessary fires by:

1. No burning between 9:00 A.M. - 5:00 P.M. and then only with a permit from the Forest Fire Warden.
2. Take all debris and waste to the town dump.
3. Keep a clean, safe town dump.
4. Urge close supervision of children in regard to use of matches.
5. Exercise care with smoking material - use the ashtray.

### NUMBER OF FIRES & ACRES BURNED

	<u>Fires</u>	<u>Acres</u>
State	408	520
District	113	97-3/4
Town	12	13-3/4

WINTHROP H. HANNAFORD  
District Chief

RICHARD C. MANSFIELD  
Warden

## FIRE DEPARTMENT CALLS FOR 1967

Date	Type of Fire	Property Owner	Location of Fire
Jan. 30	Partition in house	Robert Doherty	Jeremy Hill Road
Feb. 4	House	Vasilios A. Theodore	Tallant Road
	Mal-functioning Oil Burner	Norman Destosiers	Bridge Street
Mar. 14	Kitchen	George Tessier	Marsh Road
	Barn	James P. Emerson	Windham Road
Apr. 13	Grass	Mrs. Barbara Teague	Nashua Road
	Auto	Mrs. Richard Pendergast	Hobbs Road
	Grass & Brush	Walter Jarek	Tallant Road
	Partition in house	Hernan Carter	Castle Hill Road
	Fat on stove	Joseph Falardeau	Tallant Road
	Grass	Mrs. Alice Coombs	Tallant Road
	House	Frederick Gariepy	Marsh Road
May 12	Brush	Armand Groulx	Pulpit Rock Road
	Auto	Roger Clermont	Currier Road
	Grass	David Curran	Belvina Circle
	Brush	Harvey Perreault, Jr.	Bridge Street
	Brush	Anthony Therriault	Little Island Pond
	Grass	Louis A. Fineman	Bridge Street
	Chimney	William G. Foss, Sr.	Gumpus Pond Road
	Brush	Walter Patenaude	Jericho Road
June 3	Leaves & Pine Needles	Mary Lyon	Bridge Street
	Grass	Alfred Moras	Gage Hill Road
	Truck	Steve's Used Cars	Gage Hill Road
	Kitchen	John Lawrence	Clearview Avenue
July 6	Garage	Norman Perigny	Hobbs Road
	False Alarm	Fred Sheehan	Windham Road
Aug. 4	Gas Stove	Romeo Croteau	Ledge Road
	Electrical mal-function	James Fitzgerald	Wharf Road
Sept. 12	Auto (stolen)	Charles Malamas	Off Tallant Road
	Brush	Wayne Bariteau	Castle Hill Road
	Electrical mal-function	Edward Chandonnet	Gage Hill Road
Oct. 21	Grass	Victor Lemire	Jericho Road
	Storage Building	William D. Smith	Nashua Road
Nov. 2	Abandoned house	Town	Mammoth Road
Dec. 17	Grass	Victor Lemire	Jericho Road
Dec. 24	False alarm	James P. Emerson	Windham Road

Brush & Grass fires	13
Auto & truck fires	4
Building fires	10
Chimney fires	1
False alarms	2
Miscellaneous	<u>6</u>
Total	36

# OTHER EMERGENCY CALLS

Date	Type of Call	Property Owner	Location
Apr. 2	Assisting at accident	Mrs. Roberta Zelonis	Mammoth Road
July 11	Washing machine short-circuit	Mrs. Paul Labranche	Chagnon Lane
Aug. 4	Electrical mal-function	Hartley's Barn	Mammoth Road
Nov. 14	Washing highway after accident	Stolen car	Mammoth Road

RICHARD C. MANSFIELD  
Fire Chief & State Fire Warden

# FIRE DEPARTMENT PAYROLL

Atwood, Daniel S.	\$182.10	Ivers, Timothy	\$ 4.50
Atwood, Frank W.	106.90	Hobbs, Charles W III	1.50
Atwood, Herbert H.	107.55	Lapoint, Edmund	66.75
Atwood, Willis H.	160.65	Lawrence, Norman Jr.	4.50
Balcom, Arnold V.	64.10	Lawrence, Norman Sr.	4.50
Balcom, Graham	19.50	Leonard, Russell	34.55
Bergeron, Robert L.	6.00	Lovely, Donald	4.50
Boutwell, Nathan	11.10	Mansfield, Frederick	318.00
Burton, Robert J.	9.50	Mansfield, Richard	255.50
Cares, Miles J.	100.90	Melanson, Frank	30.85
Carleton, Frank O.	29.80	Melanson, Richard	146.15
Coleman, Frederick	4.50	Melanson, William	109.55
Coleman, Michael	1.50	Nariniak, John	3.00
Constantin, James	24.00	Porter, Hugh	70.30
Corbin, Gary	30.00	Raymond, Lorin Jr.	143.45
Corbin, Russell	86.95	Raymond, Lorin Sr.	65.55
Corbin, Patrick	15.75	Robinson, Roger	102.90
Cowdry, Roy	23.00	Richardson, Herbert	6.80
Currier, Herbert	60.05	Richardson, Herbert Jr.	6.00
Derby, Richard	174.85	Richardson, John	6.00
Edwards, Robert M.	19.80	Robb, Robert C.	1.70
Fletcher, Robert	68.70	Spaulding, Chester W.	3.00
Forrest, Frank	17.45	Spaulding, George	3.00
Foss, Donald	6.00	Spaulding, Victor	3.00
Greenwood, James	88.35	Slater, David	148.50
Hilbert, Arthur	4.25	Straughan, Stephen	157.20
Hirsch, Robert H.	86.95	Staniec, Thomas	14.25
Hobbs, Charles W.	152.70	Silloway, Roy	45.50
Hobbs, Robert	4.50	Shirer, Robert	1.50
Hodgman, Alton	9.00	Therriault, Charles W.	83.70
Holt, James Jr.	26.25	Therriault, Ronald	1.50
Horskins, Sanford Sr.	3.00	Tuttle, David	1.50
			<u>\$3,554.85</u>



## POLICE DEPARTMENT

The time has come again for us to forget that which has transpired and to plan for the future.

We have had a very busy year as the records will show; 3,888 calls this past year. The workload has increased tremendously. As more and more cars are put on the road, accidents increase. The number of cars plus other factors such as the weather, carelessness and the lack of courtesy on the highway, are the main causes of accidents. As more houses are built and new businesses come into town, the duties of the Police Department increase.

Pelham has had a series of house breaks during the past year, as have surrounding towns, who have also been hit very hard. Much time has been spent in investigating these breaks both day and night. It is with this mention, that I would like to bring to your attention the new rulings by the Supreme Court, which virtually tie the hands of today's policemen. A suspect cannot be interrogated by the police without having his lawyer present, who immediately informs him "not to say a word." The outlaws and gangsters are given protection which you and I do not have. The general public is not aware of these barriers until something comes along which affects them personally. Several times the police have known that a subject has taken part in breaks, etc., but because of this new ruling are unable to further their authority. Also, Pelham, being a border town, is more susceptible to these incidents, because of the heavier traffic flow, etc.

I would like to make mention of the second cruiser which I am recommending to the budget committee. This would be available for emergencies that arise especially when the other cruiser is out of town. I'm sure everyone is aware of the fact that our trips to the hospitals are not 1 and 2 mile trips, such as those made by the city police, but 8, 9 and 10 mile trips, as we have to travel to Lowell, Nashua and Lawrence. Our trips are even more hindered by bad weather and slippery driving, which takes that much longer. With the new D. W. I. law, an officer may be making a routine check of an accident, but come upon a D. W. I. case which takes him nearly 3 hours to complete, and 10 miles from home. The party must be picked up, taken to the Nashua Memorial Hospital for a blood test, then taken to the Nashua Police Department where he is then booked. Also, there should be 2 officers, as there has to be a witness to all this. During these trips, other emergencies are arising back in town, which leaves us unprotected. I do not intend to use this vehicle on a 24-hour basis, but would use it for emergencies, investigations and at accidents. It is impossible for one cruiser to cover 27 square miles of area.

An extra officer has also been submitted for approval. In the daytime, I am required to spend a considerable amount of time in the office, answering calls, returning calls on accident reports, etc., and more and more people are coming to the station seeking information and assistance. I need assistance in emergency situations, resuscitator calls, accidents, directing ambulances, and house and business establishment breaks. It is impossible for one man to handle alone. As an example, while aiding in resuscitation of a person, you can't leave and go to meet the ambulance to direct them to the scene. There has been quite a few miles increased on the school bus routes also. I realize that this officer won't be able to stop house breaks, but could possibly help deter it. Often there are times when an officer is requested to investigate a nuisance, prowlers, speeders and rough parties, which are quite often in the summer months, especially at the various swimming places.

At present, the two regular officers work a 45-hour week and I work a 52-hour week, plus I work when my help is needed at an accident or with breaks, etc.

When we read about the surrounding towns plagued with problems on vandalism, rowdy crowds, etc., we can be proud of the youth in Pelham, in the manner in which they conduct themselves. Naturally, there are always a few who cannot come under this category.

During the past year, the regular officers have attended the police seminars which are conducted at St. Anselm's College. In addition to this, Officer Corbin attended the State Police School in Concord, which is a three week course. If the new officer is approved, he will also be trained at this same school.

It has been asked of me what constitutes a miscellaneous call and why they aren't listed under the category of "types of calls." This is just a light run-down of these types of calls, and in no way are they a reflection on those who made them, which are of importance to that person at the time: Request to have cruiser check suspicious car in area; check car side of road; report person sick or dead; deliver message to people or member of family sick or passed away; locate child who has failed to return home after school, scout meeting or other function, and usually deliver same to home; children throwing articles or ice and snowballs at passing motorists; is laundromat open; any races today; any school today; are roads O. K.; where can we have water tested; is liquor store open; where was my car towed; cows or horses loose in road; barking dogs, can't sleep; dispose of dead cat; dead animal in road;



where can we get dog groomed; what time does post office open; water in my cellar, what can I do?; what time does town hall open. This is just a general run-down of these calls, where someone had to answer same, and are accounted for in the log. I could go on and on.

I would like to take this opportunity to thank the Police Relief Association who has so generously donated to the department, and has done so for a number of years now. This year a tranquilizer gun was purchased (\$240) to be used in aiding rescue to injured animals. They have also taken it upon themselves to financially aid the Civil Defense truck with needed equipment. There are a number of items that the Association can be thanked for, which are given to the town at no cost to the taxpayer.

It was through the instruction of those present at last year's town meeting, that the committee to investigate costs and plans for a combination fire and police station, continue their investigation and report their findings at the 1968 town meeting. This we have done, and have come up with a plan which we hope is acceptable. Every year that this is detained, the costs are increased just that much more. We do need the facilities desperately. One incident, we had over 25 young teenagers who were involved in a beer party. We had no facilities to detain and question these young people. Anyone who has visited our present station is aware of the small cubicles which this department is expected to work with.

I would like to take this opportunity to thank the Selectmen and other Town Officials who have assisted me and the townspeople for their cooperation and also the Police Officers who work with me in this department.

Respectfully submitted,

RALPH S. BOUTWELL  
Chief of Police

# MISCELLANEOUS CALLS - 1967

Miscellaneous Assistance	1,942	Juvenile & Vandals	33
Resuscitator	8	Alarms	2
Ambulance	31	Request Houses Checked (on vacations)	89
Reports of Power Failure	69	Windows Found Open	23
Fires Reported	21	Doors Found Open	31
Dog Complaints	310	Medical Examiner	2
Dog Bites Reported	47	Stolen Property Recovered	13
Assistance to Other Departments	260	Report of Stolen Property	34
Assistance from Other Departments	52	Phone No Answer	16
Prowlers	14	Asst. /Money Transfer	163
Breaks	31	Accidental Shooting	1
Cruiser - Hospital	50	Obscene Phone Calls	13
School	36	Larceny (Check)	1
Domestic	24	Stolen Cars Recovered	13
Suicides	1	Illegal Possession of Alcoholic Beverages	6
Warnings Issued	84	Misrepresenting Age	1
D & E's Issued	24	Minors Transporting Alcoholic Beverages	2
Missing Persons	12	Lewdness	2
Summons Served	65	Bicycles Registered	394
Road Complaints	17		

## NUMBER AND TYPES OF ACCIDENTS FOR 1967:

Hit & Run	10	Car and Bus	2
Truck and Ditch	1	Car and Motorcycle	1
Car and Truck	4	Car and Pedestrian	1
Car and Tree	20	Car and House	1
Car and Pole	7	2 Car Accidents	26
Car and Fence	2	Bus and Post	1
Car and Wall	7	Bus and Truck	1
Car and Ditch	16	Truck and Wall	1
Car and Trailer	1	Truck and Post	2
Car and Bike	4		

# POLICE DEPARTMENT - SPECIAL POLICE PAYROLL

Atwood, Daniel S.	\$ 5.10	Hanlon, Arthur	45.90
Atwood, Willis H.	486.20	Herbert, C. Warren	5.10
Bariteau, Wayne	637.50	Kopacz, Mitchell	399.50
Boland, Thomas	91.80	Malburne, Louis	17.00
Boucher, Roland	506.60	Manty, Frederick	589.90
Carleton, Frank	73.10	Nash, Stewart	28.90
Corbin, Russell	654.50	Newcomb, John	528.70
Daley, Ralph	34.00	Nantel, Maurice	13.60
Foisie, Frank	674.90	Richardson, Herbert	180.20
Greenwood, Arthur Jr.	120.70	Silloway, Roy	11.90
Hilbert, Arthur	62.90	Tuttle, David	217.60
Hodgman, Alton	620.50		<u>\$6,006.10</u>

## RACE TRAFFIC PAYROLL

Atwood, Willis	\$ 75.00	Hanlon, Arthur	18.00
Bariteau, Wayne	36.00	Herbert, C. W.	18.00
Boland, Thomas	18.00	Herkomer, Gottfried	30.00
Boucher, Roland	324.00	Kopacz, Mitchell	9.00
Boutwell, Ralph	8.00	Newcomb, John	18.00
Carleton, Frank	72.00	Richardson, Herbert	410.00
			<u>\$1,036.00</u>

## REPORT OF THE POLICE STATION-FIRE HOUSE COMMITTEE

The Pelham Town Meeting of 1966 appropriated the sum of \$2,500 to enable this committee to secure land options and preliminary architectural drawings. This report details the steps taken by the committee and the reasoning behind its recommendations.

### Site Study Phase.

Considerable time and discussion was devoted to the location of the proposed building. The major factors considered were site size, availability, cost and geographical location. With these factors in mind, along with a tentative decision to restrict the search to the "greater center area," a listing of thirteen possible sites was prepared and descriptions of these parcels were obtained. The full committee visited each of the sites and agreement was reached on four sites, one of these being Town-owned land.

Letters were sent to four landowners inviting them to meet with the committee. Two landowners responded to the request and discussed the cost and availability of their respective parcels.

The committee then decided to concentrate on the Town-owned land as THE site and a request was made of the Selectmen to have the Town Engineer survey the parcel at the corner of Marsh and Nashua Roads (the site of the old Town Hall).

### Recommendation

THAT THE SITE FOR THE PROPOSED COMBINATION POLICE AND FIRE STATION BE THE TOWN-OWNED LAND AT THE CORNER OF MARSH AND NASHUA ROADS.

### Factors

- i. Geographical location gives immediate access to all major town roads irrespective of which area of town is "developed" next.
- ii. Retains the "center" characteristic and adds to this area the first municipal building constructed in over thirty years.
- iii. Does not require the expenditure of monies for land acquisition - constructive use of Town-owned land.
- iv. Close to the buildings which temporarily house the largest numbers of people - the schools and churches.

### Building Study Phase.

The question "Do we need a new fire house and police station?" is readily answered in the affirmative when both the use factor and available space of the present building are considered. These factors are detailed below.

The lower level is used for the housing of four fire trucks in an area designed to accommodate three trucks, along with the supplies and equipment peculiar to a Fire Department's operation. The way in which this equipment is placed in the available area is a splendid example of "packaging." This concept is correct if all of this equipment were simply being stored, BUT IT IS NOT! This is the same equipment used to protect the lives of approximately 5,000 inhabitants and their property valued in excess of ten million dollars. The facts we face now are that there is no room to store additional apparatus at the present station and that any expansion is impossible for the building has been expanded to cover almost all of the present site.

The upper level is partitioned into two meeting rooms, two small offices for the use of the Police Department, the Chief of Police and the Civil Defense Department, along with several free-standing storage lockers. Entry to any of these areas is through a single door at the sides of the meeting rooms. The current practice of locating the Police Department, which is a permanent, full-time branch of the Town Government, in this area along with the two meeting rooms being scheduled both afternoons and evenings for various civic activities, i. e., Scouts, First Aid Courses, Civil Defense Courses, etc. has resulted in some very awkward and embarrassing situations in regard to effective and professional police work such as:

- i. Normal entry and exit is by an OUTSIDE staircase to the SECOND FLOOR.
- ii. No detention facilities.
- iii. No privacy.
- iv. Lack of file space and data security.
- v. Communication facilities housed in an open corner of the room which is also the department headquarters.
- vi. The Chief of Police shares the office with the Civil Defense group.
- vii. No storage area for major or minor pieces of equipment such as a boat and trailer, present or additional police vehicles, etc.

### Recommendation

THAT THE TOWN VOTE IMMEDIATE APPROVAL OF THE PROPOSED COMBINATION POLICE AND FIRE STATION.

### Factors

In light of the discussion above, the pertinent factors hardly need enumeration. Anyone who has visited the present facility could perhaps add to the points raised in this report by considering parking areas, etc.



Formulation and Finalization. At this point, the committee engaged the services of Fenton G. Keyes, Associates, Consulting Architects-Engineers to assist in the drawing up of some preliminary sketches and plans - using as a basis the ideas and suggestions that the committee had gathered in their individual visits to the facilities of the surrounding towns.

The building proposed by this committee for Town Meeting action is presented in the accompanying figures showing front elevation, floor plan and building placement on the proposed site.

Some of the pertinent specifications are listed below.

<u>Designation</u>	<u>Size</u>	<u>Area</u>
Apparatus Room	50' x 62'	3100 sf
Watch & Communication Room	13' x 10'	130 sf
Fire Chief's Room	19' x 10'	190 sf
Day Room	19' x 17'	323 sf
Boiler & Maintenance Room	19' x 15.5'	295 sf
Booking Room	19' x 11.5'	219 sf
Police Chief's Office	14' x 9.5'	133 sf
Cell Room	10' x 10'	100 sf
Locker Room	8.5' x 10'	85 sf
Two-car Garage or Duty Room -		
Interrogation Room	19' x 23'	437 sf
Architectual Space (wall, toilets, corridors, etc.)		<u>836 sf</u>
		5,848 sf

#### Budget Figures

Building costs	\$65,000
Land costs	NONE
Architect's fee	4,550
Clerk of the Works	NONE
Contingencies	<u>450</u>
	\$70,000

(Projected cost/sq. ft. = \$65,000/5,848 sf = \$11.10/sq. ft.)

#### Recommendation

THAT THE TOWN VOTE TO RAISE AND APPROPRIATE THE SUM OF SEVENTY THOUSAND DOLLARS (\$70,000) FOR THE CONSTRUCTION OF THE PROPOSED COMBINATION POLICE AND FIRE STATION. (See Appendix I, Item 1)

#### Factors

- i. Exit and entrance at both ends of apparatus room.
- ii. Adequate area for fire apparatus at this central station.
- iii. Building and placement adds to aesthetic beauty of the center of town.
- iv. Functional building incorporating a minimum of niceties.
- v. Door and overhead clearance ample for future additions such as a hook and ladder truck, etc.
- vi. Consideration was given to constructing just the apparatus room and the police wing along with the alternate approach of constructing the apparatus room, police wing and just the shell of the fire wing. These approaches were discarded when they were considered in light of rising construction costs and the requirement of providing the facilities (light, heat, power, water, sewerage, etc.) during this construction phase.

#### Conclusions

The committee feels that the proposed building is adequate to meet the current and immediate future needs of the Town. However, we do feel that the following recommendations, which result from the various areas touched upon in this study, do round out the report in that they do not deal with the proposed building or site, but with topics that are deserving of consideration and/or study.

This committee further recommends:

- A. That the Town vote the proposed hardened shelter (see Appendix I, Item 3) as its Civil Defense Headquarters.
- B. That the meeting rooms be designated as a Civic Area and continue to be made available to the numerous civic groups. (See Appendix I, Item 4)

- C. That the Town retain ownership of the older Model A fire trucks for their civic use in parades, musters, etc. along with their practical use in brush and forest fires due to their high road clearance.
- D. That consideration be given to the acquisition of a small boat, motor and trailer for police and fire use.
- E. That the Town purchase the Parsonage property.
- F. That the Town terminate Marsh Road at Common Road to allow safer traffic flow.
- G. That the Fire Department develop a philosophy of expansion using the proposed building as a central station and construct future sub-stations in those areas of Town having the greatest population density.
- H. If this proposal does not obtain the approval of the Town Meeting, that the article setting up the twenty thousand dollars (\$20,000) Capital Reserve Fund pass in the affirmative. (See Appendix I, Item 2)

Respectfully submitted,

PHILIP J. McLAIN, Chairman  
 JAMES E. POWERS, Secretary  
 ALBERT R. HARRIS  
 ALBERT D. NOLIN, Selectman  
 RALPH S. BOUTWELL, Police Chief  
 RICHARD C. MANSFIELD, Fire Chief

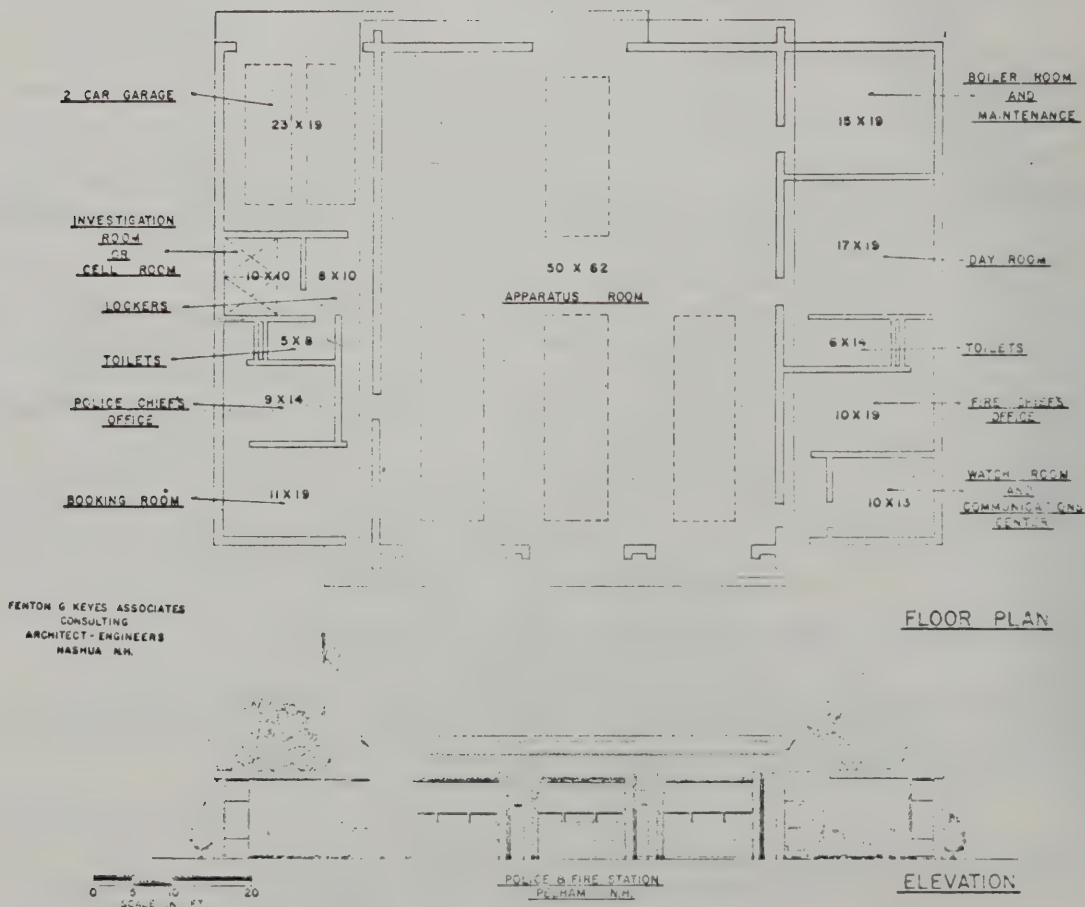

## APPENDIX I

### BUDGETORY ITEMS PROPOSED BY THE FIRE HOUSE/POLICE STATION COMMITTEE

- Item 1. To see if the Town will vote to authorize the Selectmen to construct a combination police and fire station building on land owned by the Town at the intersection of Marsh and Nashua Roads, being the site of the Old Town Hall, after giving due consideration to the recommendations for such building as made by the Police Station and Fire House Committee; to appropriate the sum of \$70,000.00 for this purpose and to raise said \$70,000.00 by the issuance of serial notes of the Town payable over a five-year period in equal annual principal amounts, at interest not to exceed 4 per cent per annum, pursuant to the provisions of the Municipal Finance Act, Chapter 33, Section 8, of the New Hampshire Revised Statutes Annotated, and to authorize the Selectmen and the Treasurer to negotiate said notes in the name of and on behalf of the Town, and any and all balances remaining after payment in full for said building shall revert to a capital reserve fund for the purchase of a fire truck and/or other major equipment for the Fire Department.

#### Detail

<u>Maturity Date</u>	<u>Principal</u>	<u>Interest</u>	<u>Payments (Option 1)</u>	<u>(Option 2)</u>
1968	14,000	2,240.00	16,240.00	15,344.00
1969	14,000	1,792.00	15,792.00	15,344.00
1970	14,000	1,344.00	15,344.00	15,344.00
1971	14,000	896.00	14,896.00	15,344.00
1972	<u>14,000</u>	<u>448.00</u>	<u>14,448.00</u>	<u>15,344.00</u>
	70,000	6,720.00	76,720.00	76,720.00

- Notes: 1. Currently the town has no outstanding bonded indebtedness.  
2. The interest rate is estimated at 3.2%.

- Item 2. To see if the Town will vote to raise and appropriate the sum of \$20,000 to set up a Capital Reserve Fund for the future construction of a combination fire house/police station building, or take any other action relative thereto.

- Item 3. To see if the Town will vote to raise and appropriate the sum of \$8,000 for the purpose of including as a matching fund item, a hardened Civil Defense shelter within the proposed fire house/police station building, or take any other action relative thereto.

Note: This is a matching fund item, Civil Defense 50%, Town of Pelham 50%. Reimbursement after construction.

- Item 4. (No expenditure item) To see if the Town will authorize the Selectmen to dispose of the present fire house building.

## MUNICIPAL COURT

Cases handled in Pelham Municipal Court  
Year ending December 31, 1967

Non-support	2
Refusal to obey an officer of the law	1
Assault and battery	5
Zoning ordinance	1
Kindling fire without permit	1
Lewdness	2
Stop sign	22
Too many passengers in truck cab (5)	1
No tail lights	3
Operating uninspected motor vehicle	5
Driving while intoxicated	4
Speeding	17
Operating unregistered vehicle	10
Excessive noise (motor vehicle)	2
Operating without a license	8
Crossing yellow line	21
Allowing improper person to operate	1
Operating truck without commercial license	1
Leaving scene of accident	1
Operating vehicle with inadequate equipment	2
Misuse of registration plates	1
Operating without registration in possession	1
Reckless operation	1
Failure to wear corrective lenses	1
Operating motorcycle without face or eye protection	1
Operating motorcycle without approved head gear	1
Transportation of beer by minor	2
Illegal possession of beer by a minor	6
Misrepresenting age to procure beer	1
Operating boat without life preservers	1
Operating unregistered boat	1
Small Claims	<u>31</u>
	158

(Financial report shown in State Tax Commission Audit)

Respectfully submitted,

J. ALBERT LYNCH, Justice  
EDWIN M. HARTZ, Clerk



## HEALTH OFFICER

The following cases of communicable diseases have been reported to the Health Officer during the year 1967.

Mumps	48
Scarlet Fever	6
Ringworm	2
Strep Throat	18
Rheumatic Fever	2
Chicken Pox	84
Impetigo	12
Pediculosis	2
Measles	5
Dog bites reported for 1967 were	47.

Boarding home licenses have been issued in conjunction with the New Hampshire State Department of Public Welfare for the boarding of children as follows:

- 3 Children, either sex - infancy to 5 years
- 4 Children, either sex - infancy to 12 years
- 2 Children, either sex - infancy to 14 years
- 4 Children, either sex - infancy to 16 years
- 3 Children, either sex - 2 years to 12 years.
- 4 Children, either sex - 6 years to 16 years
- 1 Child, either sex - 16 to 18 years

Several complaints have been received regarding disposal systems and in each case the owners were advised that New Hampshire Law provides that waste material from sinks, toilets, etc. must be conveyed away underground in a manner so as not to be offensive. One investigation was made by the N. H. Water Pollution Commission at my request of a sewage system at Little Island Pond, and a dye test confirmed pollution was entering the pond and the situation was corrected.

I wish to thank Terry Hauser, School Nurse, for reporting cases of communicable diseases in the Pelham schools.

I also wish to express my sincere thanks for all courtesies that were extended to me in the investigations carried out during the year.

Sincerely yours,

ALTON M. HODGMAN  
Health Officer

## CIVIL DEFENSE DIRECTOR'S REPORT

All the equipment making up 3 Radef Units located within the Town of Pelham was exchanged during the year and each unit was periodically checked to assure proper working order and battery strength.

Standard and advanced First Aid classes were held during 1967 and several Police and Auxiliary Police Officers graduated along with some Firemen. Classes sponsored by C. D. were conducted by the American Red Cross and Leo Bongers, Jr. was the Class Instructor.

Contact was made with State C. D. to furnish information regarding Matching Funds for an Emergency Operating Center to be located in the new proposed Fire and Police station. Plans were passed along to the architects. The Matching Funds Program would have paid one-half of the costs of the Emergency Operating Center.

The Town of Pelham is no longer eligible for Matching Funds because of the lack of a Hardened Emergency Operation Center, therefore, no purchases were made under the Matching Funds program.

Our RACES group continues to participate in one hour practice sessions every Tuesday evening. Routine messages are received and sent along with practice Radef messages.

Two Fallout Shelters have been designated for Pelham, one at the St. Patrick Hall and one at Memorial School, and official signs have been placed on the two buildings.

Our Auxiliary Police Unit continues to be very active and assists the regular Police with church traffic, answering telephone and as extra men for cruiser patrol. A special project during 1967 was the repair of a van type truck to be used as a Rescue Truck for the Town of Pelham.

A second-hand truck was purchased by the Pelham Police Association and members of the Auxiliary Police, under the direction of Police Officers John Newcomb, Wayne Bartlett and Michael Kapez, overhauled the motor and reconditioned the body of the truck, painted the truck and installed emergency lights and a C. D. Forestry Band Radio.

I wish to thank publicly, the following:

Robert Fletcher, Nate Boutwell and Arthur Seaman for the free use of their garages for storage of the vehicle and facilities for working on the truck to get it into shape;

The Pelham Police Relief Association for their generous donation of money for the truck and some supplies;

The Lions Club for their donation toward the purchase of a porta-power tool for the rescue truck;

Ray's Auto Parts for donations of parts for the rescue truck.

I sincerely hope that other organizations will make contributions this year of other necessary emergency rescue equipment. Those desiring to make a contribution should contact either the new C. D. Director or Ralph Boutwell, Chief of Police.

Arrangements have been made and classes have been scheduled for training in the use of Radef instruments to be conducted early in 1968.

This is my last report as C. D. Director for the Town of Pelham. I will continue to work in Civil Defense, and have recently accepted an appointment by A. B. Trowbridge, Secy. of Commerce to the National Defense Executive Reserve, and in the event of an escalated conventional war or an attack on the U. S., I will be required to report to a pre-arranged Government Center, thus my services would not be available to the Town of Pelham.

I wish to extend my thanks for the assistance I have received as your C. D. Director and my thanks and gratitude to those who have participated in the various C. D. programs and classes over the past few years.

I urge your continued support of the various C. D. functions in the future and for your sake as well as mine, I wish the new C. D. Director many successful programs in the future.

ALTON M. HODGMAN  
C. D. Director

## TOWN WARRANT

### THE STATE OF NEW HAMPSHIRE

To the Inhabitants of the Town of Pelham in the County of Hillsborough in said State, qualified to vote in Town Affairs:

You are hereby notified that the annual meeting of the Town of Pelham will take place on Tuesday, March 12, 1968 at 10:00 o'clock in the forenoon at the E. G. Sherburne School in said Pelham for the election of Town Officers, and to act upon the subjects listed below. The polls for the election of Town Officers at said place will be open on said date at 10:00 o'clock in the forenoon and will not close earlier than 8:00 o'clock in the evening.

1. To raise such sums of money as may be necessary to defray town charges for the ensuing year and make appropriations of the same, that is to see if the Town will vote to accept the Town Budget as prepared by the Budget Committee and to take action thereon.

2. To see if the Town will authorize the Selectmen, or a majority thereof, and the Town Treasurer to borrow necessary money in anticipation of taxes.

3. To see if the Town will vote to raise and appropriate the sum of \$1,091.62 as the Town's share of Town Road Aid, the State to contribute \$7,277.46 as the State's share, as provided by law. (Approved by the Budget Committee)

4. To see if the Town will vote to raise and appropriate the sum of \$2,000.00 to add to the Capital Reserve Fund, for the purpose of purchasing a fire truck, or take any other action relative thereto.

5. To see if the Town will vote to raise and appropriate the sum of \$8,000.00 due in 1968 for the purpose of completing the appraisal of all taxable real properties in the Town by the New Hampshire Tax Commission as authorized by the 1967 annual meeting of the Town. (Approved by the Budget Committee)

6. To see if the Town will vote to adopt the following Ordinance as permitted by Chapter 41 Section 11 of the New Hampshire Revised Statutes Annotated;

It shall be unlawful for the owner, operator or other person having the care, custody or control of any motor vehicle to park such motor vehicle on any public street or highway on any day in the Town of Pelham between the hours of twelve midnight and seven A.M. from December 15 to April 1 of each year, except in the case of an emergency. The fine for each violation of this Ordinance shall be \$10.00 and all motor vehicles found by the police to be in violation thereof shall be towed away at the owner's expense.

7. To see if the Town will vote to authorize the Selectmen to construct a combination police and fire station building on land owned by the Town at the intersection of Marsh and Nashua Roads, being the site of the Old Town Hall, after giving due consideration to the recommendations for such building as made by the Police Station and Fire House Committee.

8. To see if the Town will vote to appropriate the sum of \$70,000.00 for the purpose of constructing a combination police and fire station building as authorized under Article 7 above of this Warrant; and to raise the said sum of \$70,000.00 by the issuance of serial notes of the Town payable over a five-year period in equal annual principal amounts, at interest not to exceed 4-1/4 per cent per annum, pursuant to the provisions of the Municipal Finance Act, Chapter 33, Section 8 of the New Hampshire Revised Statutes Annotated, and to authorize the Selectmen and the Treasurer of the Town to negotiate said notes in the name of and on behalf of the Town, and any and all balances remaining after payment in full for said building shall revert to a capital reserve fund for the purchase of a fire truck and/or other major equipment for the Fire Department. (Approved by the Budget Committee)



9. To see if the Town will vote to raise and appropriate the sum of \$20,000.00 to set up a Capital Reserve Fund for the future construction of a combination fire house/police station building, or take any other action relative thereto.

10. To see if the Town will vote to raise and appropriate the sum of \$8,000.00 for the purpose of including a hardened Civil Defense shelter within the proposed combination police and fire station building, and to authorize the Selectmen to apply for and accept reimbursement of such proportion thereof as may be available to the Town from the United States Government under the United States Civil Defense and Mobilization Act, or other Federal law.

11. To see if the Town will authorize the Selectmen to sell the present fire house building together with all the lands adjoining the same on the east side of Bridge Street in the Town, at such time and upon such terms as they shall determine to be in the best interest of the Town, and to execute a deed or deeds to the purchaser or purchasers of the same evidencing such sale or sales. (No expenditure item)

12. To see if the Town will vote to commit the balance of the Fire Department appropriation to a Capital Reserve Fund, such fund to be used for the purchase of a fire truck.

13. To see if the Town will vote to raise and appropriate the sum of \$750.00 for the purpose of assisting the Greater Salem Community Mental Health Association as permitted under New Hampshire Revised Statutes Annotated Chapter 126-B.

14. To see if the Town will vote to raise and appropriate the sum of \$2,015.00 for the purpose of purchasing a snow plow and wing assembly, or take any other action relative thereto. (Approved by Budget Committee)

15. To see if the Town will vote to accept, raise and appropriate the sum of \$1,650.00 for the purpose of graveling and tarring Greenwood Terrace, so-called, a distance of 2/10 of a mile. (approximately) (By petition)

16. To see if the Town will vote to authorize the Selectmen to appoint a Committee of five to investigate the possibility of establishing a Town Highway Department and to render a report on their findings at the next annual Town Meeting.

17. To transact any other business that may legally come before said meeting.

Given under our hands and seal, this twentieth day of February, in the year of our Lord nineteen hundred and sixty-eight.

ALBERT D. NOLIN  
JAMES P. EMERSON  
PETER E. MORIN  
Selectmen of Pelham, N. H.

A true copy of Warrant - Attest:

ALBERT D. NOLIN  
JAMES P. EMERSON  
PETER E. MORIN  
Selectmen of Pelham, N. H.



# BUDGET

## OF THE TOWN OF PELHAM, N. H.

Estimates of Revenue and Expenditures for the Ensuing Year January 1, 1968 to December 31, 1968 Compared with  
Estimated and Actual Revenue, Appropriations and Expenditures of the Previous Year  
January 1, 1967 to December 31, 1967

SOURCES OF REVENUE	Estimated Revenue Previous Year 1967	Actual Revenue Previous Year 1967	Estimated Revenue Ensuing Year 1968
From State:			
Interest and Dividends Tax	\$ 2,150.00	\$ 2,283.85	\$ 2,300.00
Savings Bank Tax	290.00	374.47	350.00
Reimbursement a/c State and Federal forest lands	20.00	-	22.44
Reimbursement a/c Head Tax	1,000.00	48.03	50.00
From Local Sources Except Taxes:			
Dog Licenses	800.00	843.00	850.00
Business Licenses, Permits and Filing Fees	475.00	599.00	600.00
Fines and Forfeits, Municipal Court	1,000.00	1,200.00	1,200.00
Rent of Town Hall and Other Buildings	100.00	131.00	100.00
Interest Received on Taxes and Deposits	1,500.00	1,842.72	1,800.00
Motor Vehicle Permit Fees	38,300.00	44,705.60	50,000.00
Fire-Police Building			70,000.00
From Local Taxes Other Than Property Taxes:			
Poll Taxes - Regular @ \$2	2,900.00	3,552.00	<u>3,500.00</u>
TOTAL REVENUES FROM ALL SOURCES EXCEPT PROPERTY TAXES			\$130,772.44

PURPOSES OF EXPENDITURES	Appropriations Previous Year 1967	Actual Expenditures Previous Year 1967	Estimated Expenditures Ensuing Year 1968
General Government:			
Town Officers' Salaries	\$ 3,100.00	\$ 3,100.00	\$ 3,800.00
Town Officers' Expenses	9,777.00	10,873.70	17,225.25
Election and Registration Expenses	594.94	642.32	870.00
Municipal and District Court Expenses	610.00	620.00	800.00
Expenses Town Hall and Other Town Bldgs.	2,515.00	2,069.16	1,645.00
Reappraisal of Property, Appraisal Assist.	800.00	719.86	-
Employees' Retirement and Social Security	2,442.00	2,292.00	2,500.00
Dog Officer	400.00	402.00	600.00
Protection of Persons and Property:			
Police Department	31,170.00	32,493.59	37,750.20
Fire Department	11,207.00	11,154.53	11,723.00
Moth Exterm. - Blister Rust & Care of Tree	200.00	0	200.00
Insurance	2,774.95	3,227.28	3,093.10
Planning and Zoning	375.00	200.56	200.00
Damage by Dogs	50.00	32.00	50.00
Damages and Legal Expenses	1,500.00	1,339.70	1,500.00
Civil Defense	500.00	336.32	700.00
Health:			
Health Department, Including Hospitals	75.00	75.00	100.00
Vital Statistics	125.00	116.00	125.00
Town Dump and Garbage Removal	2,000.00	2,000.00	2,000.00

Highways and Bridges:			
Resealing	10,000.00	9,649.47	13,000.00
Town Maintenance - Summer	15,000.00	14,834.21	15,000.00
Town Maintenance - Winter	22,000.00	26,862.76	22,000.00
Street Lighting	2,350.00	2,351.16	2,730.00
General Expenses of Highway Department	1,500.00	914.00	1,500.00
Town Road Aid	957.78	957.88	1,091.62
Snow Plow Special			2,015.00
Libraries	6,440.00	7,303.49	7,670.00
Public Welfare:			
Town Poor	4,500.00	1,590.30	1,600.00
Old Age Assistance	2,500.00	2,096.23	2,500.00
Mental Health Special			750.00
Patriotic Purposes:			
Memorial Day and Veterans' Associations	300.00	300.00	209.00
Aid to Soldiers and Their Families	50.00	0	50.00
Recreation:			
Recreation Commission	2,500.00	173.75	3,490.00
Parks and Playground, Incl. Band Concerts	150.00	0	150.00
Public Service Enterprises:			
Cemeteries	1,500.00	1,500.00	2,100.00
Civil Defense Shelter			8,000.00
Interest:			
On Temporary Loans	1,000.00	1,378.30	1,500.00
State Audit	500.00	512.27	550.00
Outlay for New Construction and Perm. Improv.			
Fire-Police Building			2,240.00
Highways and Bridges:			
New Construction	15,000.00	15,000.59	10,700.00
Town Hall Special	2,500.00	2,500.00	1,000.00
Road Signs	500.00	727.20	500.00
Planning - Land Options	1,500.00		
Reappraisal Special	8,000.00	8,000.00	8,000.00
Fire/Police Building			70,000.00
Payments on Principal of Debt:			
Capital Reserve - Fire/Police Building			20,000.00
Long Term Notes - Fire/Police Building			14,000.00
Payment to Capital Reserve Funds - Fire Dept.	2,000.00	2,000.00	<u>2,000.00</u>
TOTAL EXPENDITURES			\$299,227.17

## LIBRARY TRUSTEES' REPORT

Aluminum storm windows and screens were installed on all windows in the library, for the comfort of the users, to avoid expensive repairs to existing windows, and to reduce heating costs.

A written request was received from teachers and students of the elementary schools that the library be open on Saturday during the school year for the use of the students. It is planned, therefore, to have the library open on Saturdays from 10:00 A. M. to 12:00 noon. The open hours will then be as follows:

Monday through Thursday	7:00 to 9:00 P. M.
Monday and Wednesday	2:00 to 5:00 P. M.
Saturday	10:00 A. M. to 12:00 noon

Mrs. Irvn S. Parker has been appointed Librarian. She recently completed a ten week course in Library Techniques at the University of New Hampshire in Durham, following other studies which she has pursued during her years as assistant and acting Librarian.

On January 29, 1968, Miss Mary E. Hobbs died after a long illness. Miss Hobbs was the first librarian of the Town of Pelham, and served in that capacity from 1893, when the library was first organized, until her resignation in 1958. Her service of sixty-five years as librarian was one of real dedication to the library and the townspeople, with a particular interest in the children. The trustees and all friends of the library appreciate her lifelong and devoted service and interest, and hereby make permanent record.

PETER D. BLACK  
DOROTHY HARDY  
HELENA ZOLKOS  
Trustees

## PELHAM PUBLIC LIBRARY

Librarian's Report for Year Ending December 31, 1967

Library circulation for the year of 1967:

Town books	17,457
Bookmobile books	2,962
State Library special requests	281

A metal, four drawer file cabinet has been purchased and installed in the Memorial Room beside the fireplace. It is called a vertical or pamphlet file, and contains news clippings, dated and filed, of current scholastic interest, but too recent to be in book form. Free informative pamphlet material can also be filed.

We were recipients of a \$100.00 State aid grant for reference material.

I attended a weekly extension course last fall at the University of New Hampshire. The name of this course is Library Technique I. These courses lead to a trained librarian's certificate.

The Mother Goose Kindergarten made a class field trip to the library.

New book purchases are being posted on the bulletin board in the library.

Our library has materials regularly provided by the Girl Scouts, Grange League of Women Voters, our town representatives, and generous donations by private individuals. We have also accepted and shelved many paperback donations.

Three individuals are saving clippings of Pelham news from three daily papers, and an interested citizen mounts them in three separate scrapbooks giving us a current history of our town.

Magazines subscribed to: Natural History, Scientific American, Consumer's Guide, National Geographic, Science Digest, Changing Times, Saturday Evening Post, New Hampshire Profiles, Jack and Jill, Life, Today's Health, and Science Digest.

Magazines donated: U. S. News, Look, Prevention, Holiday, Travel, Reader's Digest, Hunting and Fishing, and Children's Life.

Magazines may be signed out under book rules.

Scarcely a day goes by but what new patrons are registered.

This is also our second year that we have been able to furnish our new patrons with our own much needed book marks, listing our present hours as Monday through Thursday nights 7 - 9, and Monday and Wednesday afternoons 2 - 5. The printer has also significantly inscribed on the book marks "Read More and Know More."

Respectfully submitted,

MRS. DORIS PARKER  
Librarian



## INDUSTRIAL COMMISSION REPORT

It is with anticipation that this report is filed for your review. It was the latter part of the year 1967 that this Commission was faced with reorganization.

The new Commission, just recently brought up to its full complement of five members, looks forward to the coming year with one major goal; to be an active Commission.

Attracting industry to our Community is very important to our future growth. With the proper approach, and application of a definite plan, some success may be realized.

Several members of our Commission have already initiated inquiries, on a State wide level, as to where we can expect assistance on the road situation. There is nothing to report, at this time, on any action by anyone concerned, on the requests that have been made.

In the near future, we hope to develop a questionnaire that will be sent to you, for your review and reply. We hope that your answers to our questions will be helpful to us in our future negotiations with prospective industrial clients, looking for a new location.

Your Industrial Commission,

MELVIN R. STRAWBRIDGE, Chairman

JAMES J. WHITE, Secretary

RUSSELL LEONARD

LEONARD PHILBRICK

ALBERT A. NOLIN, Selectman

---

## ANNUAL REPORT OF PELHAM RECREATION COMMISSION

The establishment of this committee within the structure of our town government has proven a most progressive step toward developing long-needed citizen recreation services. The members of this committee have faithfully served the taxing responsibilities associated with such a program. The following is a brief summary of activities and projects undertaken this past seven months.

A meeting was held in June with all community association leaders invited. The purpose was to assist our efforts toward a series of priorities in establishing a comprehensive community recreation program. Secondly, we wanted to receive community suggestions on the direction the commission should gear its efforts. Approximately 1,500 questionnaires were mailed to residents to evaluate their interests in this area. Research of town-owned land shared number one priority with the development of town bathing facilities. Through inquiries the commission was able to set aside 85 acres of town-owned land, and acquire a generous gift of 12 acres (from the William Landry family of Draçut). We are presently negotiating toward 3 town water recreation areas.

We met with the school district with the intention of coordinating programs and discussing a permanent town recreation site to the rear of the E. G. Sherburne School.

The committee has sponsored: Red Cross (swimming) water safety program at Harris' beach on White's Pond; the Ford Motor Co. Punt, Pass and Kick competition held in Nashua (5 Pelham boys achieved trophies); a ski school program was instituted at the Methuen Ski slope with 55 attending the courses; and an ice skating rink was formed in back of the E. G. Sherburne School. Appreciation is extended to the school district and the Fire Department for the use of land and flooding equipment. Expansion and the maintenance of our program is totally dependent upon the fiscal and physical determination of you - fellow citizens.

Committee members attended a Physical Education and Recreation Workshop in Concord, and arranged a communication linkage with State levels in the Recreation field. As the year 1967 comes to an end, we express our thanks to those people who have generously assisted our efforts. In 1968, we have planned an expansion of our recreational activities for both young and old.

Respectfully submitted,

JIM FENTON, Chairman

Pelham Recreation Commission

# REPORT OF THE TRUST FUNDS

Date of Creation	Name of Trust Fund (Purpose - Cemetery) (Common Trust A Inv.)	Original Investment	Income				
			Balance Beginning Year	Balance Beginning Year	Income During Year	Expended During Year	Balance End Year
8-15-47	Atwood, Daniel	\$ 100.00	\$ 216.07	\$ 9.49	\$ 10.12	\$ 9.49	\$ 10.12
5- 6-54	Atwood, Daniel P.	100.00	216.07	9.49	10.12	9.49	10.12
5- 6-54	Atwood, Gen'l Joshua	100.00	216.07	9.49	10.12	9.49	10.12
10- 7-43	Atwood, Jonathan M.	100.00	216.07	9.49	10.12	9.49	10.12
5- 1-97	Barker, Solomon	100.00	216.07	9.49	10.12	9.49	10.12
9-29-56	Barr, Ellen L.	200.00	432.15	18.98	20.22	18.98	20.22
3-14-49	Bassett, Franklin	200.00	432.15	18.98	20.22	18.98	20.22
8-13-48	Bassett, Fred	200.00	432.15	18.98	20.22	18.98	20.22
5-30-19	Batchelder, Adolph	50.00	108.04	4.74	5.08	4.74	5.08
8-10-10	Bayley, John	100.00	216.07	9.49	10.12	9.49	10.12
4-21-60	Beauchesne, Norbert	150.00	324.12	14.23	15.19	14.23	15.19
7-29-39	Berube, John	100.00	216.07	9.49	10.12	9.49	10.12
5-30-51	Bigelow, Berniece	150.00	324.12	14.23	15.19	14.23	15.19
5-20-42	Blodgett-Eastman	100.00	216.07	9.49	10.12	9.49	10.12
9- 9-00	Boardman, Calvin	50.00	108.04	4.74	5.08	4.74	5.08
9- 2-38	Brown, Hiram C.	100.00	216.07	9.49	10.12	9.49	10.12
12-10-26	Burns, Nancy J.	50.00	108.04	4.74	5.08	4.74	5.08
9- 1-59	Burt, Milton	200.00	432.15	18.98	20.22	18.98	20.22
4-15-25	Butler, Abbie F.	50.00	108.04	4.74	5.08	4.74	5.08
5-14-24	Butler, Dianne O.	100.00	216.07	9.49	10.12	9.49	10.12
7-31-56	Butler, Russell D.	200.00	432.15	18.98	20.22	18.98	20.22
5-25-39	Butler, William G.	100.00	216.07	9.49	10.12	9.49	10.12
6-25-12	Buttrick, Isaac	100.00	216.07	9.49	10.12	9.49	10.12
5-25-24	Carleton, Amelia	100.00	216.07	9.49	10.12	9.49	10.12
6- 6-38	Carter, Charles H.	100.00	216.07	9.49	10.12	9.49	10.12
4- 4-49	Christian, Samuel	100.00	216.07	9.49	10.12	9.49	10.12
8-31-28	Clarke, James W.	200.00	432.15	18.98	20.22	18.98	20.22
10-25-22	Cloyd, Amanda	100.00	216.07	9.49	10.12	9.49	10.12
7-23-18	Coburn, Capt. Gilbert	100.00	216.07	9.49	10.12	9.49	10.12
1-27-08	Coburn, Jephtha	100.00	216.07	9.49	10.12	9.49	10.12
6-25-22	Colburn, Charles W.	100.00	216.07	9.49	10.12	9.49	10.12
1-10-57	Colman, John N.	100.00	216.07	9.49	10.12	9.49	10.12
9- 5-46	Cundall, Annie Lyon	200.00	432.15	18.98	20.22	18.98	20.22
5- 6-54	Currier, Henry M.	100.00	216.07	9.49	10.12	9.49	10.12
5-3 -19	Cutter, Mrs. A. H.	100.00	216.07	9.49	10.12	9.49	10.12
10-25-22	Cutter, Charles H.	200.00	432.15	18.98	20.22	18.98	20.22
12- 4-25	Cutter, Fred A.	100.00	216.07	9.49	10.12	9.49	10.12
6- 1-37	Day, Birge C.	100.00	216.07	9.49	10.12	9.49	10.12
3-15-29	Doherty, John	100.00	216.07	9.49	10.12	9.49	10.12
6- 2-41	Dutton, Louella Hobbs	150.00	324.12	14.23	15.19	14.23	15.19
5-23-28	Foss-Coburn	200.00	432.15	18.98	20.22	18.98	20.22
6-30-56	Foster, James A.	200.00	432.15	18.98	20.22	18.98	20.22
6- 3-35	Fox, A. E. & C. W.	100.00	216.07	9.49	10.12	9.49	10.12
1-25-23	Fox, D. S. & R. S.	100.00	216.07	9.49	10.12	9.49	10.12
6- 5-29	Fox, Darius L.	100.00	216.07	9.49	10.12	9.49	10.12
1- 8-47	Fox, Franklin P.	300.00	648.22	28.48	30.31	28.48	30.31
6- 5-39	Fox, Harry M.	100.00	216.07	9.49	10.12	9.49	10.12
2- 5-53	Fox, Nellie L.	100.00	216.07	9.49	10.12	9.49	10.12



6- 3-57	Freeman-Wilbur	100.00	216.07	9.49	10.12	9.49	10.12
5- 7-97	Frost-Skinner	50.00	108.04	4.74	5.08	4.74	5.08
2-15-15	Gage, Albert S.	100.00	216.07	9.49	10.12	9.49	10.12
2-15-17	Gage, Arthur N.	150.00	324.12	14.23	15.19	14.23	15.19
12- 4-25	Gage, Daniel	100.00	216.07	9.49	10.12	9.49	10.12
12- 5-09	Gage, Daniel T.	47.50	102.63	4.51	4.81	4.51	4.81
10-15-12	Gage, Joseph	100.00	216.07	9.49	10.12	9.49	10.12
5-11-26	Gage, Joseph B.	100.00	216.07	9.49	10.12	9.49	10.12
4-15-25	Gage, Samuel K.	200.00	432.15	18.98	20.22	18.98	20.22
6- 3-35	Gemmell-Cheney	100.00	216.07	9.49	10.12	9.49	10.12
1- 4-15	Gibson-Mitchell	100.00	216.07	9.49	10.12	9.49	10.12
2-15-09	Gorrall, Edward W.	95.00	205.27	9.02	9.65	9.02	9.65
2-28-18	Gould, David M.	100.00	216.07	9.49	10.12	9.49	10.12
5- 8-49	Greeley, Arthur W.	100.00	216.07	9.49	10.12	9.49	10.12
4-21-53	Greeley, Fred W.	100.00	216.07	9.49	10.12	9.49	10.12
5- 3-08	Griffin Bros.	50.00	108.04	4.74	5.08	4.74	5.08
3- 1-18	Griffin, Mrs. James R.	100.00	216.07	9.49	10.12	9.49	10.12
9-28-45	Grondin, Jennie	150.00	324.12	14.23	15.19	14.23	15.19
1- 4-26	Hamblett, Charles A.	50.00	108.04	4.74	5.08	4.74	5.08
12- 8-47	Hardy, Charles M.	100.00	216.07	9.49	10.12	9.49	10.12
7-15-11	Harlow-Runnells	100.00	216.07	9.49	10.12	9.49	10.12
11-12-41	Harris, John D.	150.00	324.12	14.23	15.19	14.23	15.19
1- 3-18	Harris, Mrs. H. A.	100.00	216.07	9.49	10.12	9.49	10.12
5- 2-39	Hennessey, Laura	50.00	108.04	4.74	5.08	4.74	5.08
12-15-60	Herbert, Charles & Frances	100.00	216.07	9.49	10.12	9.49	10.12
10-27-36	Hillman, Richard B.	100.00	216.07	9.49	10.12	9.49	10.12
7-18-31	Hobbs-Dutton	100.00	216.07	9.49	10.12	9.49	10.12
4-15-27	Hobbs, James M.	100.00	216.07	9.49	10.12	9.49	10.12
6- 7-41	Hobbs, Sherman	200.00	432.15	18.98	20.22	18.98	20.22
4- 7-55	Horskin, Sanford & Anna	150.00	324.12	14.23	15.19	14.23	15.19
7-30-37	Hubleby-Seavey	100.00	216.07	9.49	10.12	9.49	10.12
9-21-41	Hyde-Proper	50.00	108.04	4.74	5.08	4.74	5.08
8-15-38	Jackman, Agnes M.	150.00	324.12	14.23	15.19	14.23	15.19
11- 2-38	Jackman, Noah	50.00	108.04	4.74	5.08	4.74	5.08
7- 1-98	Jackson, May J.	50.00	108.04	4.74	5.08	4.74	5.08
10-15-41	Johnson, Ida M.	150.00	324.12	14.23	15.19	14.23	15.19
11-26-37	Jones, Mabel H.	50.00	108.04	4.74	5.08	4.74	5.08
7- 8-31	Kelley, Samuel	100.00	216.07	9.49	10.12	9.49	10.12
9- 1-55	Kelley, Samuel	100.00	216.07	9.49	10.12	9.49	10.12
6- 8-44	Kent, Carrie E.	75.00	162.06	7.13	7.51	7.13	7.51
5- 3-19	Keyes, Mary J.	50.00	108.04	4.74	5.08	4.74	5.08
10- 5-44	Kittridge, Abner	50.00	108.04	4.74	5.08	4.74	5.08
8- 8-47	Lane, Frank H.	200.00	432.15	18.98	20.22	18.98	20.22
9-12-41	Lewis, Guy A.	100.00	216.07	9.49	10.12	9.49	10.12
10-25-32	Lovell, Charles H.	50.00	108.04	4.74	5.08	4.74	5.08
3-18-33	Lyons, Mary A.	150.00	324.12	14.23	15.19	14.23	15.19
4-15-24	Marsh, Ella Atwood	100.00	216.07	9.49	10.12	9.49	10.12
5-23-18	Marsh, Enoch M.	100.00	216.07	9.49	10.12	9.49	10.12
5- 6-33	Marsh, John H.	200.00	432.15	18.98	20.22	18.98	20.22
2- 5-09	Marsh, Matilda J.	100.00	216.07	9.49	10.12	9.49	10.12
7- 1-08	Marshall, Daniel	100.00	216.07	9.49	10.12	9.49	10.12
1-25-23	Marshall, Isaac	100.00	216.07	9.49	10.12	9.49	10.12
12- 3-59	McCann, Thomas A.	100.00	216.07	9.49	10.12	9.49	10.12
8-15-36	McClure, Mary E.	200.00	432.15	18.98	20.22	18.98	20.22
5-28-28	Merrill, Hannah J.	50.00	108.04	4.74	5.08	4.74	5.08

5- 1-26	Moore, Edith Johnson	100.00	216.07	9.49	10.12	9.49	10.12
8-15-24	Moore, Nathaniel	100.00	216.07	9.49	10.12	9.49	10.12
8-15-24	Moore, Orton	100.00	216.07	9.49	10.12	9.49	10.12
8-22-55	Muldoon, Clarence & George	200.00	432.15	18.98	20.22	18.98	20.22
1-20-43	Palmer, Samuel B.	100.00	216.07	9.49	10.12	9.49	10.12
2-15-17	Proctor, Sarah	100.00	216.07	9.49	10.12	9.49	10.12
5-28-59	Raymond, John & Marion	100.00	216.07	9.49	10.12	9.49	10.12
8-15-15	Richardson, B. F.	100.00	216.07	9.49	10.12	9.49	10.12
8-20-29	Richardson, Clarence W.	50.00	108.04	4.74	5.08	4.74	5.08
10-18-46	Richardson, Eli E.	150.00	324.12	14.23	15.19	14.23	15.19
9-22-44	Richardson, George E.	200.00	432.15	18.98	20.22	18.98	20.22
7-23-31	Richardson, Orlando	50.00	108.04	4.74	5.08	4.74	5.08
2- 6-30	Richardson, James	200.00	432.15	18.98	20.22	18.98	20.22
7-23-21	Richardson, Russell	50.00	108.04	4.74	5.08	4.74	5.08
6-23-21	Richardson, Hughes	100.00	216.07	9.49	10.12	9.49	10.12
10-31-38	Ross, M. Helen Foss	150.00	324.12	14.23	15.19	14.23	15.19
4- 1-46	Scott, Charles E.	150.00	324.12	14.23	15.19	14.23	15.19
4-15-30	Scruton, Mrs. G. L.	50.00	108.04	4.74	5.08	4.74	5.08
5- 3-49	Seaman, Elmer E.	100.00	216.07	9.49	10.12	9.49	10.12
8- 3-98	Seavey, Charles L.	100.00	216.07	9.49	10.12	9.49	10.12
2- 5-07	Shufelt, George A.	100.00	216.07	9.49	10.12	9.49	10.12
2-15-09	Shufelt, Mrs. George A.	500.00	1,080.76	47.46	50.50	47.46	50.50
5- 6-23	Simpson, Dwelley E.	100.00	216.07	9.49	10.12	9.49	10.12
5-28-18	Sleeper, Ida C.	50.00	108.04	4.74	5.08	4.74	5.08
8- 3-98	Spear, Betsey G.	150.00	324.12	14.23	15.19	14.23	15.19
6- 5-36	Spear, Charles W.	200.00	432.15	18.98	20.22	18.98	20.22
12-14-43	Spear, Edith N.	50.00	108.04	4.74	5.08	4.74	5.08
10-25-26	Stickney, Charles W.	100.00	216.07	9.49	10.12	9.49	10.12
11-10-10	Stickney-Spofford	200.00	432.15	18.98	20.22	18.98	20.22
8-15-38	Stowell, Alfred L.	100.00	216.07	9.49	10.12	9.49	10.12
9-15-12	Swan, Elizabeth W.	100.00	216.07	9.49	10.12	9.49	10.12
1-30-36	Tenney, Charles W.	100.00	216.07	9.49	10.12	9.49	10.12
7- 7-43	Titcomb, Isaac	100.00	216.07	9.49	10.12	9.49	10.12
7- 2-40	Titcomb, James O.	150.00	324.12	14.23	15.19	14.23	15.19
3-25-23	Titcomb, William M.	100.00	216.07	9.49	10.12	9.49	10.12
8-15-12	Tyler, Milton J.	100.00	216.07	9.49	10.12	9.49	10.12
8-15-12	Tyler, Joseph	100.00	216.07	9.49	10.12	9.49	10.12
6- 1-17	Watt, Lillie E.	100.00	216.07	9.49	10.12	9.49	10.12
6-15-36	Webster, Burt G.	100.00	216.07	9.49	10.12	9.49	10.12
4-15-30	Webster, Mark H.	100.00	216.07	9.49	10.12	9.49	10.12
1-14-15	Wheeler, Charles	100.00	216.07	9.49	10.12	9.49	10.12
9- 9-22	White, Mrs. Charles W.	50.00	108.04	4.74	5.08	4.74	5.08
1-17-22	Wilson, Jesse	100.00	216.07	9.49	10.12	9.49	10.12
5- 6-54	Woodbury-Emerson	100.00	216.07	9.49	10.12	9.49	10.12
6- 6-54	Woodbury-Melbern	200.00	432.15	18.98	20.22	18.98	20.22
8-10-28	Woodbury, Herman W.	100.00	216.07	9.49	10.12	9.49	10.12
2-15-15	Woodman, J. N.	100.00	216.07	9.49	10.12	9.49	10.12
5-13-13	Wyman-Taylor	100.00	216.07	9.49	10.12	9.49	10.12
5-23-19	Young, Edward	100.00	216.07	9.49	10.12	9.49	10.12
TOTALS		\$17,417.50	\$37,634.97	\$1,652.77	\$1,762.65	\$1,652.77	\$1,762.65



Date of Creation	Name of Trust Fund (Purpose - Cemetery) (Common Trust B Inv.)	Balance Beginning Year	Income			Balance End Year
			Balance Beginning Year	Income During Year	Expended During Year	
4-25-61	Atwood, Harry H.	\$ 200.00	\$ 9.17	\$ 9.94	\$ 9.17	\$ 9.94
3-19-63	Burrows, Edith	100.00	4.59	4.97	4.59	4.97
9- 9-65	Currier, Richard H.	100.00	4.59	4.97	4.59	4.97
4- 1-63	Dunn, Raymond & Jeanne	100.00	4.59	4.97	4.59	4.97
12- 1-63	Edwards, Harry L., Sr.	100.00	4.59	4.97	4.59	4.97
4-25-62	Garland, Frederick	200.00	9.17	9.94	9.17	9.94
11-21-61	Goddard, Charles G.	100.00	4.59	4.97	4.59	4.97
3- 4-63	Greenwood, Edward	100.00	4.59	4.97	4.59	4.97
3- 1-66	Harris, George W., Sr.	175.00	5.83	8.68	5.83	8.68
6-15-64	Healey, Philip H.	100.00	4.59	4.97	4.59	4.97
12-30-63	Herkemer, Gottfried & Saimi	100.00	4.59	4.97	4.59	4.97
9- 1-66	Hunt, Clifton E.	100.00	1.33	4.97	1.33	4.97
12-30-63	Jarosky, Adolph H.	100.00	4.59	4.97	4.59	4.97
3-23-65	Langworthy, Henry C.	100.00	4.59	4.97	4.59	4.97
2-25-63	Merrill, Paul R. & Bridget E.	200.00	9.17	9.94	9.17	9.94
11-23-63	Mills, Elizabeth	200.00	9.17	9.94	9.17	9.94
3-25-63	Nickerson, Lester E.	200.00	9.17	9.94	9.17	9.94
4-16-62	Paquette, Alpone	200.00	9.17	9.94	9.17	9.94
10-25-64	Quigley, John	150.00	6.88	7.44	6.88	7.44
10-24-63	Regan, John & Mildred	200.00	9.17	9.94	9.17	9.94
7- 2-63	Stott, Thomas & Gladys	100.00	4.59	4.97	4.59	4.97
6- 2-64	Sylvia, Warren	100.00	4.59	4.97	4.59	4.97
9- 1-63	Whitman, James M.	100.00	4.59	4.97	4.59	4.97
	TOTALS	\$3,125.00	\$137.90	\$155.28	\$137.90	\$155.28
	(Purpose - Library) (Common Trust Inv.)					
	Sherman Hobbs	\$ 5,000.00	\$199.66	\$237.83	\$199.66	\$237.83
	Frank Woodbury	5,000.00	199.66	237.82	199.66	237.82
	TOTALS	\$10,000.00	\$399.32	\$475.65	\$399.32	\$475.65

Date of Creation	Name of Trust Fund	How Invested	Balance Beginning Year	New Funds Created	Balance End Year	Income			Balance End Year
						Balance Beginning Year	Income During Year	Expended During Year	
10-17-43	Currier, Henry M.	Merrimack Farm	\$ 100.00	\$	\$ 100.00	\$	\$	\$	\$
9-16-57	Koehler-Cahill	Merch. Sav. Bk.	200.00		200.00	19.00	10.06	9.79	19.27
10- 2-53	Raymond, Elmer & Alice	Merch. Sav. Bk.	225.00		225.00	21.37	11.32	11.01	21.68
4-13-59	Capital Reserve Acct (Fire)								
	Town of Pelham	Sec. Nat'l Bk.	4,179.96	2,000.00	6,179.96		191.72		191.72
	Mary L. Gage Trust	Amosk. Sav. Bk.	1,000.00		1,000.00	11.87	48.76	48.44	12.19
	Charles L. Seavey Trust	Sec. Nat'l Bk.	1,000.00		1,000.00	-	40.62	40.62	-
	Capital Reserve Acct (Recreation)								
	Town of Pelham								
Total of Funds Not in Common Trust			\$6,704.96	\$2,000.00	\$8,704.96	\$52.24	\$302.48	\$109.87	\$244.86
No. of Shares or Other Units	Description of Investment	Balance Beginning Year	Gains or (Losses) From Sales	Balance End Year	Balance Beginning Year	Income During Year	Transferred to Int a/c	Balance End Year	
COMMON TRUST FUND A									
1,095	New England Fund	\$ 9,759.93	\$( 9.31)	\$ 9,750.62	\$	\$ 414.66	\$ 414.66	\$	
1,412	Puritan Fund	10,496.36	(10.04)	10,466.32		618.84	618.84		
960	Broad Street Investing	10,252.47	( 8.80)	10,243.67		438.55	438.55		
584	Whitehall Fund	7,055.45	( 9.00)	7,046.36		226.32	226.32		
	Nashua Trust Co. Savings a/c 68137 (Principal)	90.76	37.24	128.00		4.02	4.02		
	Nashua Trust Co. Savings a/c 67187 (Interest)				1,652.77	60.26	(1,702.39)		
Total Common Trust Fund A		\$37,634.97		\$37,634.97	\$1,652.77	\$1,762.65	1,652.77	\$1,762.65	
COMMON TRUST FUND B									
200	Puritan Fund	\$ 1,572.03	\$( 7.64)	\$ 1,564.39	\$	\$ 87.84	\$ 87.84	\$	
	Nashua Trust Co. Savings a/c 85327 (Principal)	1,552.97	7.64	1,560.61		62.79	62.79		
	Nashua Trust Co. Savings a/c 85582 (Interest)				137.90	4.65	(150.63)		
Total Common Trust Fund B		\$ 3,125.00		\$ 3,125.00	\$ 137.90	\$ 155.28	137.90	\$ 155.28	
LIBRARY COMMON TRUST									
1,027	Puritan Fund	\$ 9,983.71	\$( .76)	\$ 9,982.95	\$	\$ 449.91	\$ 449.91	\$	
	Nashua Trust Co. Savings a/c 88392 (Principal)	16.29	.76	17.05		.65	.65		
	Nashua Trust Co. Savings a/c 88122 (Interest)					25.09	(450.56)		
Total Library Common Trust		\$10,000.00		\$10,000.00	\$ 399.32	\$ 475.65	399.32	\$ 475.65	

Grand Total All Common Trust	\$50,759.97	\$50,759.97	\$2,189.99	\$2,393.58	\$2,189.99	\$2,393.58
Total of Funds not in Common Trust	6,704.96	8,704.96	52.24	302.48	109.87	244.86
Grand Total of All Trust Funds	\$57,464.93	\$59,464.93	\$2,242.23	\$2,696.06	\$2,299.86	\$2,638.44

This is to certify that the information contained in this report is complete and correct, to the best of our knowledge and belief.

February 12, 1968

MILES J. CARES  
JAMES P. EMERSON  
HERBERT S. CURRIER  
Trustees



# BIRTHS RECORDED IN THE TOWN OF PELHAM

YEAR ENDING DECEMBER 31, 1967

<u>Date</u>		<u>Place</u>	<u>Sex</u>	<u>Name of Child</u>	<u>Name of Father</u>	<u>Maiden Name of Mother</u>
Jan.	3	Lawrence, Mass.	F	Teri Janine	John D. Holmes	Patricia Capobianco
	3	Lawrence, Mass.	F	Toni Joanne	John D. Holmes	Patricia Capobianco
	6	Lowell, Mass.	M	James Robert	Paul V. Shaughnessy	Jane E. McLaughlin
	9	Lowell, Mass.	M	Michael Ellsworth	Harold E. Wright, Jr.	Claudette B. Drainville
	12	Nashua, N. H.	M	Timothy Jon	Thomas F. Gampel	Brenda J. Fieldstad
	19	Lowell, Mass.	M	Michael Francis	Donald W. Trainor	Beverly M. Maguire
	20	Nashua, N. H.	F	Darlene Ann	Daniel L. Nolin	Julia R. Makiej
	21	Lowell, Mass.	M	Gary William	Donald H. Brunelle	Diane M. Martineau
Feb.	1	Nashua, N. H.	M	Keith Allen	Gerard J. Danis	Nancy G. Ledoux
	5	Nashua, N. H.	M	Timothy	Albert Rohrbacher, Jr.	Dolores M. Haven
	7	Lowell, Mass.	F	Kara Ann	Robert W. Dickey	Donna M. Sullivan
	11	Lowell, Mass.	F	Debra Ann	Kenneth W. Bowles	Dorothy L. Monty
	11	Methuen, Mass.	M	Steven	Leo R. Lamontagne	Helen Wooldridge
	17	Lowell, Mass.	M	Stephen Philip	Norman F. Paquette	Ruth D. Ouellette
	20	Lowell, Mass.	F	Coleen Elizabeth	Thomas A. Spinney	Ellen Lescard
Mar.	5	Lowell, Mass.	F	Dawn Emily	Francis H. Carragher	Mary R. Quinn
	5	Lowell, Mass.	M	Keith Allen	Richard A. Noval	Janet D. LeLuca
	8	Lowell, Mass.	F	Sheri	Richard A. Foley	Sharon A. Prescott
	8	Lowell, Mass.	F	Diane Jacqueline	David A. Morse	Doreen F. Dunkerley
	16	Lawrence, Mass.	M	Theodore Leon	John V. Griggs	Geraldine B. Kruse
	19	Lowell, Mass.	M	Paul Francis	James W. Fitzgerald	Esther S. Walsh
	30	Lowell, Mass.	M	Matthew Francis	Edward F. Cheney	Madeline A. Reilly
Apr.	2	Lowell, Mass.	M	Roger Allen, Jr.	Roger A. Aubrey	Georgette I. Genereux
	2	Nashua, N. H.	F	Melissa Lynn	Thomas D. Felch	Cathleen A. Maiocchi
	4	Nashua, N. H.	F	Cheryl Dawn	Richard C. Burton	Barbara A. Spearel
	4	Nashua, N. H.	F	Paula Anne	Norman F. Coombs	Joyce A. Dallaire
	6	Lowell, Mass.	M	Ronald William, Jr.	Ronald W. Therriault	Iris Chiasson
	7	Methuen, Mass.	F	Paula Marie	Franklin D. Bedard	Marie M. Bergeron
	11	Lowell, Mass.	M	Chad Joseph	Alfred J. St. Onge	Harriet Vlahos
	14	Lowell, Mass.	F	Susan	Richard P. Mrozowski	Gloria J. Sylvester
	19	Lowell, Mass.	F	Donna Lee	Henry P. Goyette	Phyllis T. Roy
	22	Lowell, Mass.	M	Ronald Joseph, Jr.	Ronald J. Groulx	Therese M. Rondeau
	24	Lowell, Mass.	M	Thomas Ross	Robert W. Anderson	Claire L. LaRosee
	25	Nashua, N. H.	M	Gregory James	David G. Hopwood	Rosalie J. Lemire
	28	Lowell, Mass.	M	Paul George	Walter C. Surprenant	Charlotte E. Huber
	29	Nashua, N. H.	F	Sandra Lee	Paul A. LaFave	Barbara A. Watson
May	30	Lowell, Mass.	F	Gail Ann	Mario DeCarolis	Anne Sheehan
	5	Nashua, N. H.	F	Polly Ann	Edward G. Earle	Brenda L. McLaughlin
	11	Nashua, N. H.	M	Paul Scott	Russell P. Leonard	Elizabeth J. VanVliet
	12	Nashua, N. H.	F	Donna Lee	Robert A. Field	Corinne A. Scale
	12	Lawrence, Mass.	F	Belinda Ann	Adam Wolf	Marie E. Lutz
	15	Methuen, Mass.	F	Luree Georgine	Arthur C. Paradis	Muriel M. Bedard
	22	Nashua, N. H.	F	Karen Jean	Kenneth R. Fennell	Hilda J. Hirsch
	24	Lowell, Mass.	F	Lisa Ann	James F. Foley	Nancy A. Bonazoni
	30	Lowell, Mass.	F	Bernice Flore	Roland C. Brunelle	Julie C. Martineau
June	3	Lawrence, Mass.	F	Nancy Lynne	George E. Cronin	Theresa A. LaVecchia
	4	Lowell, Mass.	M	Raymond Edward	Raymond Laine	Ida M. Coolong
	5	Methuen, Mass.	F	Tammy Louise	Roger L. Crooker	Lorraine M. Mansur
	9	Lowell, Mass.	F	Donna Marie	Robert D. Louf	Rita L. Seamans
	9	Lawrence, Mass.	F	Kimberly Ann	John R. Spofford	Marilyn Barker



June	19	Lowell, Mass.	M	David Paul	Armand J. Groulx	Nancy Lajoie
	22	Lawrence, Mass.	F	Kelly Ann	Maurice J. Long	Virginia L. Tallant
	24	Lowell, Mass.	F	Laura Jean	Matthew J. Zsofka	Laraine C. Williams
July	25	Lowell, Mass.	F	Sheila Ann	Raymond L. Surprenant	Barbara McInnis
	3	Lowell, Mass.	F	Cheri Anne	Donald W. Landry	Theresa A. Beaudry
	6	Lowell, Mass.	F	Kim Frances	Francis T. McAndrew	Monique Leclercq
	7	Nashua, N. H.	F	Karen Ann	George H. Surprenant	Kathleen I. St. Amand
	11	Lowell, Mass.	F	Gail Dianne	Paul G. Apostolakes	Betty A. Anderson
	16	Lowell, Mass.	F	Sandra Ann	Joseph Gomes	Patricia Dozibrin
	18	Methuen, Mass.	F	Patricia Anne	Gerald G. Gravel	Ruth C. Carson
	20	Methuen, Mass.	M	Norman Arthur	Arthur N. Provencal	Ruth J. Gagne
	23	Lowell, Mass.	M	Timothy John	John M. Jozokos	Patricia J. Chandler
	25	Manchester, N. H.	M	Brian John	Donald R. Lovely	Carole E. Mansfield
Aug.	25	Methuen, Mass.	M	Kevin Michael	Harold C. Pike, Jr.	Priscilla Dodge
	1	Lowell, Mass.	F	Pamela	Herbert J. Little	Rena D. Chalifour
	15	Lowell, Mass.	M	Gregg Lee	Harry G. Nyman	Rita N. Gonsalves
	17	Lowell, Mass.	M	Raymond Joseph, Jr.	Raymond Robarge	Sandra J. Carter
	18	Lowell, Mass.	F	Dawn Melissa	Donald E. Crossley	Wendy C. Ayer
	18	Lowell, Mass.	F	Gina Maria	Vincent S. Licata	Geraldine F. Sweet
	18	Lowell, Mass.	M	David James	Clifton S. Porter	Shirley A. Vroom
	18	Nashua, N. H.	M	Bryan Michael	Gordon E. Schofield	Evelyn P. Bourdeau
	26	Lowell, Mass.	M	Dana Richard	Richard J. Hart	Jeannine Payette
Sept.	4	Lowell, Mass.	M	George Ashley	Roy S. Philbrick	Barbara A. Dunn
	7	Lowell, Mass.	F	Erinn E.	James F. Gaffney, Jr.	Geraldine Sousa
	7	Lowell, Mass.	M	Gerald Raymond	Gerald D. Wooldridge	Lorraine D. Benoit
	9	Lowell, Mass.	F	Tammy Lynn	Gerald G. Barchard, Jr.	Diane M. Hamel
	12	Methuen, Mass.	M	Joseph Phillip, Jr.	Joseph Belanger	Nancy Donahue
	12	Lowell, Mass.	M	Scott David	Ronald D. Drew	Barbara A. Wade
	17	Methuen, Mass.	F	Sharon Lee	William McCarthy	Marie L. Mastin
	22	Lowell, Mass.	F	Kelly Lynn	Robert R. Marsden	Dorothy A. Donnelly
Oct.	2	Lowell, Mass.	F	Karen Lee	Charles E. Reed	Marsha L. Southworth
	3	Lowell, Mass.	M	Brian Joseph	George R. Souza	Janet I. Collings
	12	Lowell, Mass.	F	Kimberly Elizabeth	Robert E. Hayes	Diane F. DeCarteret
	14	Methuen, Mass.	F	Lisa Marie	Frederick J. Privitera	Sandra M. Wheeler
	16	Nashua, N. H.	M	Douglas William, Jr.	Douglas W. Nelson	Judith A. Cizek
	21	Lowell, Mass.	M	David John	Robert L. Berube	Mildred MacInnis
	23	Lowell, Mass.	M	Stephen John	John J. Quinn, Jr.	Johanne A. Townsend
	25	Methuen, Mass.	M	Brian Peter	Roger A. Mailhot	Phyllis A. Hassey
	30	Methuen, Mass.	F	Christine Anne	John J. Formichelli	Arlene R. Pinard
Nov.	5	Lowell, Mass.	F	Paula Lee	Robert H. Pellerin	Janine L. Paradis
	10	Lawrence, Mass.	F	Kristin Marie	Gerald N. Audet	Patricia A. Alexander
	16	Lowell, Mass.	F	Audrey Marie	Carl M. Patenaude	June P. Demers
	24	Lowell, Mass.	F	Dawn Aleece	Donald A. Vance	Eleanor M. Connors
	28	Lowell, Mass.	M	Anthony Patrick	Henry J. Brown	Rosemarie Maffeo
Dec.	2	Lowell, Mass.	F	Margaret Ann	Joseph B. Novello	Margaret L. Minko
	4	Lowell, Mass.	F	Yvette Marie	Paul E. Martineau	Judith J. Helm
	4	Lowell, Mass.	F	Joyce Sylvia	Fernand L. Parent	Joyce M. D'Ambroise
	7	Nashua, N. H.	M	David Joseph	Albert T. Barton	Marilyn A. Sturtevant
	9	Nashua, N. H.	M	Daniel Allen	Ralph L. Gillis	Linda Fairbanks
	13	Lowell, Mass.	M	Robert Stanley, II	Robert S. Jozokos	Carolyn L. Perron
	15	Nashua, N. H.	F	Michelle Marie	Robert E. Talbot	Joan C. Gendron
	16	Lawrence, Mass.	M	Michael John	John G. A. Comeau	Olivia T. Costa
	24	Lawrence, Mass.	F	Renee Jean	Albert R. Cote	Kathryn E. Petteruto

# MARRIAGES RECORDED IN THE TOWN OF PELHAM

YEAR ENDING DECEMBER 31, 1967

<u>Date</u>	<u>Name of Groom and Bride</u>	<u>Age</u>	<u>Residence</u>
Jan.	3 Kenneth John Camara	25	Lowell, Mass.
	Roberta Lorraine Zorba	26	Tewksbury, Mass.
14	Leo O. LaFlamme	21	Lawrence, Mass.
	Nancy R. Matthes	19	Methuen, Mass.
14	Robert P. Searles	20	Pelham, N. H.
	Amy E. Cleveland	17	Hudson, N. H.
20	Richard Anthony Cappello	20	Newton Highlands, Mass.
	Catherine Priscilla Snow	19	Newtonville, Mass.
21	Roger J. Dion	19	Hudson, N. H.
	Jeannette M. Surprenant	18	Pelham, N. H.
21	Robert L. O'Leary	26	Somerville, Mass.
	Brenda C. Brogna	21	Somerville, Mass.
23	Marc S. Wiseman	21	Holbrook, Mass.
	Charlene M. Garnett	18	Rockland, Mass.
25	Peter J. Logan	30	Oxford, Mass.
	Esther Simmons	33	Lynn, Mass.
27	Steven James Clukey	20	Pelham, N. H.
	Susan Jane Murray	18	Derry, N. H.
Feb.	4 Richard DeAngelis	20	Winthrop, Mass.
	Geraldine Helen Murphy	18	Winthrop, Mass.
25	Conrad Albert Petrain	24	Nashua, N. H.
	Donna Marie Snay	19	Pelham, N. H.
Mar.	4 Albert Henry Malek	18	Lawrence, Mass.
	Diane Rosemary Cormier	18	Pelham, N. H.
11	Frank J. Carlevale	20	Boston, Mass.
	Jean MacDonald	21	Chelsea, Mass.
15	Elmer Kenneth Fairbanks	60	Pelham, N. H.
	Avis Estelle Fairbanks	46	Pelham, N. H.
18	Edward A. LaCourse	44	Lowell, Mass.
	Mary A. Parrington	38	Lowell, Mass.
28	Matthew M. Suprin	39	Lowell, Mass.
	Mary G. Cloutier	38	Lowell, Mass.
Apr.	1 Roderick O. Bulmer	23	Pelham, N. H.
	Paulette J. Morin	20	Dracut, Mass.
1	Anthony J. Piermatteo	17	Burlington, Mass.
	Maureen D. Fortier	19	Pelham, N. H.
1	Thomas Francis Staniec	20	Pelham, N. H.
	Betty Ann Becker	18	Derry, N. H.
15	Peter O. McFadden, Jr.	23	Lowell, Mass.
	Anne Marie Jeannette Fauvel	20	Pelham, N. H.
22	David R. Boland	17	Pelham, N. H.
	Marie F. Dow	18	Hudson, N. H.
23	Russell Hendrick Linstad	23	Chelmsford, Mass.
	Marjorie Joyce Beliveau	23	Chelmsford, Mass.
May	6 Thomas Russell Bemish	24	Dracut, Mass.
	Lillian Gertrude Marchand	30	Pelham, N. H.
6	Frank J. Myers	36	No. Chelmsford, Mass.
	Theresa P. Myers	36	No. Chelmsford, Mass.
9	Thomas Irving Berlied	24	Acton, Mass.
	Mary Theresa Gillis	22	New Waterford, Canada

May	12	Ernest L. Dyer	45	Cambridge, Mass.
		Mary Genevieve Jackson	45	Cambridge, Mass.
	13	Richard Shattuck Blake, Jr.	20	Salem, N. H.
June		Jean Ellen Bauer	18	Pelham, N. H.
	13	Normand Richard Lemieux	27	Lawrence, Mass.
		Jeannette Marie Lemieux	25	Pelham, N. H.
	3	Rocco Frank Carter	30	Lowell, Mass.
		Linda Jane Ouellet	18	Lowell, Mass.
	3	Francis Philip O'Meara	27	Groveland, Mass.
		Janet Deborah Urbielonis	24	Pelham, N. H.
	4	Bartlett M. Hutchinson	28	Pelham, N. H.
		Priscilla G. Thomson	24	Hudson, N. H.
	9	George Alexander Wing	31	Lowell, Mass.
		Nora Theresa Wright	28	Lowell, Mass.
	16	Wallace Philip Ouellette	28	Lawrence, Mass.
		Carmela Yvonne Dube	22	Lawrence, Mass.
	17	William Orvard Villemaire	62	West Roxbury, Mass.
		Agnes Gertrude Moore	58	Cambridge, Mass.
July	23	Eugene Roland Soulard	42	Lowell, Mass.
		Eileen Ann McInerney	27	Lowell, Mass.
	30	Paul Robert Sirois	25	Lawrence, Mass.
		Merle Allene Currier	21	North Andover, Mass.
	1	Edward Peter Teczar	24	Worcester, Mass.
		Cynthia Frances Zolkos	23	Pelham, N. H.
	3	Joseph Edward Briere	43	Lowell, Mass.
		Pauline Laura Belanger	50	Lowell, Mass.
	8	George Perry Ponte	61	New Bedford, Mass.
		Jean Mance	49	Boston, Mass.
	22	Frank Warren Atwood, Jr.	23	Pelham, N. H.
		Freida Pearl Garland	22	Pelham, N. H.
	22	Hayward Faye	20	Picayune, Miss.
		Karen Amelia Maraganis	18	Dracut, Mass.
	22	William Charles Rizzo	20	Sayville, New York
		Linda Marie Roberts	18	Pelham, N. H.
	Aug. 19	John Daniel Bennett	22	Newport, N. H.
		Carol Ann Mooney	21	Pelham, N. H.
	19	Raymond Arnold Towse, Jr.	29	Wakefield, Mass.
		Barbara Ann Berthel	29	Pelham, N. H.
Aug.	21	Lloyd Taylor Carlson, Jr.	20	Federal Dam, Minn.
		Dorothy Eleanor Burrell	18	Middleboro, Mass.
	26	Richard Joseph Dowling	21	Pelham, N. H.
		Linda Joyce Lentz	19	Pelham, N. H.
	26	Raymond Theodore Montminy	27	Lowell, Mass.
		Kathryn Louise Graffice	30	Lowell, Mass.
	27	Richard Samuel Akkasian	25	Lowell, Mass.
		Diane Quinn	20	Pelham, N. H.
	Sept. 1	Oscar Douglas Allen	23	Lowell, Mass.
		Linda Grace Abrams	19	Lowell, Mass.
	1	Andrew Louis Mailloux	55	Pelham, N. H.
		Margaret Elaine Zins	57	Windham, N. H.
Sept.	9	Roland Maurice Houle	22	Nashua, N. H.
		Judith Nancy Thibeault	19	Pelham, N. H.
	9	Ronald A. Strout	23	Pelham, N. H.
		Jeanne Benoit	20	Dracut, Mass.



Sept.	11	Alphonse John Varoski, Jr.	21	Lowell, Mass.
		Judith Anne Messia	18	Lowell, Mass.
	22	Everett Arthur Yeaton	35	Hallowell, Maine
		Marjorie Jean Moses	19	Pelham, N. H.
	30	Gary Frank Post	23	Nashua, N. H.
		Jacqueline Dolores Wagner	21	Pelham, N. H.
Oct.	7	Gerald Edward Tessier	21	Pelham, N. H.
		Laurel Virginia Andem	18	Pelham, N. H.
	14	Leon Joseph Kubiak, Jr.	24	Pawtucket, R. I.
		Karen Ann Tower	22	Pelham, N. H.
	15	John Salvatore Giaquinta	43	Quincy, Mass.
		Joanne Therese Murphy	28	North Abington, Mass.
	21	Ronald Chester Hammond, Jr.	25	Warwick, R. I.
		Sandra Ann Cabral	24	Warwick, R. I.
	21	Herbert Francis Jones	23	Lawrence, Mass.
		Claire Frances Guay	21	Pelham, N. H.
	21	Joseph Michael McGarry	19	Lowell, Mass.
		Marguerite Helen Tanguay	18	Pelham, N. H.
	28	Louis J. R. Bellerose	37	Lowell, Mass.
		Rita Marie Therrien	36	Tyngsboro, Mass.
Nov.	4	Monty Cockerline	21	Westford, Mass.
		Donna Marie Pavelka	18	Pelham, N. H.
	11	Gerard Theodore Bergeron	26	Pelham, N. H.
		Pauline Denise Marley	26	Nashua, N. H.
	25	John William Maiocchi	23	Pelham, N. H.
		Susan Priscilla Zelonis	21	Pelham, N. H.
Dec.	1	Charles Walter Therriault	23	Pelham, N. H.
		Linda Louise Stevens	20	Pelham, N. H.
	8	Arthur Melville Agnew, Jr.	52	Littleton, Mass.
		Edith Wahn Noel	48	Weston, Mass.
	21	Edward James Driscoll	20	Pelham, N. H.
		Donna Marie Hopkins	18	Lowell, Mass.
	21	John Ramsay Friedman	41	Newton, Mass.
		Judith Andrews Cincotta	39	West Newton, Mass.



# DEATHS RECORDED IN THE TOWN OF PELHAM

YEAR ENDING DECEMBER 31, 1967

<u>Date of Death</u>	<u>Name of Deceased</u>	<u>Age</u>	<u>Place of Death</u>
Jan. 13	Roland E. Turnblom	59	Lawrence, Mass.
18	Marie Sabina Sylvia	89	Pelham, N. H.
21	Richard M. Stormont	57	Methuen, Mass.
Feb. 9	George Lund Bishop	94	Lawrence, Mass.
19	Victoria C. Landry	89	Pelham, N. H.
Mar. 4	Thomas R. Ackerman	78	Concord, N. H.
Apr. 5	Alice B. Alarie	50	Nashua, N. H.
14	Donald R. Germain	24	Pelham, N. H.
23	Pauline Kennedy Smith	69	Nashua, N. H.
26	Herbert E. Hopkinson	77	Lowell, Mass.
28	Hugh V. Tallant	72	Lawrence, Mass.
May 8	Theodore Sprissler	83	Nashua, N. H.
10	Alfred Leblanc	89	Lowell, Mass.
27	Deborah Bourque	6	Boston, Mass.
29	Hope Nickerson	69	Medford, Mass.
June 2	Turre F. Pennaman	63	Goffstown, N. H.
22	Richard W. Ivers	50	Lowell, Mass.
28	Grace V. Desmarais	66	Lowell, Mass.
July 9	Laura L. Patenaude	84	Goffstown, N. H.
27	Daniel J. Stankiewicz	34	Pelham, N. H.
28	William Reissman	80	Goffstown, N. H.
29	Edward LeBlanc	71	Wilmington, Mass.
Aug. 15	Alma Titcomb	78	Lawrence, Mass.
Oct. 13	Martha Maria Freitag	89	Pelham, N. H.
23	Raymond Elsworth Davis	64	Pelham, N. H.
24	Roseanna Lemieux	72	Lawrence, Mass.
Nov. 1	Robert P. Queen	50	Lowell, Mass.
2	Cora L. Ducharme	86	Nashua, N. H.
21	Murray Hawley Stewart	63	Bedford, Mass.
23	Archille Jean	73	Methuen, Mass.
Dec. 3	Edward Earle Goodwin	75	Nashua, N. H.
19	Anna Wood	64	Lowell, Mass.
22	Bryan Michael Schofield	4 mos.	Lowell, Mass.
28	Randall Herbert Richardson	46	Nashua, N. H.

## BODIES BROUGHT IN FOR BURIAL IN THE TOWN OF PELHAM YEAR ENDING DEC. 31, 1967

<u>Date of Death</u>	<u>Name of Deceased</u>	<u>Age</u>	<u>From</u>
Jan. 2	Raymond Omer Mercier	69	Meredith, N. H.
22	John Raymond Donnelly	53	Dracut, Mass.
Feb. 10	Ann Cynthia Wood	36	Brighton, Mass.
Mar. 15	Earl McCann	52	Dracut, Mass.
Apr. 20	Albert Newton Wakefield	60	Port Chester, N. Y.
May 18	Kimberly Champagne	Stillbirth	Nashua, N. H.
25	John Michael McDonald	16	Chelmsford, Mass.
26	Alta (Simpson) Mansfield	60	Windham, N. H.
1957	Irene Constantineau	58	Graniteville, Mass.
July 1	Joseph H. Constantineau	64	Graniteville, Mass.
12	Rolande Allard	61	Londonderry, N. H.
Aug. 10	Frank Boncar	65	Detroit, Mich.
Nov. 27	Clifford Dupuis	77	Dracut, Mass.
Dec. 28	William H. Henderson	68	Portsmouth, N. H.



# ANNUAL REPORTS

*of the*

SCHOOL BOARD, TREASURER, AUDITORS, BUDGET  
COMMITTEE, SUPERINTENDENT AND DEPARTMENT HEADS

*of the*

SCHOOL DISTRICT OF PELHAM, N. H.

*for the*

Year Ending June 30, 1967

---

## DISTRICT OFFICERS

---

MODERATOR . . . . . Alton M. Hodgman

CLERK . . . . . Dorothy Hill

### SCHOOL BOARD

John W. Woodbury, 1968, Chairman  
Donald E. Brock, 1969  
Frederick A. Houle, 1970, Clerk

TREASURER . . . . . Dorothy Hill

AUDITORS . . . . . State Auditors

SUPERINTENDENT OF SCHOOLS . . . . . Claude H. Leavitt

ASSISTANT SUPERINTENDENT . . . . . Peter G. Dolloff

PRINCIPAL . . . . . Moses Brown

## RECORD OF THE ANNUAL SCHOOL DISTRICT MEETING MARCH 29, 1967

The annual meeting of the Pelham School District was called to order by Moderator Alton M. Hodgman at 1 P.M. The polls were declared open until 9 P.M. with action on Article 2 through 8 to begin at 8 P.M.

Moderator Hodgman called business meeting to order at 8 P.M. School Board Chairman C. Michael McLlarky introduced Supt. of Schools Claude Leavitt, Asst. Supt. Peter Dolloff and School Counsel Edward P. McDuffee and requested permission that they be allowed to sit in on the meeting. Hearing no objection, permission was granted.

A motion was made and seconded that the total sum of the recommended 1967-68 budget, \$654,501.10 be approved. The motion was then amended to read that the recommended school board figure of \$660,488.48 be approved. Both were defeated by a standing vote and Articles 2 and 5 were taken up item by item by Randall H. Richardson, chairman of the budget committee as follows:

Administration	
Salaries	\$ 1,215.00
Contracted Services	606.00
Other Expenses	305.00
Instruction	
Salaries	203,310.00
Textbooks	4,972.00
Library & Audiovisual Materials	2,372.00
Teaching Supplies	4,945.00
Other Expenses	635.00
Attendance Services	50.00
Health Services	5,525.00
Pupil Transportation	58,771.00
Operation of Plant	
Salaries	16,500.00
Supplies	4,500.00
Contracted Services	135.00
Heat	5,600.00
Utilities	6,300.00
Other Expenses	40.00
Maintenance of Plant	8,000.00
Fixed Charges	
Employee Retirement & FICA	18,484.79
Insurance	3,200.00
School Lunch & Spec. Milk Program	11,080.00
Student Body Activities	775.00
Capital Outlay	4,000.00
Equipment	
Debt Service	
Principal of Debt	70,000.00
Interest on Debt	26,240.00
Outgoing Transfer Accounts	
In State - Tuition	176,700.00
Supervisory Union Expenses	9,390.31
Outgoing Transfer Accounts	
Out of State - Tuition	1,050.00
Expenditures to other than Public	
Schools	4,800.00
ESEA 89:10 Title I	5,000.00
Total	\$654,501.10

A motion was made, supported and passed in the affirmative to accept total appropriation of \$654,501.10.



The Moderator declared polls closed at 9 P. M.

Under Item 4 of the budget which was Salaries, a motion was made and seconded to accept budget committee figure of \$203,310.00. It was then amended to read that the school board recommended figure of \$206,110.00 be accepted. The salary of the principal and the physical education teacher was discussed along with the need for a guidance counselor by Supt. Leavitt and Mr. McLlarky. On a standing vote, the figure of \$203,310.00 was accepted and the amendment figure of \$206,110.00 was defeated - 48 for - 52 against.

Article 3 was taken up and Board Chairman McLlarky announced that the owner of the land on which the Memorial School was constructed was awarded a court finding of \$40,000 for the land and an additional approximate \$4,000 for court costs and interest payments.

The following resolution was made, seconded and passed in the affirmative:

Resolved - that the sense of this meeting encourage the school board to request the budget committee to overexpend the 1966-67 School District Budget for the purpose of paying the court award of eminent domain proceedings and pertinent costs.

Under Article 6, the School Board was authorized by the vote of the meeting to make application for grants and funds that may be forthcoming from state or federal governments.

Article 7 was passed in the affirmative.

Under Article 8, James Powers, chairman of the steering committee for construction of a new high school, reported on progress being made by the group.

Albert J. Maki, chairman of the student transportation committee, also reported on the findings and progress of his committee.

A motion was made and supported in the affirmative to adjourn the meeting at 10:55 P.M.

Moderator Hodgman declared the state of the ballots as follows: School Board member for 3 years - Frederick Houle - 139 (elected); Moderator for 1 year - Alton M. Hodgman - 145 (elected); Treasurer for one year - Dorothy Hill - 143; clerk for one year - Dorothy Hill - 142 (elected).

Oath of office given to Moderator Alton Hodgman, School Board member Frederick Houle and treasurer and clerk, Dorothy Hill by Clerk Dorothy Hardy. Used and unused ballots sealed and certified by Moderator Hodgman.

DOROTHY A. HARDY  
Clerk

# SCHOOL WARRANT

## THE STATE OF NEW HAMPSHIRE

To the inhabitants of the School District in the town of Pelham qualified to vote in district affairs:

You are hereby notified to meet at the Ernest G. Sherburne School Auditorium in said district on the 27th day of March, 1968, at one o'clock in the afternoon, to act upon Article I (Note: Polls for the election of School District Officers will open at 1 P.M. and will close not sooner than 9 P.M.) Action on remaining Articles will begin at 8 P.M.

1. To choose all necessary School District Officers:

- A. To choose a Moderator for the coming year.
- B. To choose a Clerk for the ensuing year.
- C. To choose a Member of the School Board for the ensuing three years.
- D. To choose a Treasurer for the ensuing year.

2. To determine and appoint the salaries of the School Board and Truant Officer, and fix the compensation of any other Officers or Agents of the district.

3. To hear the reports of Agents, Auditors, Committees or Officers chosen, and pass any vote relating thereto.

4. To choose Agents, Auditors, and Committees in relation to any subject embraced in this Warrant.

5. To see what sum of money the District will vote to raise and appropriate for the support of schools, for the payment of salaries for the school district and agents and for the payment of the statutory obligations of the district, that is, to see if the School District will vote to accept the School District Budget as prepared by the Budget Committee or to take any other action thereon.

6. To see if the District will vote to authorize the design, and construction of an addition to the Memorial School and to appropriate a sum not to exceed \$500,000.00 for the aforesaid purpose; said sum to be in addition to any local, state or federal funds made available therefor; and to raise the same by the issuance of bonds or serial notes in accordance with the provisions of the Municipal Finance Act, Chapter 33, of the Revised Statutes Annotated of New Hampshire, as amended, and to authorize the Pelham School Board to so issue and negotiate said bonds or notes in the name of or on the credit of the District, said board to have discretionary powers described in Section 8 of said Chapter 33 in respect to said notes or bonds.

7. To see if the District will authorize the School Board to make application for and to receive in the name of the district such advances, grants-in-aid or other funds for educational purposes as may now or hereafter be forthcoming from the United States Government, the State of New Hampshire or any other federal or state agency.

8. To see if the District will create a school planning and study committee and to authorize the school board to appoint such committee.

9. By Petition of - Thelma Boutwell, Diane Blais, Carole A. Chesbrough, and others: To see if the school district will vote to relinquish authority of 4-6 acres of its property to the rear of the E. G. Sherburne (school) to the town of Pelham for recreational purposes, or take Action relative thereto.

10. By Petition of - Thelma Boutwell, Diane Blais, Ethel Rondeau, and others: To see if the school district will vote to convene all future annual district meetings on the second Tuesday after the First Monday of March Concurrent with the Annual Town meeting. Or take action relative thereto.

11. To transact any other business that may legally come before this meeting.

Given under our hands at said Pelham this 15th day of February, 1968.

JOHN W. WOODBURY  
DONALD BROCK  
FREDERICK HOULE  
School Board

A true copy of Warrant - Attest

JOHN W. WOODBURY  
DONALD BROCK  
FREDERICK HOULE  
School Board

# BUDGET OF THE SCHOOL DISTRICT OF PELHAM, NEW HAMPSHIRE

1968-69

PURPOSE OF APPROPRIATION	School Board's	
	Budget 1968-69	Recommended 1968-69
Administration		
Salaries	\$ 1,215.00	\$ 1,215.00
Contracted Services	631.00	631.00
Other Expenses	505.00	505.00
Instruction		
Salaries	257,040.00	251,840.00
Textbooks	5,437.00	5,437.00
Library & Audiovisual Materials	2,606.00	2,606.00
Teaching Supplies	7,621.00	6,921.00
Contracted Services	-	-
Other Expenses	966.00	966.00
Attendance Services	50.00	50.00
Health Services	5,725.00	5,725.00
Pupil Transportation	59,095.00	59,095.00
Operation of Plant		
Salaries	17,300.00	17,300.00
Supplies	3,940.00	3,940.00
Contracted Services	135.00	135.00
Heat	6,600.00	6,600.00
Utilities	7,500.00	7,500.00
Other Expenses	40.00	40.00
Maintenance of Plant	3,982.00	3,982.00
Fixed Charges		
Employee Retirement & F. I. C. A.	22,523.00	22,130.00
Insurance	5,672.00	5,672.00
School Lunch & Spec. Milk Program	10,790.00	10,790.00
Student-Body Activities	1,075.00	1,075.00
Capital Outlay		
Sites	4,500.00	4,500.00
Buildings	501,325.00	501,325.00
Equipment	2,418.00	2,418.00
Debt Service		
Principal of Debt	98,000.00	98,000.00
Interest on Debt	42,272.50	42,272.50
Outgoing Transfer Accounts in State		
Tuition	201,292.00	201,292.00
Transportation	-	-
Supervisory Union Expenses	10,179.00	10,179.00
Payments into Cap. Res. Funds	-	-
Other Expenses	-	-
Outgoing Transfer Acc'ts. out of State		
Tuition	1,000.00	1,000.00
Other Expenses	4,800.00	4,800.00
Summer School		
PL 89:10	5,000.00	5,000.00
TOTAL APPROPRIATIONS	\$1,291,234.50	\$1,284,941.50



REVENUES & CREDITS AVAILABLE TO REDUCE SCHOOL TAXES	School Board's Budget 1968-69	Budget Committee 1968-69
UNENCUMBERED BALANCE	\$ 20,000.00	\$ 20,000.00
Revenue from State Sources:		
Sweepstakes	6,000.00	6,000.00
Foundation Aid	29,888.73	29,888.73
School Building Aid	22,050.00	22,050.00
Revenue from Federal Sources:		
NDEA-Title III-Science, Math & Lang.	200.00	200.00
Sch. Lunch & Special Milk Program	4,000.00	4,000.00
PL 89-10 (ESEA)	5,000.00	5,000.00
Local Revenue Except Taxes:		
Rent	100.00	100.00
Other Revenue from Local Sources	5.00	5.00
Bonds-Notes & Capital Res. Funds:		
Bond or Note Issues	<u>500,000.00</u>	<u>500,000.00</u>
TOTAL REVENUES and CREDITS	\$ 587,243.73	\$ 587,243.73
DISTRICT ASSESSMENT TO BE RAISED BY PROPERTY TAXES	<u>703,990.77</u>	<u>697,697.77</u>
TOTAL APPROPRIATIONS	\$1,291,234.50	\$1,284,941.50

Budget Committee:

February 14, 1968

PETER E. MORIN  
JAMES GREENWOOD  
DONALD E. BROCK  
JAMES E. POWERS  
DANIEL S. ATWOOD, JR.

FREDERICK W. GARLAND  
ARTHUR G. EGERTON  
DONALD E. BURTON  
RICHARD C. MANSFIELD  
BERNARD T. ROCK

PELHAM SCHOOL DISTRICT

MEMORIAL SCHOOL BUILDING FUND

July 1, 1966 to June 30, 1967

REVENUE

Cash on Hand July 1, 1966	\$142,038.28
Interest	1,817.14
NDEA	2,081.61
Pelham Lions Club	50.00
Refunds	<u>253.09</u>

Total Revenue \$146,240.12

EXPENDITURES

Site Purchase	\$ 6,986.34
General Contract	50,864.67

Site Development

Paving Plans - A. T. Johnson	\$ 4.35	
Stone for Sidewalks - N. E. Cement Block	31.00	
Grading - Neal Balcom	6,117.25	
Paving - Essex Bituminous	7,916.00	
Soil Testing - Briggs Engineering	96.50	
Drawing - Barr Engineering	19.53	
Fertilizer - Corenco Corp.	382.36	
Grass Seed - Asgrow	663.90	
Landscaping - Still's Nursery	821.00	
Garden Bark - Consolidated Rendering	72.00	
Fertilizer - A. Zolkos	<u>248.00</u>	
		16,371.89

Architectural Services

326.16

Legal Fees

242.25

Administrative

Plaques - Nashua Brass	\$ 588.00
Open House and Dedication	490.50
Other	<u>608.00</u>

1,686.50

Furniture and Equipment

Kitchenette - Fay Construction	\$ 380.00
Lecterns - DuQuaine	334.90
Science Equipment - Cambosco	2,990.77
Doors for Workbench - Corey Steeplejacks	30.00
Dispensers - Manchester Paper Supply	82.40
Flags - Milton Bradley	180.24
Pencil Sharpeners - Milton Bradley	56.10
Typewriter Stand - Milton Bradley	32.00
Dispensers - Rochester Germicide	216.50
Typewriters - Royal Typewriter	360.00
Steel Shelving - Andrew Wilson	2,694.55
Desks & Chairs - Ivy League	3,597.40
Soap Dispensers - Interstate Restaurant	204.00
Screens - A. H. Rice	296.05
AV Equipment - A. H. Rice	1,230.60
Table & Chair Trucks - Cascade	<u>561.00</u>

Trailer Registration	12.00
Mirrors - Indian Head	24.92
Pulls - D. H. Eskin	7.20
Tractor - Still's Nursery	977.00
Masonry Drills - McKittrick Hardware	7.00
Trailer - Edmour Martel	500.00
Scaffolding - Patent Scaffolding	206.00
Floor Machine - Hild	914.62
Office Furniture - Sears	1,214.54
Janitorial Equipment - Interstate	167.60
Gym Runner - Interstate	563.40
Floor Sealer - Interstate	76.08
Parts & labor on Trailer - W. Jelley	23.84
Trailer Hitch - Valley Auto	13.82
File & Chalkboard - Philip Morris	96.90
Janitorial Equipment - M. D. Stetson	202.55
Scoreboard - General Indicator	439.00
Cafeteria Tables - Cascade	1,013.75
Tables & Bookcase - Cascade	304.65
Wastebaskets - Cascade	34.92
Folding Partitions - Pitcher Co.	2,827.00
Kitchen Equipment - Interstate	2,583.45
Duplicators - A.B. Dick	592.20
Wiring Scoreboard - G. A. Sullivan	80.00
Shower Curtains - V. M. Heipler	119.00
Study-Top Combinations - Ivy League	612.50
Freight on Scoreboard - Graf Bros.	7.28
Library Chairs - Paris Mfg.	279.00
Bleachers - Hussey	1,910.00
Desks - Jarnak	1,915.00
Blower Units - Hild	115.90
Fire Extinguishers - Fire & Safety Equip.	76.05
Safe - N. H. Distributing Agency	10.00
Tools - Sears	256.60
Copying Machine - Taft Business Machines	224.55
Freight on Fire Extinguishers - Law	3.00
Health Equipment - Coll's	510.50
Basketball Backstop - Hussey	1,100.00
Piano - Hall Music Center	650.00
Language Lab - A. H. Rice	8,914.13
Delivery of Safe - G. Masson	10.00
Magazine Rack - Jackson Chairs	142.85
Science Lab - Jarnak	5,671.75
Athletic Equipment - Cardigan Sport	954.30
Drapes & Curtains - V. M. Heipler	2,177.75
Water Color Cups - Milton Bradley	15.56
Welding Steel for Ramp - Steve's	2.00
Flag Pole - Pelham Police Assoc.	140.50
Oak Boards - Pratt & Forest	18.95
Folding Chairs - Cascade	1,099.00
Tape Recorder - A. H. Rice	69.50
Chairs - Paris Mfg.	319.00
Picture Molding - Webber Lumber	27.85
Shades - Curtain Shoppe	1,503.00
Lumber for Ramp - Sherburne Bros.	15.60

Eye Tester - Bausch & Lomb	306.05
Sand Urns - Interstate	64.14
Library Furniture - Southern Desk	4,150.10
Dictionary Stand - Bro-Dart	18.00
Lettering - Steel Craft	<u>255.00</u>
	59,793.36
Total Expenditures	\$136,271.17
Balance on Hand June 30, 1967	\$ 9,968.95

## DISTRIBUTION OF SUPERINTENDENT'S SALARY

1968-69

Bedford	21.1%	\$ 2,848.50
Hudson	34.6	4,671.00
Litchfield	4.0	540.00
Merrimack	25.4	3,429.00
Pelham	14.9	2,011.50
State of N. H.		<u>3,500.00</u>
		\$17,000.00

## DISTRIBUTION OF ASSISTANT SUPERINTENDENT'S SALARY

Bedford	21.1%	\$ 1,793.50
Hudson	34.6	2,941.00
Litchfield	4.0	340.00
Merrimack	25.4	2,159.00
Pelham	14.9	1,266.50
State of N. H.		<u>2,700.00</u>
		\$11,200.00

## DISTRIBUTION OF BUSINESS ADMINISTRATOR'S SALARY

Bedford	21.1%	\$ 1,477.00
Hudson	34.6	2,422.00
Litchfield	4.0	280.00
Merrimack	25.4	1,778.00
Pelham	14.9	1,043.00
State of N. H.		<u>2,700.00</u>
		\$ 9,700.00



# DETAILED STATEMENT OF PAYMENTS

1966-67

## Salaries of District Officers:

Michael McLlarky - School Board	\$ 400.00	
John Woodbury - School Board	300.00	
Donald Brock - School Board	300.00	
Dorothy Hardy - Treasurer & Clerk	200.00	
Alton Hodgman - Moderator	<u>15.00</u>	
		\$ 1,215.00

## Contracted Services for Administration:

State Tax Commission - Audit	\$ 98.80	
Jane Place - Census	300.00	
Dorothy Constantine	12.00	
Claire Hanlon	12.00	
Jeannette Suprenant	12.00	
Frederick R. Mansfield	12.50	
Lorin M. Raymond	12.50	
Country Print Shop	<u>24.75</u>	
		484.55

## Other Expenses for Administration:

Philip Morris & Co.	\$ 13.30	
Phaneuf Press	7.90	
Marion J. Atwood, Postmaster	58.40	
Lowell Sun	4.20	
G. C. Prince Corp.	16.65	
Pelham Building Fund	8.00	
N. H. School Boards Association	200.00	
National School Boards Association	15.00	
Donald Brock	37.00	
C. Michael McLlarky	40.50	
Donat W. Roy	200.00	
Thomas F. O'Brien	32.50	
Neal Balcom	35.00	
Robert W. Thorndike	245.00	
Ralph A. Harmon	280.00	
Edward P. McDuffee	1,500.00	
Winer, Lynch & Gormley	<u>1,311.90</u>	
		4,005.35

## Salaries for Instruction:

Dorothy Avery	\$ 5,850.00
John Begg	5,000.00
Katherine Blaze	5,000.00
Therese Breton	4,500.14
Moses Brown	9,000.00
Ethel Chalifoux	7,050.00
Anne Coburn	6,050.00
John Duclos	3,116.10
Ruth Ellis	5,000.00
Geraldine Fields	3,900.00
Constance Gagne	7,250.00
Penelope Gikas	5,000.00
Monique Gilbert	5,450.00
Benjamin Hollowell	6,150.00

Roberta Karbownicz	4,833.38	
Lucille Keezer	6,050.00	
Gloria Kopan	2,351.32	
Mary Leahy	6,625.00	
Dorothy McNulty	7,150.00	
David Meltzer	1,200.00	
Mary Mooney	7,050.00	
Florence Ouelette	4,888.92	
Ruth Richardson	6,881.68	
Rosemary Saracusa	5,450.00	
Ruth Smith	1,872.36	
Donna Staniewicz	5,000.00	
Nancy Steele	3,225.32	
Anne VanNostrand	5,150.00	
Hugh Verry	5,125.00	
Substitutes	2,970.00	
Rinehart Handwriting System	<u>750.00</u>	
		154,889.22
Salary of Clerical Assistant:		
Sandra Corbin		2,400.00
Textbooks:		
McGraw-Hill Book Co.	\$ 75.85	
The Macmillan Co.	277.12	
Houghton Mifflin Co.	22.77	
Harper & Row Publishers, Inc.	134.91	
Science Research Assoc.	272.16	
American Book Co.	548.88	
Follett Publishing Co.	798.49	
Atlantic Business Forms Co.	8.75	
National Education Assoc.	2.00	
Harcourt, Brace & World, Inc.	134.24	
Scott, Foresman Co.	14.04	
Holt, Rinehart & Winston, Inc.	223.99	
W. B. Saunders Co.	10.67	
Silver Burdett Co.	17.64	
Allyn & Bacon, Inc.	10.72	
Hudson School District	4.00	
National High School Athletic Assoc.	1.10	
Industrial Research Unit	3.25	
Scholastic Book Services	.42	
Behavioral Research Lab	<u>27.00</u>	
		2,588.00
Library & Audio Visual:		
University of New Hampshire	\$ 10.00	
McGraw-Hill Book Co.	60.20	
Society for Visual Education	122.91	
Grolier Educational Corporation	118.30	
Scholastic Book Services	81.70	
Vec, Inc.	24.20	
Compton's Library Service	5.95	
Hearne Bros.	<u>112.50</u>	
		535.76
Teaching Supplies:		
Science Research Assoc.	\$ 523.34	

	American Book Co.	762.16	
	Milton Bradley Co.	448.34	
	Harcourt, Brace & World, Inc.	218.83	
	Scott, Foresman Co.	65.55	
	Taft Business Machines, Inc.	104.56	
	Standard Duplicator Sales, Inc.	46.32	
	Cambosco Scientific Co.	34.74	
	Cascade School Supply Co.	120.42	
	Northern Supply Co.	880.92	
	Bob Marks Sports, Inc.	27.79	
		<hr/>	
			3,232.97
Testing:			
	Harcourt, Brace & World, Inc.	\$ 192.03	
	J. B. Lippincott Co.	.86	
		<hr/>	
			192.89
Art:			
	Milton Bradley Co.	\$ 66.84	
	Cascade School Supplies	69.91	
	Northern Supply Co.	13.25	
		<hr/>	
			150.00
Physical Education & Athletics:			
	Donald Sheehan	\$ 32.00	
	Richard Tessier	32.00	
	Leonard Bus, Inc.	95.00	
	Pelham Cleaners	9.00	
	Dennis Office Supply Corp.	30.60	
		<hr/>	
			198.60
Science:			
	Cambosco Scientific Co.		227.00
Other Expenses for Instruction:			
	A. E. Martel Co.	\$ 72.15	
	A. H. Rice Co.	21.88	
	National School Methods, Inc.	58.27	
	Moses Brown	123.00	
	Maxfield Press	98.95	
	Owl Stamp & Supply Co.	14.00	
	Philip Morris & Co.	6.90	
	The Phaneuf Press	1.05	
	Lakeview Press	34.00	
		<hr/>	
			430.20
Truant Officer:			
	Arthur Peabody		50.00
Salary of Nurse:			
	Agnes Hauser, RN		4,200.00
Other Expenses for Health Services:			
	Plunkett's Drug Stores	\$ 37.50	
	James A. Sullivan, MD	241.25	
	Albert J. Murphy, MD	457.50	
	Luther A. March, MD	30.00	
	Edson C. Eastman Co.	18.10	
	American School Health Association	5.00	
	National Dairy Council	3.39	

Coll's Medical Supplies Co.	28.48	
UNH Audio Visual Center	5.00	
Johnson's Electric Supply Co.	12.95	
N. H. Dental Supply Co.	12.60	
Agnes Hauser, RN	47.98	
		899.75
Transportation:		
Leonard Bus, Inc.		52,843.02
Salaries of Janitors:		
Raymond Barrette	\$ 2,176.40	
William Jelley	3,660.00	
George Masson	2,400.00	
Lorin Raymond	5,196.22	
		13,432.62
Janitors' Supplies:		
Pelham Hardware	\$ 170.88	
J. L. Holcomb Mfg. Co.	263.13	
Luxor Lighting Products Corp.	67.64	
Pelham Center Garage	15.00	
Cote's Wallpaper & Paint Co.	3.30	
Dracut Hardware	24.87	
North Shore Welding Service	3.25	
Frank P. McCartin Co.	14.76	
Lowell Plate & Mirror Co.	10.80	
George Masson	3.62	
Rochester Germicide Co.	52.17	
Winkem Company	220.50	
Modern Floor Service, Inc.	418.00	
Manchester Paper Supply Co.	499.90	
George T. Johnson Co.	123.98	
Community Pharmacy	4.36	
Waxine Co.	100.65	
Interstate Restaurant Equipment Co.	398.09	
Lorin Raymond	1.76	
Goltra, Inc.	107.12	
Albert D. Bourke	90.90	
Westron Corp.	89.53	
AG Hardware Supply Co.	56.92	
McKittrick Hardware Co.	19.47	
Webber Lumber & Supply Co.	10.48	
Sherburne Bros.	6.40	
New England Labs	15.00	
Stanley E. Smith Co.	242.80	
Bain Pest Control Service	6.00	
Ray's Auto Parts	30.94	
Scott Hardware Co.	4.83	
State Chemical Co.	20.04	
Ray's Superette	3.48	
Nashua Supply Co.	12.54	
		3,113.11
Contracted Services for Operation of Plant:		
Pelham Rubbish Removal		91.50



Heat:			
	Haffner's Service Stations	\$ 2,796.50	
	C. H. Sprague & Son Co.	<u>3,761.37</u>	6,557.87
Electricity:	Granite State Electric Co.		4,927.19
Gas:	Bot-L-Gas, Inc.		615.50
Telephone:	New England Telephone		704.41
Replacement of Equipment:	Interstate Restaurant Equipment Co.		34.00
Repairs to Equipment:			
	Jones Typewriter Co.	\$ 21.00	
	George Masson	3.00	
	Charles Television	19.00	
	Heald Building Supplies	31.00	
	Maico Hearing Service	5.00	
	Still's Nursery & Tractor	8.50	
	Ray's Auto Parts	10.13	
	Reliable Refrigeration Co.	26.00	
	Route 38 Auto & Welding Service	5.00	
	Armand Roussel	25.42	
	Pelham Center Garage	<u>3.00</u>	157.05
Contracted Services for Maintenance:			
	George Masson	\$ 567.55	
	Raymond Barrette	329.40	
	Moses Brown	190.00	
	Richard Suprenant	106.20	
	William Jelley	46.80	
	Hudson Hardware	611.62	
	Star Sales Distribution	28.31	
	Pelham Hardware	55.23	
	AG Hardware Co.	22.91	
	Merrimac Rug & Linoleum	118.67	
	Cote's Wallpaper & Paint Co.	18.90	
	Dewey Equipment Rentals	6.70	
	Boston Auto Supply Co.	10.55	
	Tony Capone	40.00	
	Steve's Used Cars & Parts	<u>21.00</u>	2,173.84
Repairs to Buildings:			
	Burner & Heating Supply Co.	\$ 74.60	
	Preferred Utilities	26.78	
	Pelham Hardware	16.64	
	Lowell Glass Co.	20.00	
	Lowell Plate & Mirror Co.	37.65	
	Scott Hardware Co.	3.25	
	Interstate Restaurant Equipment Co.	39.05	
	Frank P. McCartin Co.	43.08	

Middlesex Supply Co.	2.44	
Corneco Corp.	<u>19.40</u>	282.89
<b>Fixed Charges:</b>		
N. H. Teachers Retirement System	\$ 7,797.76	
F. I. C. A.	<u>4,777.04</u>	12,574.80
<b>Insurance:</b>		
The Harmon Agency		3,693.05
<b>School Lunch:</b>		
Federal Monies	\$ 3,751.64	
District Monies	6,898.00	
Other Expenses - Travel	<u>240.00</u>	10,889.64
<b>Student-Body Activities:</b>		
Leonard Bus, Inc.		309.00
<b>Sites:</b>		
Eleanor Haskins & Attorney		12,533.56
<b>Principal of Debt:</b>		
First National Bank of Boston	\$ 40,000.00	
Indian Head National Bank	23,000.00	
Second National Bank	<u>7,000.00</u>	70,000.00
<b>Interest on Debt:</b>		
First National Bank of Boston	\$ 23,460.00	
Indian Head National Bank	2,543.75	
Second National Bank	<u>2,660.00</u>	28,663.75
<b>Tuition In-State:</b>		
City of Nashua	\$ 10,941.00	
Hudson School District	<u>112,176.04</u>	123,117.04
<b>District Share of Supervisory Union Expenses</b>		8,293.41
<b>Tuition Out-of-State:</b>		
City of Lowell, Mass.	\$ 600.00	
Town of Methuen, Mass.	<u>169.29</u>	769.29
<b>Tuition to Other than Public Schools:</b>		
Nashua Unit for Retarded Children		500.00
<b>Transportation to Other than Public Schools:</b>		
Pelham Transport Service		888.00
<b>Tutoring:</b>		
Roberta Karboniczak	\$ 64.00	
Moses Brown	<u>224.00</u>	288.00
<b>TOTAL EXPENDITURES</b>		<u>\$533,151.83</u>

# REPORT OF REVENUE ADJUSTMENT

from

STATE TAX COMMISSION

Concord, New Hampshire  
September 18, 1967

TOTAL APPROPRIATIONS \$654,501.10

## Revenues and Credits

Unencumbered Balance	\$ 5,868.21
Sweepstakes	6,024.42
Foundation Aid	9,462.96
School Building Aid	21,075.84
NDEA-Title III, Science, Math & Lang.	200.00
NDEA-Title V, Guidance & Testing	3,000.00
School Lunch & Special Milk Program	4,000.00
PL 89-10 (ESEA)	5,000.00
Rent	100.00
Other Revenue from Local Sources	<u>5.00</u>

TOTAL REVENUES AND CREDITS \$ 54,736.43

AMOUNT TO BE RAISED BY 1967

PROPERTY TAXES 599,764.67

TOTAL APPROPRIATIONS \$654,501.10

STATE TAX COMMISSION

Lawton B. Chandler  
Commissioner

# REPORT OF THE SCHOOL DISTRICT TREASURER

for the

FISCAL YEAR JULY 1, 1966 TO JUNE 30, 1967

Cash on Hand July 1, 1966		\$ 15,076.48
Received from Selectmen	\$485,907.48	
Revenue from State Sources	35,005.24	
Revenue from Federal Sources	1,127.00	
Received from all Other Sources	<u>932.07</u>	
Total Receipts		<u>522,971.79</u>
Total Amount Available for Fiscal Year		\$538,048.27
Less School Board Orders Paid		<u>533,885.00</u>
Balance on Hand June 30, 1967		\$ 4,163.27

July 25, 1967

DOROTHY R. HARDY  
District Treasurer

## AUDITORS' CERTIFICATE

This is to certify that we have examined the books, vouchers, bank statements and other financial records of the treasurer of the school district of Pelham of which the above is a true summary for the fiscal year ending June 30, 1967 and find them correct in all respects.

July 28, 1967

O. MAURICE OLESON  
EDGAR O. PESQUERA  
Auditors



# REPORT OF THE SCHOOL DISTRICT TREASURER

for the

FISCAL YEAR JULY 1, 1966 TO JUNE 30, 1967

## BUILDING FUND

Cash on Hand July 1, 1966		\$142,038.28
Received from all Other Sources	\$ 4,201.84	
Total Receipts		<u>\$ 4,201.84</u>
Total Amount Available for Fiscal Year		\$146,240.12
Less School Board Orders Paid		<u>136,271.17</u>
Balance on Hand June 30, 1967		\$ 9,968.95

July 25, 1967

DOROTHY R. HARDY  
District Treasurer

## AUDITORS' CERTIFICATE

This is to certify that we have examined the books, vouchers, bank statements and other financial records of the treasurer of the school district of Pelham of which the above is a true summary for the fiscal year ending June 30, 1967 and find them correct in all respects.

July 28, 1967

O. MAURICE OLESON  
EDGAR O. PESQUERA  
Auditors

## PELHAM ENROLLMENT PROJECTION

<u>Grade</u>	<u>1966-67</u>	<u>1967-68</u>	<u>1968-69</u>
1	117	111	113
2	88	122	112
3	79	93	121
4	82	83	96
5	83	98	89
6	67	90	100
7	55	71	100
8	<u>72</u>	<u>66</u>	<u>81</u>
TOTALS	643	734	812

# DIVISION OF MUNICIPAL ACCOUNTING

STATE TAX COMMISSION

Concord, New Hampshire

## SUMMARY OF FINDINGS AND RECOMMENDATIONS

August 17, 1967

The School Board  
Pelham School District  
Pelham, New Hampshire

Gentlemen:

Submitted herewith is the report of an examination and audit of the accounts of the Pelham School District for the fiscal year ended June 30, 1967, which was made by this Division in accordance with the vote of the District. Exhibits as hereafter listed are included as part of the report.

### SCOPE OF AUDIT

Included in the examination and audit were the accounts and records of the School Board and the School District Treasurer.

### FINANCIAL STATEMENTS

#### Comparative Balance Sheets: (Exhibit A)

Comparative Balance Sheets as of June 30, 1966 and June 30, 1967, are presented in Exhibit A. As indicated therein, the Net Debt decreased by \$60,791.73 during the fiscal year ended June 30, 1967.

#### Analysis of Change in Financial Condition: (Exhibit B)

An analysis of the change in financial condition of the School District during the fiscal year is made in Exhibit B, with the factors which caused the change indicated therein.

#### Comparative Statements of Appropriations and Expenditures - Estimated and Actual Revenues: (Exhibits C & D)

Comparative statements of appropriations and expenditures, estimated and actual revenues for the fiscal year ended June 30, 1967, are presented in Exhibits C and D. As indicated by the budget summary (Exhibit D), a revenue surplus of \$4,583.89, plus a net unexpended balance of appropriations of \$1,284.32, resulted in a net budget surplus of \$5,868.21.

#### Statement of Receipts and Expenditures: (Exhibit E)

A summary statement of receipts and expenditures for the fiscal year ended June 30, 1967, made up in accordance with the uniform classification of accounts, is included in Exhibit E. Proof of the Treasurer's balance as of June 30, 1967, is indicated in Exhibit F.

#### Building Fund Account: (Exhibit G)

A statement of the Building Fund Account for the fiscal year ended June 30, 1967, is presented in Exhibit G.

#### School Lunch Program Account: (Exhibit H)

Exhibit H presents a statement of the School Lunch Program Account for the fiscal year ended June 30, 1967.

#### Statement of School Tax Account: (Exhibit I)

A statement of the School Tax Account with the Town of Pelham is presented in Exhibit I. As indicated therein, as of June 30, 1967, a balance of \$1,704.94 on account of the 1966-67 School Tax was due the School District from the Town.

Statement of Long Term Indebtedness: (Exhibit J)

A statement of the outstanding long term indebtedness of the School District as of June 30, 1967, showing annual debt service requirements, is contained in Exhibit J.

GENERAL COMMENTS

Current Surplus:

It is noted that the current surplus (excess of total assets over current liabilities) decreased by \$9,208.27, from \$15,076.48 to \$5,868.21 during the fiscal year ended June 30, 1967, as shown herewith:

	<u>June 30, 1966</u>	<u>June 30, 1967</u>
Total Assets	\$157,146.70	\$16,497.69
Current Liabilities	<u>142,070.22</u>	<u>10,629.48</u>
Current Surplus	\$ 15,076.48	\$ 5,868.21

Conclusion:

The provisions of Chapter 184, of the Laws of 1955, require that the summary of findings and recommendations (letter of transmittal) of this report shall be published in the next annual report of the School District.

We extend our thanks to the officials of the Pelham School District for their assistance during the course of the audit.

Yours very truly,

Harold G. Fowler

Director

DIVISION OF MUNICIPAL ACCOUNTING  
STATE TAX COMMISSION

O. Maurice Oleson )  
Edgar O. Pesquera )     Auditors

Stephen D. Plodzick, Accountant

August 17, 1967

CERTIFICATE OF AUDIT

This is to certify that we have examined and audited the accounts and records of the Pelham School District for the fiscal year ended June 30, 1967. In our opinion, the Exhibits presented herewith reflect the true financial condition of the School District on June 30, 1967, and the results of operations for the fiscal year ended on that date.

Respectfully submitted,

Harold G. Fowler

Director

DIVISION OF MUNICIPAL ACCOUNTING  
STATE TAX COMMISSION

O. Maurice Oleson )  
Edgar O. Pesquera )     Auditors

Stephen D. Plodzick, Accountant



# EXHIBIT A

## Comparative Balance Sheets As of June 30, 1966 and June 30, 1967

<u>Assets</u>	<u>June 30, 1966</u>	<u>June 30, 1967</u>
Cash in Bank:		
General Fund	\$ 15,076.48	\$4,163.27
Building Fund Account (Contra)	<u>142,038.28</u>	<u>9,968.95</u>
	\$ 157,114.76	\$ 14,132.22
Due from Town of Pelham - Balance of 1966-67 School Tax		1,704.94
Special Funds: (Contra)		
School Lunch Program	<u>31.94</u>	<u>660.53</u>
Total Assets	\$ 157,146.70	\$ 16,497.69
Net Debt	<u>842,923.52</u>	<u>782,131.79</u>
Total Assets & Net Debt	\$1,000,070.22	\$798,629.48
<u>Liabilities</u>		
Building Fund (Contra)	\$ 142,038.28	\$ 9,968.95
Reserved for Special Funds (Contra)	31.94	660.53
Bonds & Long Term Notes Outstanding	<u>858,000.00</u>	<u>788,000.00</u>
Total Liabilities	\$1,000,070.22	\$798,629.48

# EXHIBIT B

## Analysis of Change in Financial Condition Fiscal Year Ended June 30, 1967

Net Debt - June 30, 1966	\$842,923.52	
Net Debt - June 30, 1967	<u>782,131.79</u>	
Decrease in Net Debt		\$60,791.73
<u>Analysis of Change</u>		
Decreases in Net Debt:		
Bonds & Notes Paid During Year	\$70,000.00	
Net Budget Surplus	<u>5,868.21</u>	
	\$ 75,868.21	
Increase in Net Debt:		
Surplus Used to Reduce School Tax	<u>15,076.48</u>	
Net Decrease		\$60,791.73

EXHIBIT C

Comparative Statement of Appropriations and Expenditures  
Fiscal Year Ended June 30, 1967

	Appropriations 1966-67	Receipts and Reimb.	Total Amount Available	Expenditures 1966-67	Balances	
					Unexpended	Overdrafts
Administration:						
Salaries	\$ 1,215.00	\$	\$ 1,215.00	\$ 1,215.00	\$	\$
Contracted Services	601.00		601.00	484.55	116.45	
Other Expenses	380.00		380.00	4,005.35		3,625.35
Instruction:						
Salaries	164,940.00		164,940.00	157,289.22	7,650.78	
Textbooks	3,430.00	4.32	3,434.32	2,592.32	842.00	
Library & Audiovisual Mat.	1,000.00		1,000.00	535.76	464.24	
Teaching Supplies	4,184.00		4,184.00	4,001.46	182.54	
Other Expenses	730.00		730.00	430.20	299.80	
Attendance Services	50.00		50.00	50.00		
Health Services	5,270.00	306.05	5,576.05	5,405.80	170.25	
Pupil Transportation	47,250.00		47,250.00	52,843.02		5,593.02
Operation of Plant:						
Salaries	13,225.00		13,225.00	13,432.62		207.62
Supplies	4,300.00		4,300.00	3,113.11	1,186.89	
Contracted Services	120.00		120.00	91.50	28.50	
Heat	6,200.00		6,200.00	6,557.87		357.87
Utilities	6,285.00	7.30	6,292.30	6,254.40	37.90	
Maintenance of Plant	3,490.00	415.50	3,905.50	3,063.28	842.22	
Fixed Charges:						
Employee Retirement & F. I. C. A.	14,578.22		14,578.22	12,574.80	2,003.42	
Insurance	3,955.38		3,955.38	3,693.05	262.33	
School Lunch & Special Milk Program	9,438.00	1,251.64	10,689.64	10,889.64		200.00
Student Body Activities	475.00		475.00	309.00	166.00	
Capital Outlay:						
Sites				12,533.56		12,533.56
Debt Service:						
Principal of Debt	70,000.00		70,000.00	70,000.00		
Interest on Debt	28,332.50		28,332.50	28,663.75		331.25
Outgoing Transfer Accounts						
In-State:						
Tuition	131,292.00		131,292.00	123,117.04	8,174.96	
Supervisory Union Expenses	8,293.41		8,293.41	8,293.41		
Outgoing Transfer Accounts						
Out-of-State:						
Tuition	1,050.00		1,050.00	769.29	280.71	
Expenditures to Other than Public Schools	3,100.00		3,100.00	1,676.00	1,424.00	
	\$533,184.51	\$1,984.81	\$535,169.32	\$533,885.00	\$24,132.99	\$22,848.67

## EXHIBIT D

Comparative Statement of Estimated and Actual Revenues  
and Budget Summary  
Fiscal Year Ended June 30, 1967

	Revenues			
	<u>Estimated</u>	<u>Actual</u>	<u>Excess</u>	<u>Deficit</u>
Surplus Used to Reduce School Tax	\$15,076.48	\$15,076.48	\$	\$
Federal Aid:				
Public Law 874	2,500.00	1,127.00		1,373.00
School Lunch & Special Milk Program	2,500.00	2,500.00		
State Aid:				
Sweepstakes	9,400.22	10,177.76	777.54	
Building Aid	15,995.39	21,075.84	5,080.45	
Other Revenues:				
Rent	100.00	195.90	95.90	
Filing Fees		<u>3.00</u>	<u>3.00</u>	
	\$45,572.09	\$50,155.98	\$5,956.89	\$1,373.00
<u>Budget Summary</u>				
Actual Revenues		\$50,155.98		
Estimated Revenues		<u>45,572.09</u>		
Net Revenue Surplus			\$4,583.89	
Unexpended Balances of Appropriations		\$24,132.99		
Overdrafts of Appropriations		<u>22,848.67</u>		
Net Unexpended Balance of Appropriations			<u>1,284.32</u>	
Net Budget Surplus				\$5,868.21

## EXHIBIT E

Classified Statement of Receipts and Expenditures  
Fiscal Year Ended June 30, 1967

Receipts

Local Taxation:			
Current Appropriation		\$485,907.46	
Federal Aid:			
Public Law 874	\$ 1,127.00		
School Lunch & Special Milk Program	<u>3,751.64</u>		
		4,878.64	
State Aid:			
Sweepstakes	\$ 10,177.76		
Building Aid	<u>21,075.84</u>		
		31,253.60	
Other Revenues:			
Rent	\$ 195.90		
Filing Fees	3.00		
Appropriation Credits:			
Instruction - Textbooks	4.32		
Health Services	306.05		
Operation of Plant - Utilities	7.30		
Maintenance of Plant	<u>415.50</u>		
		<u>932.07</u>	
Total Receipts from all Sources			\$522,971.79
Balance - July 1, 1966			<u>15,076.48</u>
Grand Total			\$538,048.27

Expenditures

Administration:			
Salaries	\$ 1,215.00		
Contracted Services	484.55		
Other Expenses	<u>4,005.35</u>		
		\$ 5,704.90	
Instruction:			
Salaries	\$157,289.22		
Textbooks	2,592.32		
Library & Audiovisual Materials	535.76		
Teaching Supplies	4,001.46		
Other Expenses	<u>430.20</u>		
		164,848.96	
Attendance Services		50.00	
Health Services		5,405.80	
Pupil Transportation		52,843.02	
Operation of Plant:			
Salaries	\$ 13,432.62		
Supplies	3,113.11		
Contracted Services	91.50		
Heat	6,557.87		
Utilities	<u>6,254.40</u>		
		29,449.50	



Maintenance of Plant		3,063.28	
Fixed Charges:			
Employee Retirement & F. I. C. A.	\$ 12,574.80		
Insurance	<u>3,693.05</u>		
		16,267.85	
School Lunch & Special Milk Program		10,889.64	
Student Body Activities		309.00	
Capital Outlay:			
Sites		12,533.56	
Debt Service:			
Principal of Debt	\$ 70,000.00		
Interest on Debt	<u>28,663.75</u>		
		98,663.75	
Outgoing Transfer Accounts In-State:			
Tuition	\$123,117.04		
Supervisory Union Expenses	<u>8,293.41</u>		
		131,410.45	
Outgoing Transfer Accounts Out-of-State:			
Tuition		769.29	
Expenditures to Other than Public Schools		<u>1,676.00</u>	
			\$533,885.00
Total Expenditures for all Purposes			<u>4,163.27</u>
Balance - June 30, 1967			
Grand Total			\$538,048.27

#### EXHIBIT F

#### Summary of Treasurer's Account and Proof of Balance Fiscal Year Ended June 30, 1967

Balance - July 1, 1966	\$ 15,076.48		
Receipts During Year	<u>522,971.79</u>		
		\$538,048.27	
Expenditures During Year		<u>533,885.00</u>	
			\$ 4,163.27
Balance - June 30, 1967			

#### Proof of Balance

Balance in the Indian Head National Bank -			
Per Statement June 29, 1967	\$ 18,867.66		
Less: Outstanding Checks	<u>14,704.39</u>		
Reconciled Balance - June 30, 1967			\$ 4,163.27

# EXHIBIT G

## Statement of Building Fund Account and Proof of Balance Fiscal Year Ended June 30, 1967

Balance - July 1, 1966		\$142,038.28	
Receipts During Year:			
N. D. E. A. - Title III	\$ 2,081.61		
Interest on Certificates of Deposits	1,817.14		
Sale of Materials	148.92		
Gifts, etc.	<u>154.17</u>		
		<u>4,201.84</u>	
		\$146,240.12	
Expenditures During Year:			
General Contractor	\$53,691.67		
Purchase of Site	6,986.34		
Site Development	15,527.01		
Furniture & Equipment	57,492.51		
Architect's Fees & Expenses	326.16		
Legal Fees	242.25		
Other	<u>2,005.23</u>		
		<u>136,271.17</u>	
Balance - June 30, 1967			\$9,968.95
<u>Proof of Balance</u>			
Balance in the Indian Head National Bank -			
Per Statement June 29, 1967		\$ 10,518.95	
Less: Outstanding Check		<u>550.00</u>	
Reconciled Balance - June 30, 1967			\$9,968.95

# EXHIBIT H

## Statement of School Lunch Program Account and Proof of Balance Fiscal Year Ended June 30, 1967

Balance - July 1, 1966		\$ 31.94	
Receipts During Year:			
Lunch Sales:			
Children	\$17,156.38		
Adults	1,010.99		
Food Reimbursements (Federal)	3,751.64		
District Appropriation	6,938.00		
Milk Reimbursements	1,024.31		
Donations	100.00		
Refunds	<u>78.70</u>		
		<u>30,060.02</u>	
		\$30,091.96	
Expenditures During Year:			
Food & Milk	\$14,767.71		
Labor - Adults	13,601.84		
Laundry Service	131.76		
Services & Supplies	445.08		
Social Security	402.89		
Travel Expense	42.12		
Other Expenses	<u>40.03</u>		
		<u>29,431.43</u>	
Balance - June 30, 1967			\$660.53
	<u>Proof of Balance</u>		
Balance in the Indian Head National Bank -			
Per Statement June 30, 1967	\$ 2,765.32		
Less: Outstanding Checks	<u>2,104.79</u>		
Reconciled Balance - June 30, 1967			\$660.53

# EXHIBIT I

## Statement of School Tax Account Fiscal Year Ended June 30, 1967

1966-67 School Tax	\$487,612.42
--------------------	--------------

### Received from Town of Pelham During Year:

September 12, 1966	\$ 5,000.00
September 28, 1966	35,000.00
October 27, 1966	85,000.00
November 25, 1966	30,000.00
December 29, 1966	4,000.00
January 26, 1967	80,000.00
March 6, 1967	23,000.00
March 29, 1967	30,000.00
April 20, 1967	110,000.00
May 18, 1967	40,000.00
June 28, 1967	<u>43,907.48</u>

\$485,907.48

Amount Due School District - June 30, 1967

1,704.94

\$487,612.42



Statement of Long Term Indebtedness, Showing Annual Maturities of Principal and Interest  
As of June 30, 1967

107

## SCHOOL BOARD REPORT

To the Townspeople of Pelham:

Pelham, which is a part of Supervisory Union #27 consisting of five School Districts, has as its Superintendent of Schools, Claude H. Leavitt, who excels in the dedication and proficiency of his position. Assistant Superintendent Peter G. Dolloff has demonstrated his knowledge and capabilities. Business Administrator James Jordan replaced Mr. James Tierney, who resigned to accept the position of Principal at Memorial Junior High School in Hudson. Mr. Jordan has demonstrated his abilities in the area of purchasing.

Principal Moses Brown exerts his administrative capabilities in a commendable manner. He initiated a summer school program that proved successful for all those attending. The projected enrollment deems it necessary to ask you to provide an Assistant Principal at the E. G. Sherburne School.

Our instructional staff has excelled in the performance of their duties through our progressive program. To maintain this excellence, we ask your consideration of the proposed salary schedule.

Our Physical Education program molds the physical development of our young people through regular classes, intermural programs, and inter-school competition through its hard working and dedicated director, Mr. John Duclos.

The Guidance Counseling program initiated this past year, utilizing Title I Funds, has proven to be a tremendous asset to our school district. The Guidance Counselor, Mr. Roland Maheu, has done an outstanding job counseling students with the cooperation of their parents.

The fine work of maintaining records, issuing parental bulletins, and all other related school office tasks belongs to Mrs. Sandra Corbin, Office Secretary.

Our School Lunch Program through the enthusiastic direction of Mrs. Velma Houle and her capable staff continue to provide through central cooking a hot lunch program for our young people.

Our Health Program through our School Nurse continues to be a vital part of our schools. Mrs. June Groele was hired when the board accepted, with regret, Mrs. Terry Hauser's resignation in December.

Mr. George Masson, Supervisor of Custodians and Maintenance, and his staff of Custodians, Mr. Lorin Raymond, Mr. Raymond Barrette, Mr. William Jelley, and Mr. Thomas Desmarais continue to maintain our schools in an efficient manner.

The board proposes that music and art programs be initiated this year and ask your consideration. These programs were on a limited basis three years ago.

Based on enrollment projections, the board proposes an addition to the Pelham Memorial School, which will include twelve classrooms plus special areas necessary to the continuity of our instructional program. The permanent steering committee under the chairmanship of Mr. James Powers has supported this proposal. We ask your consideration of Article 6 in the School District Warrant.

The board proposes a planning and study committee to explore our high school needs, which will report to the school district its findings, hopefully, prior to the annual school district meeting in March, 1969, so that the town may take action relative thereto.

Recommendations of the Transportation Committee under Chairman Albert Maki relative to reducing the high school routes were implemented by the board in September, 1967. If these routes are maintained there will be no increase in the cost of regular transportation this year.

The appreciation of the School District is extended to the organizations and individuals, who have contributed their time and funds to the welfare and well being of our young people, by your school board. To you, both anonymous and acknowledged. Thank You!

The board brings to you a budget which reflects the best thinking and reasoning of not only itself, but of the Superintendent and the entire Staff. To maintain our program of progress and quality in the education of our young people we ask your continued cooperation and participation.

Respectfully submitted,

JOHN W. WOODBURY  
Chairman



## REPORT OF THE SUPERINTENDENT OF SCHOOLS

To the School Board and Citizens of Pelham:

The Memorial and Sherburne Schools continue to meet the space requirements of our pupils in grades one through eight. However, our growing pupil enrollment is pressing us to increase our available classroom space by September, 1969. This can best be seen by the growth of the past three years. In September of 1966 we enrolled 611 pupils and 713 last September. We project 812 for September, 1968. This is a steady and constant growth of over 100 pupils per year which is nearly equal to four classrooms.

As we think in terms of growth and additional building needs, we should let our instructional program needs guide our building plans. We should not only strengthen existing programs, but implement additional programs, which will allow us to better meet the needs of our pupils and offer a more comprehensive elementary program. Serious budgetary attention is required if we are to add pupil services in art, music, remedial and developmental reading, special education and library science.

The present educational opportunities at Alvirne High School for our secondary school pupils are excellent. However, Pelham has one more year, with an option for two more, on its tuition contract with Hudson. The voters of Pelham will be well advised to take a good hard look at the future of its secondary school pupils before this contract expires.

The educational future of Pelham offers several alternatives. Pelham may choose to proceed into the 1970's independent of other school districts, or in conjunction with one or more neighboring communities. It seems that the best solution for Pelham will appear only when all the alternatives have been pursued and discussed. This may require a planning and study committee appointed for this specific purpose.

The program of studies offered our children is taught by a well-trained and dedicated teaching staff. Pelham should make every effort to continue to attract and hold competent teachers. It is a pleasure to acknowledge the following additions to our instructional staff:

Miss Judith Abraham, Lowell, Mass., State College, Lowell, B.S. Ed., 1967, Grade 1 teacher, Sherburne School.

Mrs. Pamela Baker, Quincy, Mass., Merrimack College, B.A., 1967, Language Arts, Memorial School.

Mr. Clarence Bergeron, Jr., Keene, N. H., University of Miami, Keene State College, B.B.A., 1966, Science, Memorial School.

Mrs. Priscilla Crompton, Salem, N. H., B. Ed., Keene State College, 1965. Previous teaching experience Keene, N. H., Grade 2, Sherburne.

Miss Jean Gurecki, Arlington, Mass., Lowell State College, B.S. Ed., 1967, Grade 2, Sherburne School.

Mrs. Julia Jordan, Hudson, N. H., Keene State College, additional credits - University of Vermont, Plymouth State College, Boston University, and University of New Hampshire, grade 2, Sherburne School.

Miss Anna Lavoie, Nashua, N. H., Rivier College, B. A., 1967, grade 1, Sherburne School.

Mr. Roland Maheu, Dover, N. H., B. A., University of N. H., 1963, additional graduate credits University of N. H., 1966-67, Guidance Counselor. Previous teaching experience Franklin, N. H., Belmont, N. H. and Epping Elementary School.

Mr. Robert Miller, Derry, N. H., B. Ed., Keene State College, 1967, General Science, Memorial School.

Miss Shirley Pavelka, Dracut, Mass., State College, Lowell, B. S., 1967, Grade 4, Memorial School.

Mrs. Carol Riley, Lawrence, Mass., Notre Dame College, B. A., 1961, grade 2, Sherburne School.

Mr. Dale Riley, Milford, N. H., Keene State College, B. Ed., 1967, Social Studies and Science, Memorial School.

Mr. Alfred Souza, Nantucket, Mass., B. Ed., Plymouth State College, 1966, Masters Degree - University of Connecticut, 1967, Social Studies, Memorial School.

Miss Mary Velluto, Melrose, Mass., B.S. Ed., Lowell State College, 1967, grade 4, Memorial School.

Mrs. Barbara Winch, Hudson, N. H., University of New Hampshire, 1960, B. S., additional credits Gorham State, 1964, grade 3, Sherburne School.

In conclusion I acknowledge and appreciate the efforts and cooperation of the school board, the instructional staff and others who have made significant contributions to the progress of education in Pelham.

Respectfully submitted,

CLAUDE H. LEAVITT  
Superintendent of Schools



## REPORT OF THE ASSISTANT SUPERINTENDENT

January 15, 1968

Mr. Claude H. Leavitt  
Superintendent of Schools  
Pelham, New Hampshire

Dear Mr. Leavitt:

The following paragraphs constitute my report as Assistant Superintendent in the School District of Pelham, New Hampshire.

The current school year has seen the second year of our Middle School Program. During this second year, we have had the opportunity to refine and expand this concept of school organization. We feel we have been able during these two years to fulfill our three major goals. The comprehensive facilities in the Memorial School are available to all youngsters in grades 5-8. Teachers have the opportunity to teach in areas of specialization at a time when the curriculum is becoming too sophisticated to expect the self-contained classroom teacher to do an adequate job in all areas. Finally, we see evidence that we are better able to cater to the basic physiological and psychological changes that are peculiar to the eleven to fourteen year age bracket.

The scope of our pupil services have been significantly increased with the addition of guidance personnel. As indicated in last year's report, the guidance counsellor is able to assist each child in developing his capacity to function as close to his level of potential as possible, both with regard to intellectual potential for academic production and potential for personal-social competency. We anticipate receiving approximately \$2,500.00 toward support of the guidance program through Title I of the Elementary and Secondary Education Act of 1965.

Title II of ESEA 89:10 provides for the purchase of library resources, textbooks and other printed and published materials. During the current year, Pelham will receive approximately \$1,375.00 in library materials. During the last fiscal year, Pelham received \$962.00 in library material through Title II. In addition to this, Pelham received \$1,900.00 awarded on a competitive basis with other communities in the state of New Hampshire. Upon review of the community's efforts in establishing an excellent library facility at the Pelham Memorial School, this library was adjudged to be a model library and one deserving of this extra grant in aid.

In addition to the afore-mentioned, Pelham has been using the services of Project TRY. This project is funded through Title III of ESEA 89:10, and provides professional practitioners in the visual and performing arts to present performances designed to expose children to the aesthetic qualities in programs of this type.

During the coming year, priority consideration should be extended toward those services necessary to provide a comprehensive elementary program. Every child needs frequent opportunity and stimulation to express his thoughts and feelings through art and music experiences. Through art and music the child may exercise his imagination, develop aesthetic judgement, acquire sensitized awareness, grow in ability to listen and observe, use his creativity, gain in skill, and learn something of his art and music heritage. What is equally important, he will receive the background necessary to compete with and understand his peers based on a broad academic and aesthetic background.

Probably the most pressing problem facing the school district during the coming year is the need for additional space. In order to maintain their excellent pupil-teacher ratio, additional classroom area is an absolute necessity.

In closing, I would like to thank the School Board and yourself for your direction and guidance, Mr. Brown for his unfailing cooperation, and finally the citizens of Pelham for their commitment to excellence in the educational program.

Respectfully submitted,

PETER G. DOLLOFF  
Assistant Superintendent

## PRINCIPAL'S REPORT

January, 1968

Mr. Claude Leavitt  
Superintendent of Schools  
Pelham School District  
Pelham, New Hampshire

Dear Mr. Leavitt:

Submitted herewith is my fourth annual report as supervising principal of the Sherburne and Memorial Schools.

### PREFACE

The opening day of school in September found us with 115 additional students over the opening day of the previous year. Every available classroom is being utilized in addition to the library and the science laboratory being used as homerooms. Study periods are held in the cafeteria six periods a day. Once again we are faced with a critical need for additional classrooms. This next school year will see class size increase to a number that will be detrimental to effective instruction. Immediate construction of additional facilities is imperative.

### INSTRUCTION AND PERSONNEL

Meetings were held with Math and Foreign Language Department heads of Alvirne High School to fully coordinate these programs and to ensure continuity and sequence of instruction in these areas. We are most pleased to note that the majority of our 8th grade students make the transition from Pelham to Alvirne High School with ease. End of the year testing is also done which enables the guidance department at Alvirne to properly place the incoming ninth grade students from Pelham.

The Science Department at the Memorial School was strengthened by an additional science teacher with subsequent schedules arranged which have permitted team teaching in this area.

The area of in-depth pupil services has been effected through the combined and cooperative efforts of Mrs. Hauser, our school nurse, and Mr. Maheu, our guidance counselor. Through their combined efforts, many students have been assisted through a difficult and trying period in their young lives.

This next school year will see the completion of the adoption of the Betts Basal readers through grade six. This program has and is proving to be highly effective and beneficial to students at all reading levels.

With the return of Mr. Duclos, our Physical Education Director who spent the last six months of the 1966 school year in the service, the physical education program was resumed with most pleasing results. During the first part of this school year, he tested all students using standards set up by the President's Physical Fitness Program. At present, Mr. Duclos is working in areas of specific weaknesses as revealed by the testing program.

This year a new innovation was begun in the Pelham School District. Once a month a released time day is held in both schools. Students are dismissed at 1:30 and the remainder of the day is devoted to parent-teacher conferences, teacher in-service training programs, seminars, and workshops. To date, these have been most effective and beneficial to students, parents and teachers.

### FUTURE NEEDS

For a well-rounded, comprehensive instructional program for our students, it is hoped that this next year we will have an art and music program in the Pelham School District. Students leaving our schools suffer in comparison with those who have had the benefits of these programs.

In closing, I wish to thank you Mr. Leavitt, Mr. Dolloff, our school board and our dedicated staff for the support and cooperation so freely and generously given this past school year.

Respectfully submitted,

MOSES BROWN  
Supervising Principal  
Pelham School District



# REPORT OF THE SCHOOL NURSE

January, 1968

To Mr. Claude Leavitt, Members of the School Board and Citizens of Pelham, N. H.:

Following is a report of the work accomplished during the school year 1966-67 as well as a brief summary of the work done prior to my resignation during the current school year:

1966-67

Dr. Albert Murphy and Dr. James Sullivan gave complete physicals to 535 students. There were 37 defects found, 16 of which were corrected after follow-up.

<u>Testing Program</u>	<u>No. Tested</u>	<u>Defects</u>	<u>Known Corrections</u>
Vision	965	112	44
Hearing	965	56	17
Tuberculosis (Heaf Test)	392	* 10 *positive reactions	* 10 *X-rays negative
Pupil Inspections	992		
Heights and weights	904		
Dental Examinations	535	182	79
First Aid	1,365		
Health Classes (of at least 20 min. duration)	94		
Health Films Shown	11		
Parent and Teacher Conferences	42		
Home Visits	147		

A measles clinic was held November 15, 1966 with 108 children receiving immunizations. At the well-baby clinics held April 6, May 11, and June 1, 1967, 233 children received immunizations as follows: toxoid - 195, smallpox vaccine - 40 and polio vaccine - 40. At the pre-school dental clinic held May 4, 1967, 118 children were treated.

Dr. Luther March, Dr. James Sullivan, and Dr. Albert Murphy were the attending physicians. Those who assisted me at the clinics were Mrs. Anna Horskin, Mrs. Georgia Atwood, Mrs. Florence Porter, and Mrs. Avis Fairbanks. Acting as clerks were Mrs. Ruth Carleton, Mrs. Gertrude Tuttle, Mrs. Claire Hanlon and Mrs. Dot Constantin.

## Special Referrals

- 15 pupils referred to Crotched Mountain for educational testing and evaluation.
- 2 pupils referred to PERC Institute for testing for specific language disability.
- 11 pupils referred to Concord Child Guidance Clinic for testing and therapy.
- 2 pupils sent to Crotched Mountain hearing clinic for testing and diagnosis of hearing disorder.

Financial assistance for some of these children came to me from various sources. The P. T. A. donated \$100.00 and \$45.00 was given by one of the teachers. The Lion's Club gave assistance where needed for those with visual problems. The Pelham Grange gave me \$25.00 which was used to provide dental care for several pupils. I want to thank all of these generous donors.

## Infectious Disease Report

Chickenpox - 89  
Measles - 5  
German Measles - 39

Scarlet Fever - 9  
Rheumatic Fever - 2  
Strep. Throats - 23

Mumps - 43  
 Pediculosis - 1  
 Impetigo - 8

Infectious Mononucleosis - 2  
 Ringworm of skin - 3  
 Meningitis (pre-school) - 3

September, 1967 to December, 1967

Dr. Luther March and Dr. James Sullivan gave 336 complete physicals. Sixty-nine defects (11 serious) were found. Of these, 52 have been corrected (3 by surgery).

<u>Testing</u>	<u>No. Tested</u>	<u>Defects</u>	<u>Known Corrections</u>
Vision	665	22	9
Hearing	457	9	1
Tuberculosis	124	0	
Inspections	1,088		
Heights and weights	105		
Dental Examinations	188	74	14
First Aid	697		
Health Classes	20		
Health Films	8		
Parent or Teacher Conferences	23		
Home Visits	39		

A measles clinic was held October 10, 1967; 128 immunizations were given.

#### Special Referrals

- 1 perceptually handicapped pupil sent to Crotched Mountain for schooling.  
 Tuition was provided by a generous local organization.
- 1 referral to Crotched Mountain for educational testing and evaluation.
- 10 referrals for auditory training.

Because of the rapidly increasing pupil enrollment, the schedule of testing was changed this year to coincide with the complete physicals. These are given at first, third, fifth and seventh grade level. Students with known problems will be tested yearly as well as referrals from teachers or students themselves. New pupils will also be tested upon entering our system.

Pelham has always attempted to provide needed services for our school children. This means that in the very near future, we must provide an additional nurse to help take care of our schools. The nurse should have adequate time to provide counselling pertaining to health problems and time to act as resource person for health materials and information. She must also take care of pupil referrals and needed follow-up to see that recommended treatments are carried out as directed. There should, ideally, be time for health education by means of films and classes. The urgent areas of drug addiction, alcoholism, consumer education, sex education, and family life education can no longer be ignored. The problems are already with us and a way must be found to help our youngsters to cope with them. The immunization clinics must also be increased as the new vaccines become available - as in the case of measles and mumps vaccines.

Whatever we can provide for our students in the way of health services, counselling, remedial teaching or special education will be money well spent. Prevention is far cheaper than treatment both in terms of money and human suffering. Since New Hampshire does not have the facilities or resources to take care of all our children with various handicaps, we should do our best to provide for them on a local level.

Respectfully submitted,

THERESA HAUSER



# REPORT OF THE GUIDANCE COUNSELOR

January, 1968

Mr. Claude Leavitt  
Supt. of Schools  
Pelham School District  
Pelham, New Hampshire

Dear Mr. Leavitt:

It is my pleasure to submit to you my report as Guidance Counselor in the School District of Pelham, New Hampshire.

The counseling program was officially inaugurated in September, 1967. The purpose of counseling in Pelham is to help children to resolve those issues which seem to interfere with their learning. Counseling takes place on two levels. The E. G. Sherburne School houses the playroom in which various play materials are located. The purpose of the play material is to enable children to act out feelings that they cannot put into words. Often times a child will communicate verbally more easily if he is engaged in some physical activity. Also, a child may communicate non-verbally through play activity. On the other level, counseling takes place in the counseling rooms of the Memorial School. In that area, individual and group counseling also occurs. This area also contains some materials such as clay and drawing materials which allow older children to express themselves through the constructive use of their hands. Counseling at St. Patrick's is more difficult as there is no permanent counseling setting at the present time.

We feel that we have accomplished a great deal in the short time that the program has been in service. In an effort to coordinate our activities with outside agencies, the counselor has visited a number of referral agencies which are available to us. This activity is important so that we may offer the best service possible by utilizing the unique services of these various agencies.

In the area of educational growth, the counselor is continuing to take courses in counseling at the University of New Hampshire. This department also employs audio-visual aids such as tape recordings in an effort at continued educational growth.

The counseling department has recently produced a 15 minute, 8 mm, color, sound film on elementary school counseling which will be available to clubs and civic groups. This film may be the first of its kind to be produced anywhere.

School children were introduced to counseling in a September orientation to each class. Two essential points were covered: How easy it is to see the counselor, and what occurs in counseling with special emphasis on the concept of confidence. Following is a breakdown of counseling activity for the period September 15 to December 22, 1967:

<u>School</u>	<u>Type of Counseling</u>		<u>Request</u>	
	<u>Educational</u>	<u>Personal</u>	<u>Self</u>	<u>Referred</u>
St. Patrick's	16	20	23	9
Sherburne	37	41	8	61
Memorial	<u>30</u>	<u>128</u>	<u>99</u>	<u>49</u>
Totals	83	189	130	119

Types of counseling: Educational - Discussion of something directly concerned with school. Personal - Something other than school is discussed. Request: Self - The child requested counseling himself. Referred - The child was sent to counseling by someone else.

Aside from school counseling, the counselor also meets with parents and teachers, coordinates the school testing program, and advises the Principal on matters of counseling.

A look to the future:

1. The workload is enormous; one counselor for 1,100 students. It is hoped that the number of personnel in the Counseling Department will be increased.

2. There is a vital need for a private telephone line so that parental conferences may be carried on over the telephone in strict confidence.

3. Counseling settings:

- a. Sherburne School - The size of the room is inadequate.
- b. Memorial School - The room is adequate in size, but is located between two classrooms. This affects the privacy so necessary in counseling.
- c. St. Patrick's - A permanent setting will have to be established where materials may be maintained and where privacy so necessary to counseling may be maintained.

4. The establishment of a Pupil Personnel Service whereby all special education, counseling, and health services will be integrated and synchronized is in the planning stage. There would be a coordination of services in order to avoid duplication and waste of activity.

5. A readiness program for pre-schoolers should be established. The school counselor will be attending the Gessel Readiness course in February.

Progress has been made in the area of counseling. But we should not become complacent and accept what we have as good enough for our children. The past four months have been especially rewarding for me because of the enthusiasm I have found, for the program, in the town of Pelham.

Respectfully submitted,

ROLAND MAHEU  
Guidance Counselor

## LUNCH PROGRAM REPORT

At no time in the history of the School Lunch Program, have we faced the problems we do today. We are in an era of automation and rapid changes with advancing food costs, new type equipment, rising labor costs and a sharp cut in federal assistance. We are handling two of our citizens' valuable possessions - his children and his money - and only through cooperation and team effort can we hope to "hold the line" and maintain our high standards.

In 1967, we served 67,173 pupils and 3,602 adults with the outlook even greater for the coming year. The Federal Government continues to cut its support in reimbursement as well as food products. The five cent increase in the lunch price last year enabled us to operate our program in the black and hopefully will continue to in the future. Increased participation at both schools is one of the most helpful factors in meeting the financial needs of the program.

The Pelham Relief Association continues to assist with contributions to the program for free lunches.

The women of the community are ever ready to answer the call for volunteer help to the program. I would like to thank the following women for their assistance with the School Picnic and Thanksgiving dinner: Doris Dobson, Dorothy Constantin, Claire Hanlon, Ruth Brock, Phyllis Robinson, Anna Bolduc, Eleanor Burton, Jan Pitts, Phyllis Hague, Jean Robarge, Lou Haldeman, Barbara Vitale, Judith Lehmann, Joanne Edwards, Carolyn Law, LaVerne Steck, and Jane Burton.

Helping our children and young people to establish good food habits is probably the most important and gratifying thing that we do. My thanks to the faithful lunch program staff for their untiring efforts in this behalf. This year's staff includes: Ethel Duarte, Hellen Orlando, Agnes Lawlor, Doris Simpson, Anna Fitzpatrick and Judith Lehmann. Alvina Spaulding who has given much to the program through the years has taken a leave of absence due to illness and Judith Lehmann is taking her place at the Sherburne School.

We are very fortunate in having a list of conscientious substitutes and we call on them frequently throughout the year.

I wish to extend my thanks to the Staff, School Board and Superintendent's Office as well as the townspeople for their help in support of the Lunch Program.

Respectfully submitted,

VELMA L. HOULE  
Lunch Program Director



## REPORT OF THE PERMANENT STEERING COMMITTEE

### History and Purpose:

The Permanent Steering Committee was established by a vote of the School District at a special meeting held on December 18, 1963, based on the recommendation that "A Permanent Steering Committee be appointed to assist the school board in planning and projection for future school district needs."

The purpose and function of this committee is to work with, advise and recommend to the school board, possible solutions to the educational problems of the District concerning the students and their futures, the facilities needed to carry out these solutions, the Town's ability to support these requirements and any particular problem's place in the long-range objectives of the school district.

This report attempts to convey, detail and summarize this committee's thinking on the topics delineated below. The order in which the topics are listed is not to be interpreted as being indicative of their importance, but simply a rather arbitrary listing.

In those instances where the committee studied and discussed a topic to its satisfaction, a recommendation is made concerning future action. All other topics terminate with an opinion as to future study or suggested course of action.

### High School Facilities:

This concern is one that has evoked much discussion. "Simple" solutions range from continuing on a tuition basis to building our own high school. This committee urges that the District pursue the compromise area that lies between these two extremes and RECOMMENDS THAT THE DISTRICT SUPPORT THE ARTICLE CALLING FOR THE FORMULATION OF THE STUDY COMMITTEE - ONE ON THE AREA (AUTHORIZED REGIONAL ENROLLMENT AREA) SCHOOL AND THE OTHER ON THE COOPERATIVE SCHOOL DISTRICT. The committee feels that only after a comprehensive study of the "trade-offs" of all of these alternatives is released, can the District decide its future course of action - this decision will be both expensive and binding.

### Elementary Curriculum:

One of the most basic skills in our affluent society is the ability to read. Truly, this ability to read (as well as one is able) is the cornerstone of our formal educational structure.

A problem, NOT UNIQUE TO THE PELHAM SCHOOL DISTRICT, is the fact that many children read below their grade level. We suggest that the district accelerate its efforts in programs of remedial reading - striving to bring each and every student to his or her excellence level.

In the area of new programs, we suggest that the District initiate a structured sequence that develops the natural talents of our students in the technological skills and crafts. We are all well aware of the man-machine interface problems we face all about us - viz - the broken appliance, the difficulty we have in getting service and repairs performed, etc. Many of these devices, machines, etc. we cannot begin to understand much less attempt to repair. We say it takes a certain kind of talent and then hire an individual with that talent to carry out the repairs. However, many of our supposedly "less able" students can and many times do understand (perhaps in an intuitive sense) "how" these things work and could possibly repair them. These students are not the "best" students in an academic sense because the curriculum that has as its objective the college freshman does not interest and motivate these "practical" interests. What is suggested here is a program that interests, encourages and develops these students - many of whom are or become our "force-outs" (formerly called "drop-outs"). A program of this type could terminate at the high school level, the junior or community college (a reality in the greater Nashua area within perhaps ten years) level, or even the senior college level.

Admittedly the committee knows of no program of this type in existence at the elementary level. However, one could evolve from the Pelham School District - perhaps funded by a Federal Grant.

### Elementary Facilities:

The District's primary concern has been and continues to be adequate physical plant for elementary education. For a town with a residential tax base, we can and should be proud of the educational facilities we offer our children. However, the time has come for our District to give very serious attention to a comprehensive plan of growth so that we might reap some of the wisdom of the experiences of our neighboring towns, rather than "re-invent the wheel" ourselves.

The District is only too well aware of the rapid growth of the town and the increases in instructional salaries, transportation and buildings. We cannot continue to expand in these categories without soon



answering the obvious question, "what plan are we following - which way do we go next?" This committee suggests that a goal in terms of physical plant(s) might be approached in the following way:

It appears that the most probable course of action in the high school needs will be met by one of the alternatives discussed above, i.e. AREA, COOP, tuition or our own high school.

Next, consider the Memorial School as gradually evolving into a junior high school and perhaps retaining its middle school characteristic. Consider further the possibility of tuition junior high school students in Pelham.

Follow this with neighborhood elementary schools springing up in the densely populated areas of town, servicing grades 1 thru 4 on a walking basis. (Sidewalks will become a reality within our lifetimes.)

Admittedly much of the above might seem to be "blue-sky" thinking to some, but the point of all this discussion is that we do have an ideal or goal to strive for and this in itself gives direction and purpose to our actions. This committee urges that we clearly establish the "big-picture" so that we might commence planning the pieces.

#### Memorial School Addition:

Since its reactivation in January, 1967, the committee has studied and discussed the rising enrollment in the District. After considering the feasibility of adding to the existing buildings, the committee agreed to "Recommend that the School District take initial steps to start a twelve-room addition to the Memorial School." The committee suggested that perhaps an appeal to the Budget Committee for an emergency appropriation to start the footings for the twelve-room addition might be investigated. However, further action was deferred until the borrowing capacity of the School District could be determined.

The need is now upon us and the additional classrooms are necessary. Therefore, the committee RECOMMENDS THAT THE DISTRICT SUPPORT THE SCHOOL BOARD'S PROPOSAL FOR AN ADDITION TO THE MEMORIAL SCHOOL THAT WILL SATISFY THE DISTRICT'S IMMEDIATE NEEDS.

The committee would also like to point out that the next pressing need will be in the lower elementary facilities, grade 1 thru 4.

#### Acknowledgement:

The steering committee extends a grateful "thank you" to the Provisional League of Women Voters for honoring its request and sponsoring the open meeting held on Thursday, January 11, 1968. The committee believes that through the use of this means of communication, we can better acquaint our fellow citizens with the problems and proposals of the district.

#### Committee Meetings and Prospective Members:

The steering committee meets the last Wednesday of the month at 8:00 p.m. in the Memorial School. The meetings are open to the public and as with any appointed committee, vacancies occur periodically. Any interested citizen wishing to serve on this committee is requested to contact either the chairman or the district school board.

#### Conclusion:

Much of the foregoing is not what many expect in a report to a district meeting. This committee's purpose and meaning is, however, one of "planning and projection for FUTURE School District needs." Therefore, we report herein, concepts, ideas and methods of implementation which we feel give the District food for thought, suggested courses of action and perhaps more reality than fantasy.

Respectfully submitted,

JAMES E. POWERS, Chairman

#### Steering Committee Membership:

Chairman, James E. Powers  
Secretary, Mrs. Barbara Everhard  
Selectman, Albert D. Nolin  
Budget Committee, Miles J. Cares  
Planning Board, Leo E. Sevigny (resigned)  
School Board, Donald E. Brock

School Board, Frederick A. Houle  
School Board, John W. Woodbury  
Mrs. Margaret Balboni  
Thomas J. Cleghorn  
Anthony J. Oliver  
Whitman Pearson  
Bruno J. Thibeault  
(resigned)







Office of the Selectmen  
Pelham, N. H.

Bulk Rate  
Postage Paid  
Permit # 4  
Pelham, N. H.

POSTAL PATRON  
LOCAL